

Appendix 1

(104 Bar)
104 Brick Lane
London
E1 6RL

Licensable Activities authorised by the licence

The sale by retail of alcohol
The provision of late night refreshment
The provision of regulated entertainment

See the attached licence for the licence conditions

Signed by

David Tolley 
Head of Environmental Health & Trading Standards

Date: 5th November 2005



Part A - Format of premises licence

Premises licence number

162230

Part 1 - Premises details

Postal address of premises, or if none, ordnance survey map reference or description

104 Brick Lane

Post town

London

Post code

E1 6RL

Telephone number

0207 377 0033

Where the licence is time limited the dates

N/A

Licensable activities authorised by the licence

The sale by retail of alcohol

The provision of late night refreshment

The provision of regulated entertainment

The times the licence authorises the carrying out of licensable activities

The sale by retail of alcohol:

Sunday, Monday, Tuesday, Wednesday, Thursday, Friday and Saturday from 11:00 hours until midnight

On New Year's Eve from the end of permitted hours to the start of permitted hours on the following day (or, if there are no permitted hours on the following day, midnight on 31st December).

Note: However, New Years Eve is subject to the Regulatory Reform (Special Occasion Licensing) Order 2002. Which means that while that order is in effect the premises may remain open for the twelve hours between 11pm on New Years Eve and 11am on New Years Day.

For provision of Late Night Refreshment:

Sunday, Monday, Tuesday, Wednesday, Thursday, Friday and Saturday from 11:00 hours until midnight

The opening hours of the premises

Sunday, Monday, Tuesday, Wednesday, Thursday, Friday and Saturday from 11:00 hours until 00.30 hours

Where the licence authorises supplies of alcohol whether these are on and/ or off supplies

On sales only

Part 2

Name, (registered) address, telephone number and email (where relevant) of holder of premises licence

104 Bar Limited
104 Brick Lane
London E1 6RL



Registered number of holder, for example company number, charity number (where applicable)

14023454

Name, address and telephone number of designated premises supervisor where the premises licence authorises the supply of alcohol

Carlos Tituana



Personal licence number and issuing authority of personal licence held by designated premises supervisor where the premises licence authorises for the supply of alcohol

Personal licence number: 

Issuing Authority: 

Annex 1 - Mandatory conditions

No supply of alcohol may be made under the premises licence-

- a) at a time where there is no designated premises supervisor in respect of the premises licence, or
- b) at a time when the designated premises supervisor does not hold a personal licence or his personal licence is suspended

Every supply of alcohol under the premises licence must be made or authorised by a person who holds a personal licence

1.

- (1) The responsible person must ensure that staff on relevant premises do not carry out, arrange or participate in any irresponsible promotions in relation to the premises
- (2) In this paragraph, an irresponsible promotion means any one or more of the following activities, or substantially similar activities, carried on for the purpose of encouraging the sale or supply of alcohol for consumption on the premises;
 - (a) games or other activities which require or encourage, or are designed to require or encourage, individuals to—
 - (i) drink a quantity of alcohol within a time limit (other than to drink alcohol sold or supplied on the premises before the cessation of the period in which the responsible person is authorised to sell or supply alcohol), or
 - (ii) drink as much alcohol as possible (whether within a time limit or otherwise);
 - (b) provision of unlimited or unspecified quantities of alcohol free or for a fixed or discounted fee to the public or to a group defined by a particular characteristic in a manner which carries a significant risk of undermining a licensing objective
 - (c) provision of free or discounted alcohol or any other thing as a prize to encourage or reward the purchase and consumption of alcohol over a period of 24 hours or less in a manner which carries a significant risk of undermining a licensing objective;
 - (d) selling or supplying alcohol in association with promotional posters or flyers on, or in the vicinity of, the premises which can reasonably be considered to condone, encourage or glamorise anti-social behaviour or to refer to the effects of drunkenness in any favourable manner;
 - (e) dispensing alcohol directly by one person into the mouth of another (other than where that other person is unable to drink without assistance by reason of disability)

2. The responsible person must ensure that free potable water is provided on request to customers where it is reasonably available.

3.
 - (1) The premises licence holder or club premises certificate holder must ensure that an age verification policy is adopted in respect of the premises in relation to the sale or supply of alcohol.
 - (2) The designated premises supervisor in relation to the premises licence must ensure that the supply of alcohol at the premises is carried on in accordance with the age verification policy
 - (3) The policy must require individuals who appear to the responsible person to be under 18 years of age (or such older age as may be specified in the policy) to produce on request, before being served alcohol, identification bearing their photograph, date of birth and either—
 - (a) a holographic mark, or
 - (b) an ultraviolet feature.

4. The responsible person must ensure that—
 - (a) where any of the following alcoholic drinks is sold or supplied for consumption on the premises (other than alcoholic drinks sold or supplied having been made up in advance ready for sale or supply in a securely closed container) it is available to customers in the following measures—
 - (i) beer or cider: ½ pint
 - (ii) gin, rum, vodka or whisky: 25 ml or 35 ml; and
 - (iii) still wine in a glass: 125 ml;
 - (b) these measures are displayed in a menu, price list or other printed material which is available to customers on the premises; and
 - (c) where a customer does not in relation to a sale of alcohol specify the quantity of alcohol to be sold, the customer is made aware that these measures are available.

5.
 1. A relevant person shall ensure that no alcohol is sold or supplied for consumption on or off the premises for a price which is less than the permitted price.
 2. For the purposes of the condition set out in paragraph 1—
 - (a) “duty” is to be construed in accordance with the Alcoholic Liquor Duties Act 1979;
 - (b) “permitted price” is the price found by applying the formula —

$$\mathbf{P = D + (D \times V)}$$

where —

- (i) **P** is the permitted price
 - (ii) **D** is the amount of duty chargeable in relation to the alcohol as if the duty were charged on the date of the sale or supply of the alcohol, and
 - (iii) **V** is the rate of value added tax chargeable in relation to the alcohol as if the value added tax were charged on the date of the sale or supply of the alcohol;
- (c) “relevant person” means, in relation to premises in respect of which there is in force a premises licence
- (i) the holder of the premises licence
 - (ii) the designated premises supervisor (if any) in respect of such a licence, or
 - (iii) the personal licence holder who makes or authorises a supply of alcohol under such a licence
- (d) “relevant person” means, in relation to premises in respect of which there is in force a club premises certificate, any member or officer of the club present on the premises in a capacity which enables the member or officer to prevent the supply in question; and
- (e) “value added tax” means value added tax charged in accordance with the Value Added Tax Act 1994
3. Where the permitted price given by Paragraph (b) of paragraph 2 would (apart from this paragraph) not be a whole number of pennies, the price given by that sub-paragraph shall be taken to be the price actually given by that sub-paragraph rounded up to the nearest penny.
4. (1) Sub-paragraph (2) applies where the permitted price given by Paragraph (b) of paragraph 2 on a day (“the first day”) would be different from the permitted price on the next day (“the second day”) as a result of a change to the rate of duty or value added tax
- (2) The permitted price which would apply on the first day applies to sales or supplies of alcohol which take place before the expiry of the period of 14 days beginning on the second day

The sale by retail of alcohol:

Sunday, Monday, Tuesday, Wednesday, Thursday, Friday and Saturday from 11:00 hours until midnight

On New Year’s Eve from the end of permitted hours to the start of permitted hours on the following day (or, if there are no permitted hours on the following day, midnight on 31st December).

Note: However, New Years Eve is subject to the Regulatory Reform (Special Occasion Licensing) Order 2002. Which means that while that order is in effect

the premises may remain open for the twelve hours between 11pm on New Years Eve and 11am on New Years Day.

For provision of Late Night Refreshment:

Sunday, Monday, Tuesday, Wednesday, Thursday, Friday and Saturday from 11:00 hours until midnight

Provision of Regulated Entertainment (recorded music)

Sunday, Monday, Tuesday, Wednesday, Thursday, Friday and Saturday from 11:00 hours until midnight

Private Entertainment

The premises may be used for the following purpose, that is to say, dancing, music, or other entertainment of the like kind which-

- a) is not a public entertainment but
- b) is promoted for private gain

Public Entertainment

Public Entertainment consisting of music and singing provided solely by the reproduction of recorded sound

Annex 2 - Conditions consistent with the operating Schedule

No person shall be employed for street touting

No person shall be employed to solicit for custom or be permitted to solicit for custom for business for the premises in any public place within a 500 metre radius of the premises as shown edged in red on the attached plan.

Annex 3 - Conditions attached after a hearing by the licensing authority

None

Annex 4 - Plans

The plans are those submitted to the licensing authority on the following date:

25th July 2005

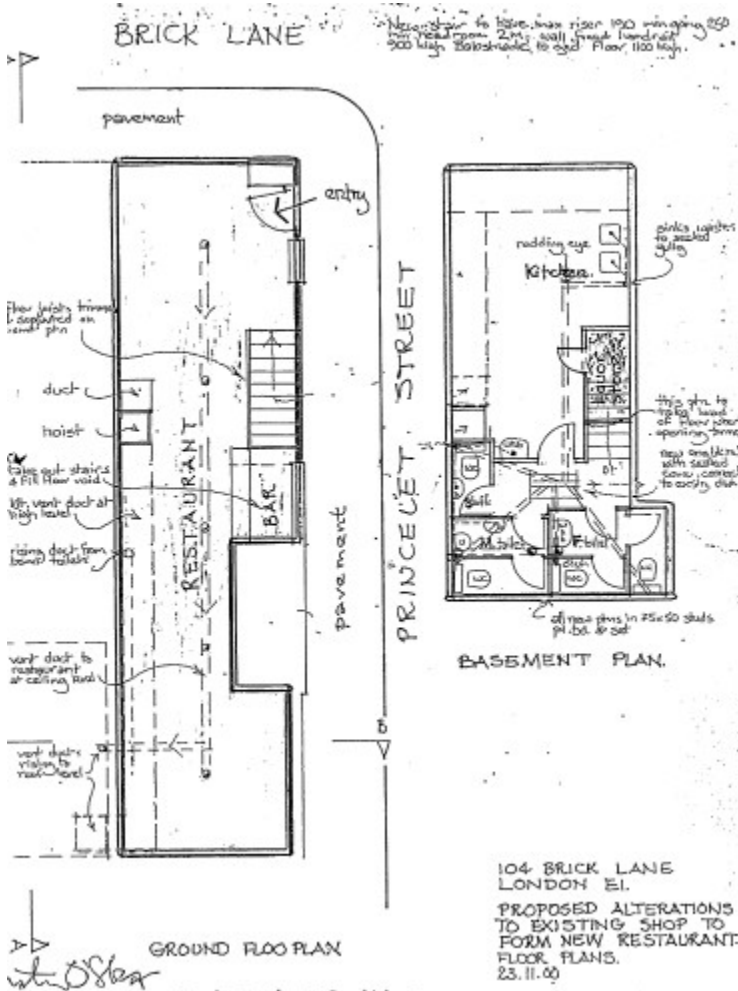

Part B - Premises licence summary

Premises licence number

162238

Premises details

Postal address of premises, or if none, ordnance survey map reference or description

104 Brick Lane

Post town

London

Post code

E1 6RL

Telephone number

0207 377 0033

Where the licence is time limited the dates

N/A

Licensable activities authorised by the licence

The sale by retail of alcohol
The provision of late night refreshment
The provision of regulated entertainment

The times the licence authorises the carrying out of licensable activities

Sunday, Monday, Tuesday, Wednesday, Thursday, Friday and Saturday from 11:00 hours until midnight

On New Year's Eve from the end of permitted hours to the start of permitted hours on the following day (or, if there are no permitted hours on the following day, midnight on 31st December).

Note: However, New Years Eve is subject to the Regulatory Reform (Special Occasion Licensing) Order 2002. Which means that while that order is in effect the premises may remain open for the twelve hours between 11pm on New Years Eve and 11am on New Years Day.

The opening hours of the premises

Sunday, Monday, Tuesday, Wednesday, Thursday, Friday and Saturday from 11:00 hours until midnight

On New Year's Eve from the end of permitted hours to the start of permitted hours on the following day (or, if there are no permitted hours on the following day, midnight on 31st December).

Note: However, New Years Eve is subject to the Regulatory Reform (Special Occasion Licensing) Order 2002. Which means that while that order is in effect the premises may remain open for the twelve hours between 11pm on New Years Eve and 11am on New Years Day.

For provision of Late Night Refreshment:

Sunday, Monday, Tuesday, Wednesday, Thursday, Friday and Saturday from 11:00 hours until midnight

Name, (registered) address of holder of premises licence	104 Bar Limited 104 Brick Lane London E1 6RL 
--	---

Where the licence authorises supplies of alcohol whether these are on and / or off supplies	On sales only
---	---------------

Registered number of holder, for example company number, charity number (where applicable)	14023454
--	----------

Name of designated premises supervisor where the premises licence authorises for the supply of alcohol	Carlos Tituana
--	----------------

State whether access to the premises by children is restricted or prohibited	No restrictions
--	-----------------

Appendix 2

Application to vary a premises licence under the Licensing Act 2003

PLEASE READ THE FOLLOWING INSTRUCTIONS FIRST

Before completing this form please read the guidance notes at the end of the form. If you are completing this form by hand please write legibly in block capitals. In all cases ensure that your answers are inside the boxes and written in black ink. Use additional sheets if necessary.

You may wish to keep a copy of the completed form for your records.

We 104 Bar Limited-----

being the premises licence holder, apply to vary a premises licence under section 34 of the Licensing Act 2003 for the premises described in Part 1 below

Premises licence number 162230
--

Part 1 – Premises Details

Postal address of premises or, if none, ordnance survey map reference or description 104 Brick Lane			
Post town	London	Postcode	E1 6RL

Telephone number at premises (if any)	██████████
Non-domestic rateable value of premises	£25,000

Part 2 – Applicant details

Daytime contact telephone number	██████████		
E-mail address (optional)	██████████		
Current postal address if different from premises address			
Post town		Postcode	

Part 3 - Variation

Please tick as appropriate

Do you want the proposed variation to have effect as soon as possible? Yes No

If not, from what date do you want the variation to take effect? DD MM YYYY

--	--	--	--	--	--	--	--

Do you want the proposed variation to have effect in relation to the introduction of the late night levy? (Please see guidance note 1) Yes No

Please describe briefly the nature of the proposed variation (Please see guidance note 2)

Extend operating hours from 12am to 2am, two days a week (Friday and Saturday) for late night refreshments only. Fast food. No sale of alcohol

If your proposed variation would mean that 5,000 or more people are expected to attend the premises at any one time, please state the number expected to attend:

--

Part 4 Operating Schedule

Please complete those parts of the Operating Schedule below which would be subject to change if this application to vary is successful.

- | Provision of regulated entertainment (Please see guidance note 3) | Please tick all that apply |
|---|-------------------------------------|
| a) plays (if ticking yes, fill in box A) | <input type="checkbox"/> |
| b) films (if ticking yes, fill in box B) | <input type="checkbox"/> |
| c) indoor sporting events (if ticking yes, fill in box C) | <input type="checkbox"/> |
| d) boxing or wrestling entertainment (if ticking yes, fill in box D) | <input type="checkbox"/> |
| e) live music (if ticking yes, fill in box E) | <input type="checkbox"/> |
| f) recorded music (if ticking yes, fill in box F) | <input type="checkbox"/> |
| g) performances of dance (if ticking yes, fill in box G) | <input type="checkbox"/> |
| h) anything of a similar description to that falling within (e), (f) or (g) (if ticking yes, fill in box H) | <input checked="" type="checkbox"/> |

Provision of late night refreshment (if ticking yes, fill in box I)

Supply of alcohol (if ticking yes, fill in box J)

In all cases complete boxes K, L and M

A

Plays Standard days and timings (please read guidance note 8)			Will the performance of a play take place <u>indoors or outdoors or both</u> – please tick (please read guidance note 4)	Indoors	<input type="checkbox"/>
				Outdoors	<input type="checkbox"/>
				Both	<input type="checkbox"/>
Day	Start	Finish			
Mon			<u>Please give further details here</u> (please read guidance note 5)		
Tue					
Wed			<u>State any seasonal variations for performing plays</u> (please read guidance note 6)		
Thur					
Fri			<u>Non standard timings. Where you intend to use the premises for the performance of plays at different times to those listed in the column on the left, please list</u> (please read guidance note 7)		
Sat					
Sun					

B

Films Standard days and timings (please read guidance note 8)			<u>Will the exhibition of films take place indoors or outdoors or both – please tick</u> (please read guidance note 4)	Indoors	<input type="checkbox"/>			
				Outdoors	<input type="checkbox"/>			
				Both	<input type="checkbox"/>			
Day	Start	Finish	<u>Please give further details here</u> (please read guidance note 5)					
Mon								
Tue								
Wed						<u>State any seasonal variations for the exhibition of films</u> (please read guidance note 6)		
Thur								
			<u>Non standard timings. Where you intend to use the premises for the exhibition of films at different times to those listed in the column on the left, please list</u> (please read guidance note 7)					
Fri								
Sat								
Sun								

C

Indoor sporting events Standard days and timings (please read guidance note 8)			Please give further details (please read guidance note 5)
Day	Start	Finish	
Mon			State any seasonal variations for indoor sporting events (please read guidance note 6)
Tue			Non standard timings. Where you intend to use the premises for indoor sporting events at different times to those listed in the column on the left, please list (please read guidance note 7)
Wed			
Thur			
Fri			
Sat			
Sun			

D

Boxing or wrestling entertainments Standard days and timings (please read guidance note 8)			<u>Will the boxing or wrestling entertainment take place indoors or outdoors or both – please tick</u> (please read guidance note 4)	Indoors	<input type="checkbox"/>
				Outdoors	<input type="checkbox"/>
				Both	<input type="checkbox"/>
Day	Start	Finish	<u>Please give further details here</u> (please read guidance note 5)		
Mon					
Tue			<u>State any seasonal variations for boxing or wrestling entertainment</u> (please read guidance note 6)		
Wed					
Thur			<u>Non standard timings. Where you intend to use the premises for boxing or wrestling entertainment at different times to those listed in the column on the left, please list</u> (please read guidance note 7)		
Fri					
Sat					
Sun					

E

Live music Standard days and timings (please read guidance note 8)			Will the performance of live music take place <u>indoors or outdoors or both</u> – please tick (please read guidance note 4)	Indoors	<input type="checkbox"/>
				Outdoors	<input type="checkbox"/>
				Both	<input type="checkbox"/>
Day	Start	Finish			
Mon			<u>Please give further details here</u> (please read guidance note 5)		
Tue					
Wed			<u>State any seasonal variations for the performance of live music</u> (please read guidance note 6)		
Thur					
Fri			<u>Non standard timings. Where you intend to use the premises for the performance of live music at different times to those listed in the column on the left, please list</u> (please read guidance note 7)		
Sat					
Sun					

F

Recorded music Standard days and timings (please read guidance note 8)			Will the playing of recorded music take place <u>indoors or outdoors or both</u> – please tick (please read guidance note 4)	Indoors	<input type="checkbox"/>
				Outdoors	<input type="checkbox"/>
				Both	<input type="checkbox"/>
Day	Start	Finish			
Mon			<u>Please give further details here</u> (please read guidance note 5)		
Tue					
Wed			<u>State any seasonal variations for the playing of recorded music</u> (please read guidance note 6)		
Thur					
Fri			<u>Non standard timings. Where you intend to use the premises for the playing of recorded music at different times to those listed in the column on the left, please list</u> (please read guidance note 7)		
Sat					
Sun					

G

Performances of dance Standard days and timings (please read guidance note 8)			Will the performance of dance take place indoors or outdoors or both – please tick (please read guidance note 4)	Indoors	<input type="checkbox"/>
Day	Start	Finish		Outdoors	<input type="checkbox"/>
				Both	<input type="checkbox"/>
Mon			Please give further details here (please read guidance note 5)		
Tue			State any seasonal variations for the performance of dance (please read guidance note 6)		
Wed			Non standard timings. Where you intend to use the premises for the performance of dance at different times to those listed in the column on the left, please list (please read guidance note 7)		
Thur					
Fri					
Sat					
Sun					

H

Anything of a similar description to that falling within (e), (f) or (g) Standard days and timings (please read guidance note 8)			Please give a description of the type of entertainment you will be providing Provisions of regulated entertainment		
Day	Start	Finish	<u>Will this entertainment take place indoors or outdoors or both – please tick</u> (please read guidance note 4)	Indoors	<input checked="" type="checkbox"/>
Mon	11:00	00:00		Outdoors	<input type="checkbox"/>
				Both	<input type="checkbox"/>
Tue	11:00	00:00	<u>Please give further details here</u> (please read guidance note 5)		
Wed	11:00	00:00			
Thur	11:00	00:00	<u>State any seasonal variations for entertainment of a similar description to that falling within (e), (f) or (g)</u> (please read guidance note 6)		
Fri	11:00	00:00			
Sat	11:00	00:00	<u>Non standard timings. Where you intend to use the premises for the entertainment of a similar description to that falling within (e), (f) or (g) at different times to those listed in the column on the left, please list</u> (please read guidance note 7)		
Sun	11:00	00:00			

I

Late night refreshment Standard days and timings (please read guidance note 8)			Will the provision of late night refreshment take place indoors or outdoors or both – please tick (please read guidance note 4)	Indoors	<input checked="" type="checkbox"/>
				Outdoors	<input type="checkbox"/>
				Both	<input type="checkbox"/>
Day	Start	Finish			
Mon	11:00	00:00	Please give further details here (please read guidance note 5) Late night refreshments on Friday and Saturday only. No amplified music.		
Tue	11:00	00:00			
Wed	11:00	00:00	State any seasonal variations for the provision of late night refreshment (please read guidance note 6)		
Thur	11:00	00:00			
Fri	11:00	02:00	Non standard timings. Where you intend to use the premises for the provision of late night refreshment at different times, to those listed in the column on the left, please list (please read guidance note 7)		
Sat	11:00	02:00			
Sun	11:00	00:00			

J

Supply of alcohol Standard days and timings (please read guidance note 8)			Will the supply of alcohol be for consumption – please tick (please read guidance note 9)	On the premises	<input checked="" type="checkbox"/>			
				Off the premises	<input type="checkbox"/>			
				Both	<input type="checkbox"/>			
Day	Start	Finish	State any seasonal variations for the supply of alcohol (please read guidance note 6)					
Mon	11:00	00:00						
Tue	11:00	00:00						
Wed	11:00	00:00						
Thur	11:00	00:00				Non-standard timings. Where you intend to use the premises for the supply of alcohol at different times to those listed in the column on the left, please list (please read guidance note 7)		
Fri	11:00	00:00						
Sat	11:00	00:00						
Sun	11:00	00:00						

K

<p>Please highlight any adult entertainment or services, activities, other entertainment or matters ancillary to the use of the premises that may give rise to concern in respect of children (please read guidance note 10).</p>
--

L

Hours premises are open to the public Standard days and timings (please read guidance note 8)			<u>State any seasonal variations</u> (please read guidance note 6)
Day	Start	Finish	
Mon	11:00	00:00	<p><u>Non standard timings. Where you intend the premises to be open to the public at different times from those listed in the column on the left, please list</u> (please read guidance note 7)</p>
Tue	11:00	00:00	
Wed	11:00	00:00	
Thur	11:00	00:00	
Fri	11:00	02:00	
Sat	11:00	02:00	
Sun	11:00	00:00	

Please identify those conditions currently imposed on the licence which you believe could be removed as a consequence of the proposed variation you are seeking.

Please tick as appropriate

- I have enclosed the premises licence
- I have enclosed the relevant part of the premises licence

If you have not ticked one of these boxes, please fill in reasons for not including the licence or part of it below

Reasons why I have not enclosed the premises licence or relevant part of premises licence.

Pending transfer of premises licence. Ref: 162230

M Describe any additional steps you intend to take to promote the four licensing objectives as a result of the proposed variation:

a) General – all four licensing objectives (b, c, d and e) (please read guidance note 11)

b) The prevention of crime and disorder

c) Public safety

d) The prevention of public nuisance

e) The protection of children from harm

Checklist:

Please tick to indicate agreement

- I have made or enclosed payment of the fee; or
- I have not made or enclosed payment of the fee because this application has been made in relation to the introduction of the late night levy.
- I have sent copies of this application and the plan to responsible authorities and others where applicable.
- I understand that I must now advertise my application.
- I have enclosed the premises licence or relevant part of it or explanation.
- I understand that if I do not comply with the above requirements my application will be rejected.

IT IS AN OFFENCE, UNDER SECTION 158 OF THE LICENSING ACT 2003, TO MAKE A FALSE STATEMENT IN OR IN CONNECTION WITH THIS APPLICATION. THOSE WHO MAKE A FALSE STATEMENT MAY BE LIABLE ON SUMMARY CONVICTION TO A FINE OF ANY AMOUNT.

Part 5 – Signatures (please read guidance note 12)

Signature of applicant (the current premises licence holder) or applicant’s solicitor or other duly authorised agent (please read guidance note 13). **If signing on behalf of the applicant, please state in what capacity.**

Signature	
Date	20/10/23
Capacity	Designated premises supervisor

Where the premises licence is jointly held, signature of 2nd applicant (the current premises licence holder) or 2nd applicant’s solicitor or other authorised agent (please read guidance note 14). **If signing on behalf of the applicant, please state in what capacity.**

Signature	
Date	
Capacity	

Contact name (where not previously given) and address for correspondence associated with this application (please read guidance note 15)

<p>Contact name (where not previously given) and address for correspondence associated with this application (please read guidance note 15)</p>			
Post town		Post code	
Telephone number (if any)			

If you would prefer us to correspond with you by e-mail, your e-mail address (optional)

Notes for Guidance

This application cannot be used to vary the licence so as to extend the period for which the licence has effect or to vary substantially the premises to which it relates. If you wish to make that type of change to the premises licence, you should make a new premises licence application under section 17 of the Licensing Act 2003.

1. You do not have to pay a fee if the only purpose of the variation for which you are applying is to avoid becoming liable for the late night levy
2. Describe the premises. For example, the type of premises, its general situation and layout and any other information which could be relevant to the licensing objectives. Where your application includes off-supplies of alcohol and you intend to provide a place of consumption of these off-supplies of alcohol, you must include a description of where the place will be and its proximity to the premises.
3. In terms of specific regulated entertainments please note that:
 - Plays: no licence is required for performances between 08.00 and 23.00 on any day, provided that the audience does not exceed 500.
 - Films: no licence is required for 'not-for-profit' film exhibition held in community premises between 08.00 and 23.00 on any day provided that the audience does not exceed 500 and the organiser (a) gets consent to the screening from a person who is responsible for the premises; and (b) ensures that each such screening abides by age classification ratings.
 - Indoor sporting events: no licence is required for performances between 08.00 and 23.00 on any day, provided that the audience does not exceed 1000.
 - Boxing or Wrestling Entertainment: no licence is required for a contest, exhibition or display of Greco-Roman wrestling, or freestyle wrestling between 08.00 and 23.00 on any day, provided that the audience does not exceed 1000. Combined fighting sports – defined as a contest, exhibition or display which combines boxing or wrestling with one or more martial arts – are licensable as a boxing or wrestling entertainment rather than an indoor sporting event.
 - Live music: no licence permission is required for:
 - a performance of unamplified live music between 08.00 and 23.00 on any day, on any premises.
 - a performance of amplified live music between 08.00 and 23.00 on any day on premises authorised to sell alcohol for consumption on those premises, provided that the audience does not exceed 500.
 - a performance of amplified live music between 08.00 and 23.00 on any day, in a workplace that is not licensed to sell alcohol on those premises, provided that the audience does not exceed 500.
 - a performance of amplified live music between 08.00 and 23.00 on any day, in a church hall, village hall, community hall, or other similar community premises, that is not licensed by a premises licence to sell alcohol, provided that (a) the audience does not exceed 500, and (b) the organiser gets consent for the performance from a person who is responsible for the premises.
 - a performance of amplified live music between 08.00 and 23.00 on any day, at the non-residential premises of (i) a local authority, or (ii) a school, or (iii) a hospital, provided that (a) the audience does not exceed 500, and (b) the organiser gets consent for the performance on the relevant premises from: (i) the local authority concerned, or (ii) the school or (iii) the health care provider for the hospital.

- Recorded Music: no licence permission is required for:
 - any playing of recorded music between 08.00 and 23.00 on any day on premises authorised to sell alcohol for consumption on those premises, provided that the audience does not exceed 500.
 - any playing of recorded music between 08.00 and 23.00 on any day, in a church hall, village hall, community hall, or other similar community premises, that is not licensed by a premises licence to sell alcohol, provided that (a) the audience does not exceed 500, and (b) the organiser gets consent for the performance from a person who is responsible for the premises.
 - any playing of recorded music between 08.00 and 23.00 on any day, at the non-residential premises of (i) a local authority, or (ii) a school, or (iii) a hospital, provided that (a) the audience does not exceed 500, and (b) the organiser gets consent for the performance on the relevant premises from: (i) the local authority concerned, or (ii) the school proprietor or (iii) the health care provider for the hospital.
 - Dance: no licence is required for performances between 08.00 and 23.00 on any day, provided that the audience does not exceed 500. However, a performance which amounts to adult entertainment remains licensable.
 - Cross activity exemptions: no licence is required between 08.00 and 23.00 on any day, with no limit on audience size for:
 - any entertainment taking place on the premises of the local authority where the entertainment is provided by or on behalf of the local authority;
 - any entertainment taking place on the hospital premises of the health care provider where the entertainment is provided by or on behalf of the health care provider;
 - any entertainment taking place on the premises of the school where the entertainment is provided by or on behalf of the school proprietor; and
 - any entertainment (excluding films and a boxing or wrestling entertainment) taking place at a travelling circus, provided that (a) it takes place within a moveable structure that accommodates the audience, and (b) that the travelling circus has not been located on the same site for more than 28 consecutive days.
4. Where taking place in a building or other structure please tick as appropriate (indoors may include a tent).
 5. For example state type of activity to be authorised, if not already stated, and give relevant further details, for example (but not exclusively) whether or not music will be amplified or unamplified.
 6. For example (but not exclusively), where the activity will occur on additional days during the summer months.
 7. For example (but not exclusively), where you wish the activity to go on longer on a particular day e.g. Christmas Eve.
 8. Please give timings in 24 hour clock (e.g. 16.00) and only give details for the days of the week when you intend the premises to be used for the activity.
 9. If you wish people to be able to consume alcohol on the premises, please tick 'on the premises'. If you wish people to be able to purchase alcohol to consume away from the premises, please tick 'off the premises'. If you wish people to be able to do both, please tick 'both'.
 10. Please give information about anything intended to occur at the premises or ancillary to the use of the premises which may give rise to concern in respect of children regardless of whether you intend children to have access to the premises, for example (but not exclusively) nudity or semi-nudity, films for restricted age groups or the presence of gaming machines.
 11. Please list here steps you will take to promote all four licensing objectives together.

12. The application form must be signed.
13. An applicant's agent (for example solicitor) may sign the form on their behalf provided that they have actual authority to do so.
14. Where there is more than one applicant, each of the applicants or their respective agents must sign the application form.
15. This is the address which we shall use to correspond with you about this application.

Appendix 3

Photos – 104 Brick Lane





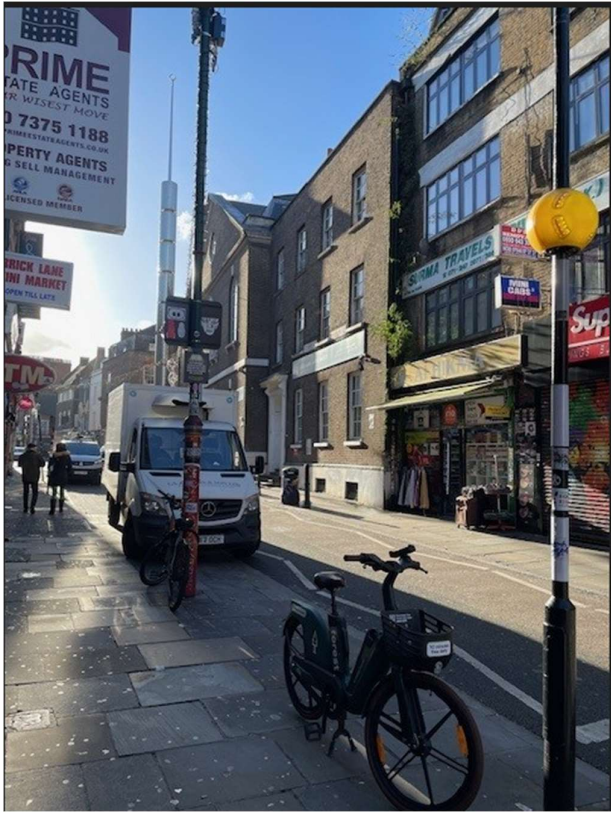



Appendix 4

Maps – 104 Brick Lane

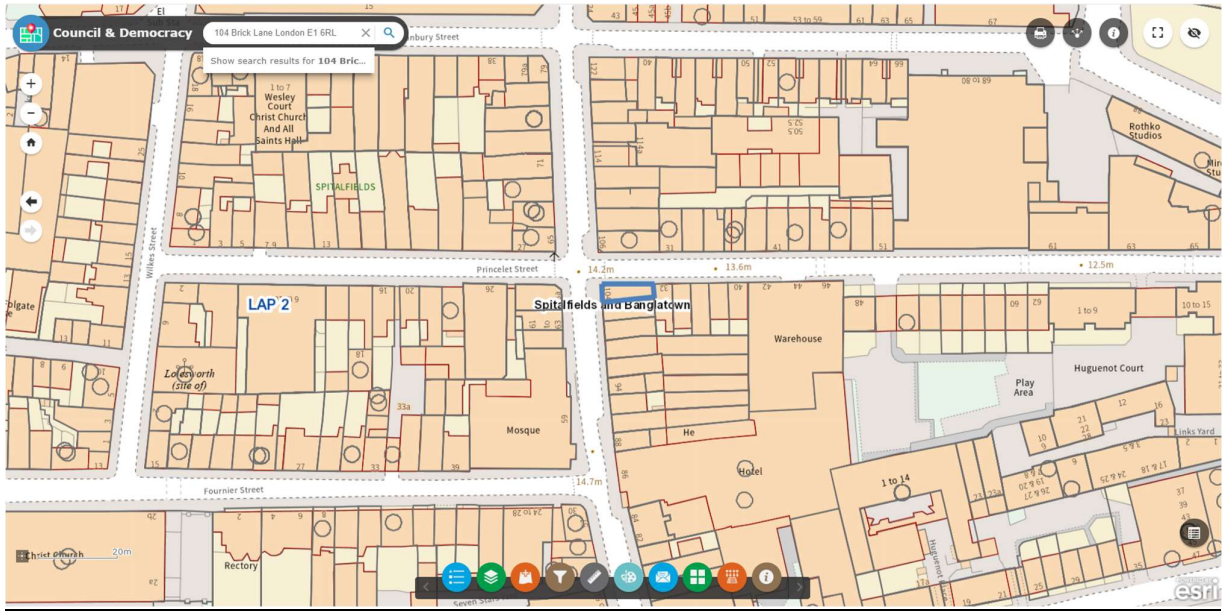
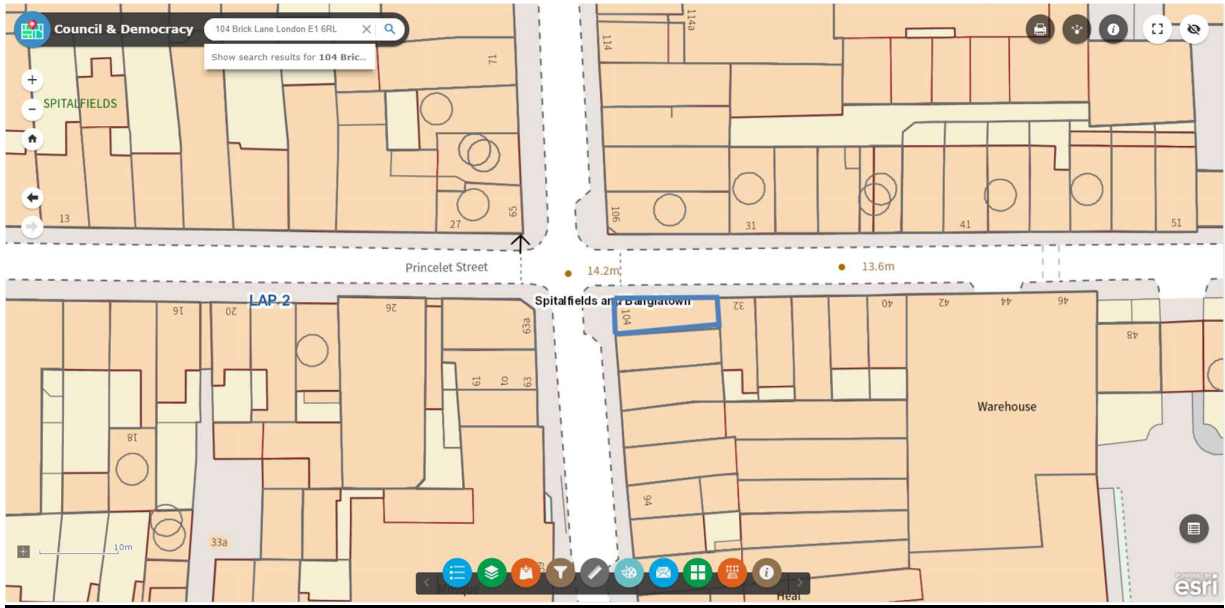

Appendix 5

Nearby Licensed Premises – 104 Brick Lane

<u>Name & address</u>	<u>Licensable activities</u>	<u>Opening Hours</u>
<p>(Brick Lane Brasserie) 67 Brick Lane</p>	<p><u>Alcohol and Regulated Entertainment (Recorded Music)</u></p> <ul style="list-style-type: none"> • Monday to Sunday, 11:00 hrs to 00:00 hrs <p><u>Late Night Refreshment</u></p> <ul style="list-style-type: none"> • Monday to Sunday, 23:00 hrs to 00:00 hrs 	<ul style="list-style-type: none"> • Monday to Sunday, 11:00 hrs to 00:30 hrs
<p>(Standard Balti House) 71 Brick Lane</p>	<p><u>For the Supply of Alcohol (on & off sales) and Late Night Refreshment</u></p> <p>Sunday to Thursday 11 00 hrs to midnight Friday and Saturday 11 00 hrs to 01 00 hrs the following day</p>	<p>Sunday to Thursday 11 00 hrs to 01 00 hrs the following day Friday and Saturday 11 00 hrs to 02 00 hrs the following day</p>
<p>(Muhib Indian Cuisine) 73 Brick Lane</p>	<p><u>Hours for the Sale of Alcohol (on sales)</u></p> <ul style="list-style-type: none"> • Sunday from 11:00 hours to 23:30 hours • Monday to Wednesday from 11:00 hours to 24:00 hours (midnight) • Thursday to Saturday from 11:00 hours to 01:30 hours the next day. <p><u>Provision of Late-Night Refreshment</u></p> <ul style="list-style-type: none"> • Sunday from 11:00 hours to 23:30 hours • Monday to Wednesday from 11:00 hours to 	<ul style="list-style-type: none"> • Sunday from 11:00 hours to 24:00 hours (midnight) • Monday to Wednesday from 11:00 hours to 00:30 hours the next day • Thursday to Saturday from 11:00 hours to 02:00 hours the next day.

	<p>24:00 hours (midnight)</p> <ul style="list-style-type: none"> Thursday to Saturday from 11:00 hours to 01:30 hours the next day. 	
<p>(Bengal Village) 75 Brick Lane</p>	<p><u>Sale of Alcohol (on sales)</u> (1) On weekdays, other than Christmas Day, Good Friday or New Year's Eve from 10am to midnight. (2) On Sundays, other than Christmas Day or New Year's Eve, and on Good Friday: 12 noon to 11:30pm</p> <p><u>Late Night Refreshment</u> On weekdays from 23:00 hours to midnight On Sundays from 23:00 hours to 23:30 hours</p>	<p>No restrictions</p>
<p>(Curry Bazaar) 77 Brick Lane</p>	<p>The sale by retail of alcohol (on sales)</p> <ul style="list-style-type: none"> Sunday - Thursday from 11:00 hours until midnight Friday and Saturday from 11:00 hours until 02:00 hours the following day. <p><u>For provision of Late Night Refreshment:</u></p> <ul style="list-style-type: none"> Sunday - Thursday from 11:00 hours until midnight 	<ul style="list-style-type: none"> Sunday -Thursday from 11:00 hours until 00:30 hours the following day Friday and Saturday from 11:00 hours until 02:30 hours the following day.

	<ul style="list-style-type: none"> • Friday and Saturday from 11:00 hours until 02:00 hours the following day. 	
<p>(Bubble and Scoop) 79 Brick Lane</p>	<p><u>The sale by retail of alcohol (on sales only)</u></p> <ul style="list-style-type: none"> • Sunday to Thursday from 10:00hrs to 23:30hrs • Friday and Saturday from 10:00hrs to 00:30hrs (the following day) <p><u>Provision of Late-Night Refreshment</u></p> <ul style="list-style-type: none"> • Sunday to Thursday from 23:00hrs to 00:00hrs (midnight) • Friday and Saturday from 23:00hrs to 01:00hrs (the following day) <p><u>Seated</u></p> <ul style="list-style-type: none"> • Sunday to Thursday up to 00:00hrs (midnight) • Friday and Saturday up to 00:30hrs (the following day) 	<ul style="list-style-type: none"> • Sunday to Thursday from 08:00hrs to 00:00hrs (midnight) • Friday and Saturday from 08:00hrs to 01:00hrs (the following day)
<p>(Enso Restaurant) 94 Brick Lane</p>	<p><u>Supply of Alcohol (on sales)</u></p> <ul style="list-style-type: none"> • Monday to Saturday, from 12:00 hours to 23:30 hours • Sunday, from 12:00 hours to 23:00 hours 	<ul style="list-style-type: none"> • Monday to Saturday, from 12:00 hours to midnight • Sunday, from 12:00 hours to 23:30 hours

	<p>Regulated Entertainment <u>(Recorded music)</u></p> <ul style="list-style-type: none"> Monday to Saturday, from 23:00 hours to midnight Sunday, from 23:00 hours to 23:30 hours <p>Late Night Refreshment</p> <ul style="list-style-type: none"> Monday to Saturday, from 12:00 hours to 23:30 hours Sunday, from 12:00 hours to 23:00 hours 	
<p>Saporita 108 Brick Lane</p>	<p><u>Sale of Alcohol (on and off sales)</u> Monday to Saturday from 12:00 hours to 23:30 hours Sunday from 12:00 hours to 22:30 hours</p> <p><u>The Provision of Regulated Entertainment</u> (Recorded music only) Monday to Saturday from 12:00 hours to 23:30 hours Sunday from 12:00 hours to 22:30 hours</p> <p><u>The Provision of Late Night Refreshment</u> Monday to Sunday, 23.00pm to Midnight</p>	Monday to Sunday, from 12:00 hours to Midnight
<p>(Brick Lane Off Licence) 114 Brick Lane</p>	<p><u>Sale of Alcohol (Off Sales Only)</u> Monday to Saturday from 09:00 to midnight Sunday from 10:00 hrs to 23:00 hrs</p>	Monday to Saturday from 09:00 to midnight Sunday from 10:00 hrs to 23:00 hrs

<p>(Preem) 118 -122 Brick Lane</p>	<p><u>Sale of Alcohol (On Sales Only)</u></p> <ul style="list-style-type: none"> Monday to Sunday from 12:00hrs (midday) to 01:00hrs (the following day) <p><u>The Provision for Late Night Refreshment</u></p> <ul style="list-style-type: none"> Monday to Sunday from 23:00hrs to 01:00hrs (the following day) 	<ul style="list-style-type: none"> Monday to Sunday from 12:00hrs (midday) to 01:30hrs (the following day)
<p>A & Y Wines) 116 Brick Lane</p>	<p><u>The sale by retail of alcohol (off sales)</u></p> <p>Monday to Sunday 08 00 hrs to 02 30 hrs the following day</p>	<p>Monday to Sunday 08 00 hrs to 02 30 hrs the following day</p>

Appendix 6

Sent to:

Licensing Authority: [REDACTED]
Applicant: [REDACTED]

Communities Directorate
Public Realm

Licensing & Safety Team
Licensing and Safety Team
Environmental Health and Trading
Standards
4th Floor Tower Hamlets Town Hall
160 Whitechapel Road
London E1 1BJ

12th December 2023

My reference: P/EHTS/LIC/164801/LMI

Email: licensing@towerhamlets.gov.uk

www.towerhamlets.gov.uk

Dear Licensing Authority,

Licensing Act 2003
Variation premise licence 104 Brick Lane E1 6RL

The Licensing Authority (acting a Responsible Authority) is making a representation against the above application.

Special Cumulative Impact Policy for the Brick Lane

This special policy creates a rebuttable presumption that applications for the grant or variation of premises licences or club premises certificates which are likely to add to the existing cumulative impact will normally be refused following the receipt of representations, unless the applicant can demonstrate in the operation schedule that there will be no negative cumulative impacts with one or more of the licensing objectives.

The Council reviewed the Special Cumulative Impact Policy in 2021 and, following consultation, decided it was still of the opinion that the concentration of licensed premises within Brick Lane area was having a cumulative impact on the licensing objectives of crime and disorder and prevention of public nuisance.

The Licensing Authority is of the view that the number, type and density of premises selling/supplying alcohol for consumption on and off the premises and/or the provision of late-night refreshment in the Brick Lane is having a cumulative impact on the licensing objectives. Therefore, it is likely that granting further licences would be inconsistent with the authority's duty to promote the licensing objectives. Thus, it has declared a cumulative impact assessment within these areas.

This Policy will be strictly applied and where relevant representations are received and it is the view of the Council that the application will be refused. Applicants will need to demonstrate that there are exceptional circumstances and that granting their application will not negatively add to the cumulative effect on the Licensing Objectives within the Brick Lane CIA if they wish to rebut this presumption.

The Special Cumulative Impact policy creates a rebuttable presumption that where relevant representations are received by one or more of the responsible authorities and/or other persons against applications (Councillors, Members of the Public) within the CIA zones the application will be refused.

Where representations have been received in respect to applications within the CIA zones the onus is on the applicant to adequately rebut the presumption.

This special policy is not absolute and the Licensing Authority recognises that it has to balance the needs of businesses with local residents. The circumstances of each application will be considered on its merits and the Licensing Authority shall grant applications when representations are not received. The applicant should demonstrate that the operation of the premises will not add to the cumulative impact on one or more of the following licensing objectives:

- Prevention of Crime and Disorder;
- Prevention of Public Nuisance.

Therefore, applicants will be expected to comprehensively demonstrate why a new or varied licence will not add to the cumulative impact. They are strongly advised to give consideration to mitigating potential cumulative impact issues when setting out steps they will take to promote the licensing objectives in their operating schedule.

Possible exceptions to the Brick Lane and Bethnal Green Cumulative Impact Assessments

- Applications for licences for small premises with a capacity of fifty persons or less who only intend to operate within framework hours, and that;
 - Only have consumption of food (late night refreshment) and drink (alcohol) on the premises only,
 - Only provide Off sales of food (late night refreshment) and drink (alcohol) for delivery (i.e. not for take away),and,
 - Have arrangements to prevent vertical drinking, for example fully seated venues;
- Applications for licences that are not alcohol led (e.g. Hairdressers wanting to provide alcohol to clients during their hair cut/treatments),
- Applications for licences where the applicant has recently surrendered a licence for another premises of a similar size and providing similar licensable activities in the same CIA Area.

Licensing Authority will **not** consider the following as possible exceptions:

- that the premises will be well managed and run,
- that the premises will be constructed to a high standard,
- that the applicant operates similar premises elsewhere without complaint.

Licensable activities and times

The Licensing Authority has had regard to the Guidance to the Act when determining this policy. The end times set out in the policy are not (and should not be regarded as) the 'usual' or 'normal' terminal hour for licensable activities in the Borough. Instead, the 'framework hours' serve to identify cases where the Licensing Authority will pay particular regard to the likely effect on the local neighbourhood of carrying out the proposed licensable activities during the hours applied for. Applications for hours up to the end of the Framework Hours will not automatically be granted. This policy will be applied only where relevant representations are made. Each case will be considered on its merits.

- Sunday – 06:00 hours to 22:30 hours

- *Monday to Thursday* – 06:00 hours to 23:30 hours
- *Friday and Saturday* – 06:00 hours to 00:00 hours (midnight)

Applications in respect of premises licences and club premises certificates to authorise licensable activities outside the framework hours, and in respect of which relevant representations are made, will be decided on their own merits and with particular regard to the following.

- a) The location of the premises and the general character of the area in which the premises are situated. (i.e. does the area include residential or business premises likely to be adversely affected).*
- b) The proposed hours during which licensable activities will be take place and the proposed hours during which customers will be permitted to remain on the premises.*
- c) The adequacy of the applicant’s proposals to address the issues of the prevention of crime and disorder and the prevention of public nuisance.*
- d) Where the premises have been previously licensed, the past operation of the premises.*
- e) Whether customers have access to public transport when arriving at or leaving the premises at night time and in the early hours of the morning.*
- f) The proximity of the premises to other licensed premises in the vicinity and the hours of those other premises.*

The Home Office guidance

under Section 182 of the Licensing Act 2003 (8.42) says:

“Applicants are, in particular, expected to obtain sufficient information to enable them to demonstrate, when setting out the steps they propose to take to promote the licensing objectives, that they understand:

- *the layout of the local area and physical environment including crime and disorder hotspots, proximity to residential premises and proximity to areas where children may congregate;*
- *any risk posed to the local area by the applicants’ proposed licensable activities; and*
- *any local initiatives (for example, local crime reduction initiatives or voluntary schemes including local taxi-marshalling schemes, street pastors and other schemes) which may help to mitigate potential risks.”*

Application:

The applicant has described the application as, to extend the operating hours from 00:00 hours to 02:00 hours on Friday and Saturday for late night refreshments only.

The premises already has a licence for:

- **Sales of Alcohol**
Monday to Sunday from 11:00 hours to 00:00 hours
- **Late Night Refreshments**
Monday to Sunday from 11:00 hours to 00:00 hours
- **Hours open to the public**
Monday to Sunday from 11:00 hours to 00:30 hours

The hours applied for:

- **Provisions of regulated entertainment (indoors) (section H of the application only)**
- 11:00 hours to 00:00 hours
- **Late night refreshments (indoors)**
Sunday to Thursday 11:00 hours – 00:00 hours (current hours)
Friday to Saturday 11:00 hours – 02:00 hours
- **Opening hours**
Monday to Sunday 11:00 hours to 23:30 hrs

The extension of hours is past the council's framework hours. The applicant has only applied for, the extension of late-night refreshment on the premises, and has given no explanation as to what customers will be doing on the premises for two hours, when only food will be offered for sale and regulated entertainment (anything of a similar nature). The applicant needs to explain further how they will prevent sales of alcohol from taking whilst open with only late-night refreshments licensed between 00:00 hours – 02:00 hours.

The current premises licence has no conditions mitigating potential cumulative impact issues, nor has the applicant acknowledged the CIA or demonstrate that, the operation of the premises with the extended hours will not add to the cumulative impact in regards to the following licensing objectives:

- prevention of public nuisance
- crime and disorder

On a balance of probability, this Authority is concerned by the addition of this premises offering late night refreshments in an already saturated area, potentially adding to the existing anti-social issues in the area.

If the applicant is unable to prove to the Licensing Sub-Committee, through the implementation of appropriate conditions within the Operating Schedule, that the granting of the application will not undermine the licensing objectives; then the application should be rejected.

Yours faithfully

[Redacted signature]

Lavine Miller-Johnson
Licensing Officer

[Redacted contact information]

Appendix 7

Corinne Holland

From: Nicola Cadzow
Sent: 09 November 2023 15:00
To: Licensing
Cc: 'MARK.J.Perry' [REDACTED]
Subject: 164120 MAU REPRESENTATION Variation of premises license for Bar 104 104 Brick Lane, London E1 6RL

Dear Licensing,

I have considered the variation of premises license application Bar 104 104 Brick Lane, London E1 6RL and the potential impact of public nuisance and measures to prevent noise generated from within the premises or outside it which could cause disturbance to people in the vicinity. The applicant is proposing licensable hours well beyond the Council's framework hours and consideration has to be given to the fact that the premises is in Brick Lane Cumulative Impact Zone (CIZ).

The applicant's is proposing Licensable Activities: Late Night Refreshment:

Friday and Saturday from Midnight until 02:00 hours (an extension of two hours on existing license hours)

There is insufficient information both In the existing license, or the operating schedule of the licence variation application to show how the applicant will promote the licensing objective for the prevention of public nuisance, with the impact on public from regulated entertainment, increase footfall from persons accessing and egressing the premises, particularly when considering the late hours applied for by the applicant, and the fact that the premises in the Brick Lane CIZ

Noise Sensitive premises: residential and commercial premises in close proximity to the premises.

In my view the application, as it stands fails, to comply with the objective of the Licensing Act 2003 relating to "public nuisance" for the following reasons:-

- Noise breakout from the venue affecting neighbouring residents.
- Access & egress to and from the venue, of patrons, especially due to patrons likely to be in high spirits; and
- The hours of operation (inclusive of proposals)

CONCLUSION

Environmental Protection **does not** support the variation application for Bar 104, 104 Brick Lane E1 6RL for the following reasons:

1. The applicant have not provided sufficient information to show how they will promote the licensing objective for the prevention of public nuisance, particularly when considering the late hours sought for Fridays and Saturdays
2. The premises is in Brick Lane Cumulative Impact Zone.

Kind regards

Nicola Cadzow
Environmental Protection Officer
Environmental Health and Trading Standards
4th Floor, Tower Hamlets Town Hall
160 Whitechapel Road
London, E1 1BJ

Appendix 8

Corinne Holland

From: MARK.J.Perry [REDACTED]
Sent: 12 December 2023 07:39
To: [REDACTED]
Cc: Licensing
Subject: RE: 104 Bar Variation application

Follow Up Flag: Follow up
Flag Status: Completed

Hi Carlos,

Tower Hamlets Council please see below conditions agreed with the applicant.

Kind Regards

Mark

PC Mark Perry
Central East Licensing Unit
Metropolitan Police Service (MPS)

-----Original Message-----

From: 104 Bar <[REDACTED]>
Sent: 11 December 2023 15:49
To: Perry Mark J - [REDACTED]
Subject: Re: 104 Bar Variation application

Hi Mark,

Thank
You for forwarding all the conditions. We agree to the conditions outlined below.

Regards
Carlos

> On 11 Dec 2023, at 15:15, MARK.J.Perry [REDACTED]

>

> Hi,

>

> Thanks for the e-mail, having read it and studied your application I believe that the following conditions will be needed to uphold the four licensing objectives.

>

>

> 1. The premises shall install and maintain a comprehensive CCTV system as per the minimum requirements of the Tower Hamlets Police Licensing Team. All entry and exit points will be covered enabling frontal identification of every person entering in any light condition. The CCTV system shall continually record whilst the premises is open for licensable activities and during all times when customers remain on the premises. All recordings shall be stored for a minimum period of 31 days with date and time stamping. Viewing of recordings shall be made available immediately upon the request of Police or authorised officer throughout the entire 31 day period.

>

> 2. A staff member from the premises who is conversant with the operation of the CCTV system shall be on the premises at all times when the premises are open. This staff member must be able to provide a Police or authorised council officer copies of recent CCTV images or data with the absolute minimum of delay when requested.

>

> 3. An incident log shall be kept at the premises, and be available on request to the Police or an authorised officer. It must be completed within 24 hours of any incident and will record the following:

>

> a) all crimes reported to the venue;

> b) all ejections of patrons;

> c) any complaints received concerning crime and disorder

> d) any incidents of disorder;

> e) all seizures of drugs or offensive weapons;

> f) any faults in the CCTV system, searching equipment or scanning equipment;

> g) any refusal of the sale of alcohol;

> h) any visit by a relevant authority or emergency service.

>

> 4. In the event that a serious assault is committed on the premises (or appears to have been committed) the management will immediately ensure that:

>

> a) the police (and, where appropriate, the London Ambulance Service) are called without delay;

> b) all measures that are reasonably practicable are taken to apprehend any suspects pending the arrival of the police;

> c) the crime scene is preserved so as to enable a full forensic investigation to be carried out by the police; and

> d) such other measures are taken (as appropriate) to fully protect the safety of all persons present on the premises.

>

> 5. A Challenge 25 proof of age scheme shall be operated at the premises where the only acceptable forms of identification are recognised photographic identification cards, such as a driving licence, passport or proof of age card with the PASS Hologram.

>

> 6. A record shall be kept detailing all refused sales of alcohol. The record should include the date and time of the refused sale and the name of the member of staff who refused the sale. The record must show the outcome of the person who was intoxicated. The record shall be available for inspection at the premises by the police or an authorised officer at all times whilst the premises is open.

>

> 7. A written dispersal and entry policy shall be in place and implemented at the premises to move customers into and away from the premises and the immediate vicinity in such a way as to cause minimum disturbance or nuisance to neighbours.

>

> 8. The premises shall have a written security plan that risk assesses events at the venue and shows what plans are in place to mitigate them. The security plan will include search policy, SIA security levels, welfare officer provision and ejection plans. Such a plans are to be written down and made available to relevant authorities upon request.

>

>

> If you are happy to agree to these conditions please reply to this e-mail letting me know and I will inform Tower Hamlets Council Licensing that we have agreed terms.

>

> Kind Regards

>

> Mark

>

>

> PC Mark Perry

> Central East Licensing Unit

> Metropolitan Police Service (MPS)

>

[REDACTED]

>

>

>

>

>

>

>

> -----Original Message-----

> From: 104 Bar [REDACTED]

> Sent: 08 December 2023 14:42

> To: Perry Mark J - [REDACTED]

> Cc: Licensing <Licensing@[REDACTED]>

> Subject: 104 Bar Variation applica on

>

>

> Dear Mark,

>

> Thank you for your time earlier.

> I would like to address the concerns raised in the objection to our application for the extension of operating hours at 104 Bar on Brick Lane.

>

> Firstly, I appreciate the Council's commitment to ensuring public peace and preventing disturbances in the neighborhood. In response to the concerns outlined, I would like to assure you that we take these matters seriously and are committed to implementing measures to mitigate any potential impact on public nuisance.

>

> To address the noise concerns, we are willing to cease all regulated entertainment activities during the extended hours. This includes a commitment not to play any recorded music at the store at all during the proposed hours of operation. Furthermore, we will take additional measures to prevent noise breakout from the venue, such as ensuring that patrons leave the premises quietly and orderly by putting up a sign on the way out.

>

> Additionally, we understand the significance of the premises being in the Brick Lane Cumulative Impact Zone (CIZ). To respect the surrounding noise-sensitive premises, we will implement strict crowd control measures during access and egress, ensuring that patrons do not disturb neighboring residents. We are also exploring the possibility of partnering with a professional security team to manage the flow of patrons responsibly.

>

> We believe that these proactive steps will address the concerns raised and demonstrate our commitment to promoting the licensing objective for the prevention of public nuisance. We understand the importance of

maintaining a harmonious coexistence with the community and are open to further discussions or adjustments to ensure our operations align with the Council's framework.

>

> We want to highlight that we currently maintain a very good relationship with our neighbors, and it is our utmost priority to continue fostering this positive connection. Our commitment to keeping noise levels at a minimum has been evident in our past operations, and we assure you that our extended hours will not compromise this established rapport.

>

> Thank you for your consideration, and we look forward to working collaboratively to find a solution that benefits both our establishment and the local community.

>

> Best regards,

> Carlos

> NOTICE - This email and any attachments are solely for the intended recipient and may be confidential. If you have received this email in error, please notify the sender and delete it from your system. Do not use, copy or disclose the information contained in this email or in any attachment without the permission of the sender. Metropolitan Police Service (MPS) communication systems are monitored to the extent permitted by law and any email and/or attachments may be read by monitoring staff. Only specified personnel are authorised to conclude binding agreements on behalf of the MPS by email and no responsibility is accepted for unauthorised agreements reached with other personnel. While reasonable precautions have been taken to ensure no viruses are present in this email, its security and that of any attachments cannot be guaranteed.

NOTICE - This email and any attachments are solely for the intended recipient and may be confidential. If you have received this email in error, please notify the sender and delete it from your system. Do not use, copy or disclose the information contained in this email or in any attachment without the permission of the sender. Metropolitan Police Service (MPS) communication systems are monitored to the extent permitted by law and any email and/or attachments may be read by monitoring staff. Only specified personnel are authorised to conclude binding agreements on behalf of the MPS by email and no responsibility is accepted for unauthorised agreements reached with other personnel. While reasonable precautions have been taken to ensure no viruses are present in this email, its security and that of any attachments cannot be guaranteed.

Appendix 9

**Section 182 Advice by the Home Office
Updated on August 2023**

Relevant, vexatious and frivolous representations

- 9.4 A representation is “relevant” if it relates to the likely effect of the grant of the licence on the promotion of at least one of the licensing objectives. For example, a representation from a local businessperson about the commercial damage caused by competition from new licensed premises would not be relevant. On the other hand, a representation by a businessperson that nuisance caused by new premises would deter customers from entering the local area, and the steps proposed by the applicant to prevent that nuisance were inadequate, would be relevant. In other words, representations should relate to the impact of licensable activities carried on from premises on the objectives. For representations in relation to variations to be relevant, they should be confined to the subject matter of the variation. There is no requirement for a responsible authority or other person to produce a recorded history of problems at premises to support their representations, and in fact this would not be possible for new premises.
- 9.5 It is for the licensing authority to determine whether a representation (other than a representation from responsible authority) is frivolous or vexatious on the basis of what might ordinarily be considered to be vexatious or frivolous. A representation may be considered to be vexatious if it appears to be intended to cause aggravation or annoyance, whether to a competitor or other person, without reasonable cause or justification. Vexatious circumstances may arise because of disputes between rival businesses and local knowledge will therefore be invaluable in considering such matters. Licensing authorities can consider the main effect of the representation, and whether any inconvenience or expense caused by it could reasonably be considered to be proportionate.
- 9.6 Frivolous representations would be essentially categorised by a lack of seriousness. Frivolous representations would concern issues which, at most, are minor and in relation to which no remedial steps would be warranted or proportionate.
- 9.7 Any person who is aggrieved by a rejection of their representations on either of these grounds may lodge a complaint through the local authority’s corporate complaints procedure. A person may also challenge the authority’s decision by way of judicial review.
- 9.8 Licensing authorities should not take decisions about whether representations are frivolous, vexatious or relevant to the licensing objectives on the basis of any political judgement. This may be difficult for councillors who receive complaints from residents within their own wards.

If consideration is not to be delegated, contrary to the recommendation in this Guidance, an assessment should be prepared by officials for consideration by the sub-committee before any decision is taken that necessitates a hearing. Any councillor who considers that their own interests are such that they are unable to consider the matter independently should disqualify themselves.

- 9.9 It is recommended that, in borderline cases, the benefit of the doubt about any aspect of a representation should be given to the person making that representation. The subsequent hearing would then provide an opportunity for the person or body making the representation to amplify and clarify it.
- 9.10 Licensing authorities should consider providing advice on their websites about how any person can make representations to them.

Appendix 10

Guidance Issued by the Home Office under Section 182 of the Licensing Act 2003

Updated December 2022

Crime and disorder

- 2.1 Licensing authorities should look to the police as the main source of advice on crime and disorder. They should also seek to involve the local Community Safety Partnership (CSP).
- 2.2 In the exercise of their functions, licensing authorities should seek to co-operate with the Security Industry Authority (“SIA”) as far as possible and consider adding relevant conditions to licences where appropriate. The SIA also plays an important role in preventing crime and disorder by ensuring that door supervisors are properly licensed and, in partnership with police and other agencies, that security companies are not being used as fronts for serious and organised criminal activity. This may include making specific enquiries or visiting premises through intelligence led operations in conjunction with the police, local authorities and other partner agencies. Similarly, the provision of requirements for door supervision may be appropriate to ensure that people who are drunk, drug dealers or people carrying firearms do not enter the premises and ensuring that the police are kept informed.
- 2.3 Conditions should be targeted on deterrence and preventing crime and disorder including the prevention of illegal working in licensed premises (see paragraph 10.10). For example, where there is good reason to suppose that disorder may take place, the presence of closed-circuit television (CCTV) cameras both inside and immediately outside the premises can actively deter disorder, nuisance, anti-social behaviour and crime generally. Some licence holders may wish to have cameras on their premises for the prevention of crime directed against the business itself, its staff, or its customers. But any condition may require a broader approach, and it may be appropriate to ensure that the precise location of cameras is set out on plans to ensure that certain areas are properly covered and there is no subsequent dispute over the terms of the condition.
- 2.4 The inclusion of radio links and ring-round phone systems should be considered an appropriate condition for public houses, bars and nightclubs operating in city and town centre leisure areas with a high density of licensed premises. These systems allow managers of licensed premises to communicate instantly with the police and facilitate a rapid response to any disorder which may be endangering the customers and staff on the premises.

- 2.5 Conditions relating to the management competency of designated premises supervisors should not normally be attached to premises licences. It will normally be the responsibility of the premises licence holder as an employer, and not the licensing authority, to ensure that the managers appointed at the premises are competent and appropriately trained. The designated premises supervisor is the key person who will usually be responsible for the day to day management of the premises by the premises licence holder, including the prevention of disorder. A condition of this kind may only be justified as appropriate in rare circumstances where it can be demonstrated that, in the circumstances associated with particular premises, poor management competency could give rise to issues of crime and disorder and public safety.
- 2.6 The prevention of crime includes the prevention of immigration crime including the prevention of illegal working in licensed premises. Licensing authorities should work with Home Office Immigration Enforcement, as well as the police, in respect of these matters. Licence conditions that are considered appropriate for the prevention of illegal working in licensed premises might include requiring a premises licence holder to undertake right to work checks on all staff employed at the licensed premises or requiring that evidence of a right to work check, either physical or digital (e.g. a copy of any document checked as part of a right to work check or a clear copy of the online right to work check) are retained at the licensed premises.

Appendix 11

Licensing Policy Section 9

Crime and Disorder

- 7.1 Licensed premises, especially those offering late night / early morning entertainment, alcohol and refreshment for large numbers of people, can be a source of crime and disorder problems and to store prescribed information.
- 7.2 When addressing crime and disorder the applicant should initially identify any particular issues (having regard to their particular type of premises and / or activities) which are likely to adversely affect the promotion of the crime and disorder licensing objective. The applicant should also list such steps that are required to deal with these identified issues. Both risks and mitigating steps should be included within the applications operating schedule. Where the Metropolitan Police, acting as a responsible authority, makes recommendations in respect of an application relating to the licensing objectives the Licensing Authority would expect the applicant to incorporate these into their operating schedule.
- 7.3 Applicants are recommended to seek advice from Council Officers and the Police as well as taking into account, as appropriate, local planning and transport policies, with tourism, cultural and crime prevention strategies, when preparing their plans and Schedules.
- 7.4 In addition to the requirements for the Licensing Authority to promote the licensing objectives, it also has duties under Section 17 of the Crime and Disorder Act 1998 to do all it reasonably can to prevent crime and disorder in the Borough and to share prescribed information.
- 7.5 The Licensing Authority, if its discretion is engaged, will consider attaching Conditions to licences and permissions to deter and prevent crime and disorder both inside and immediately outside the premises and these may include Conditions drawn from the Model Conditions in Appendix 3.
- 7.6 **CCTV** - The Licensing Authority, if its discretion is engaged, will attach conditions to licences, as appropriate where the conditions reflect local crime prevention strategies, for example the provision of closed circuit television cameras.
- 7.7 **Touting** – This is soliciting for custom. There has been a historic problem with Touting in the borough, mainly in relation to restaurants, and as such in 2006 the Council introduced a byelaw under Section 235 of the Local Government Act 1972 for the good rule and government of the London Borough of Tower Hamlets and for the prevention and suppression of nuisances.

As a result, in relation to premises where there is intelligence that touting is, or has been carried out, the Licensing Authority, where its discretion is engaged, will insert a conditions from our model conditions in appendix 3, to prohibit 'touting':-

7.8 **Responsible Drinking** - The Licensing Authority expects alcohol to be promoted in a responsible way in the Borough. This should incorporate relevant industry standards, such as the Portman Group Code of Practice. Where appropriate and proportionate, if its discretion is engaged, the Licensing Authority will apply conditions to ensure responsible drinking. The Licensing Authority also recognises the positive contribution to best practice that "Pubwatch" and other similar schemes can make in promoting the licensing objectives and is committed to working with them.

7.9 **Psychoactive Substances, e.g. Nitrous Oxide (NOx)** – Misuse of nitrous oxide is associated with increased antisocial behaviour including littering, noise nuisance and vandalism, all of which are detrimental to residents' quality of life and feelings of safety. Use of nitrous oxide is also a health concern and has other associated harms.

As a result, this Licensing Authority expects Licence Holders to refuse entry to any person seen use or selling NOx as a psychoactive Substance. Refusals should also be entered into Licence Holders refusals logs.

Where its discretion is engaged this Licensing Authority impose conditions to formally require refusal of persons seen selling or using NOx as a psychoactive Substance.

7.10 **Drinks spiking** – in reference to the Local Governments Association (LGA) Guidance note on drink spiking prevention, this Licensing Authority expects licence holders and applicants to have a zero-tolerance policy towards drinks spiking. This involves as a minimum ensuring all reports of spiking are acted upon and that all incidents of alleged spiking are recorded and reported to the police. Licence holders and applicants should also be aware of the Metropolitan Police's definition of drink spiking:

"Spiking is where someone adds drugs or alcohol to another person's drink without them knowing, it is illegal."

The LGA has set some recommendations for Licence holder, and we would expect our Licence holders to follow these where appropriate to their venues:

<https://www.local.gov.uk/publications/lga-guidance-note-drink-spiking-prevention#recommended-actions-for-licensed-premises->

Applicants for new and variations of exiting licences as well as those submitting TENs are expected to work with the Metropolitan Police in order to consider actions needed to prevent drinks spiking in their venues/events

Where its discretion is engaged this Licensing Authority will impose conditions on licences aimed at preventing drinks spiking, specifically any recommended by the metropolitan police.

7.11 **Welfare and Vulnerability** – This Licensing Authority believes that all Licensed venues should train their staff in Welfare and Vulnerability Engagement (WAVE). As of 2023 this Licensing Authority in partnership with the Metropolitan Police and the London Borough of Hackney is delivering monthly WAVE training sessions for Licensed venues within both Tower Hamlets and Hackney. As a result, we expect that all Licensed venues who sell alcohol for consumption on their premises should train their staff in WAVE and adopt Ask for Angela or similar initiatives aimed at assisting vulnerability within alcohol licensed venues.

7.12 **Sexual Harassment in the Night Time Economy** – sadly this is still an issues for women working in and visiting licensed venues in London. As a result, this Licensing Authority encourages Licensed venues to sign up to the Mayor of London’s Women’s Night Safety Charter:

<https://www.london.gov.uk/programmes-strategies/arts-and-culture/24-hour-london/womens-night-safety-charter>

As well as the Women’s Night Safety Charter we would encourage applicants and licence holders to discuss applications with the Council’s Violence Against Women and Girls Service, who can provide advice and training to venues on preventing misogyny within licensed premises.

Lastly, we expect Licence Holders to take a zero-tolerance approach to misogyny within their venues where this is towards customers or employees. We would expect licence holders to refuse to serve persons who commit acts of sexual harassment, even in the first instance, and report the matter to the Metropolitan Police.

7.13 **Party Boats** – An increasing number of complaints have been received in London Boroughs that boarder the River Thames in relation to “Party Boats”, which use the River. In respect of this we would encourage applicants for Party Boats to consider adopting the conditions listed in our Model Conditions in Appendix 3, where appropriate to promote the Licensing Objective of Prevention of Crime and Disorder. Furthermore, where its discretion is engaged, this Licensing Authority may add one or more of the boat conditions from our Model Conditions.

7.14 **Criminal Activity** - There is certain criminal activity that may arise in connection with licensed premises which the Licensing Authority will treat particularly seriously. These are the use of the licensed premises:

- for the sale and distribution of drugs controlled under the Misuse of Drugs Act 1971 and the laundering of the proceeds of drugs crime;
- for the sale and distribution of illegal firearms;
- for the evasion of copyright in respect of pirated or unlicensed films and music, which does considerable damage to the industries affected;
- for the illegal purchase and consumption of alcohol by minors which impacts on the health, educational attainment, employment prospects and propensity for crime of young people;

- for prostitution or the sale of unlawful pornography;
- by organised groups of paedophiles to groom children;
- as the base for the organisation of criminal activity, particularly by gangs;
- for the organisation of racist activity or the promotion of racist attacks;
- for employing a person who is disqualified from that work by reason of their immigration status in the UK;
- for unlawful gambling; and
- for the sale or storage of smuggled tobacco and alcohol.

The Secretary State's Guidance states that it is envisaged that licensing authorities, the police, the Home Office (Immigration Enforcement) and other law enforcement agencies, which are responsible authorities, will use the review procedures effectively to deter such activities and crime. Where reviews arise and this Licensing Authority determines that the crime prevention objective is being undermined through the premises being used to further crimes, it is expected that revocation of the licence, even in the first instance, should be seriously considered.

- 7.15 The Licensing Authority is mindful of the Secretary of State's Guidance "Reviews arising in connection with crime".
- 7.16 From 1 April 2017, businesses which sell alcohol (for example, retailers of alcohol and trade buyers) will need to ensure that the UK wholesalers that they buy alcohol from have been approved by HMRC under the Alcohol Wholesaler Registration Scheme (AWRS). They will need to check their wholesalers Unique Registration Number (URN) against the HMRC online database which will be available from April 2017. This is an ongoing obligation and if a business is found to have bought alcohol from an unapproved wholesaler, they may be liable to a penalty or could even face criminal prosecution and their alcohol stock may be seized. Any trader who buys alcohol from a wholesaler for onward sale to the general public (known as a 'trade buyer') does not need to register unless they sell alcohol to other businesses. Examples of trade buyers would be pubs, clubs, restaurants, cafes, retailers, and hotels. However, they will need to check that the wholesaler they purchase alcohol from is registered with HMRC. Further information may be found at: <https://www.gov.uk/guidance/the-alcohol-wholesaler-registration-scheme-awrs>.
- 7.17 **Smuggled Goods** – The Licensing Authority will exercise its discretion to add conditions to licence where appropriate and proportionate to reduce the risk of receiving smuggled goods and encourage traceability.
- 7.18 **Olympic Park (Football Ground)** – Premises where Police intelligence shows that football supporters congregate within the borough should consider adding the Olympic Park – Football Ground conditions in our Model Conditions in appendix 3.

Appendix 12

Guidance Issued by the Home Office under Section 182 of the Licensing Act 2003

Updated December 2022

Public nuisance

- 2.15 The 2003 Act enables licensing authorities and responsible authorities, through representations, to consider what constitutes public nuisance and what is appropriate to prevent it in terms of conditions attached to specific premises licences and club premises certificates. It is therefore important that in considering the promotion of this licensing objective, licensing authorities and responsible authorities focus on the effect of the licensable activities at the specific premises on persons living and working (including those carrying on business) in the area around the premises which may be disproportionate and unreasonable. The issues will mainly concern noise nuisance, light pollution, noxious smells and litter.
- 2.16 Public nuisance is given a statutory meaning in many pieces of legislation. It is however not narrowly defined in the 2003 Act and retains its broad common law meaning. It may include in appropriate circumstances the reduction of the living and working amenity and environment of other persons living and working in the area of the licensed premises. Public nuisance may also arise as a result of the adverse effects of artificial light, dust, odour and insects or where its effect is prejudicial to health.
- 2.17 Conditions relating to noise nuisance will usually concern steps appropriate to control the levels of noise emanating from premises. This might be achieved by a simple measure such as ensuring that doors and windows are kept closed after a particular time, or persons are not permitted in garden areas of the premises after a certain time. More sophisticated measures like the installation of acoustic curtains or rubber speaker mounts to mitigate sound escape from the premises may be appropriate. However, conditions in relation to live or recorded music may not be enforceable in circumstances where the entertainment activity itself is not licensable (see chapter 16). Any conditions appropriate to promote the prevention of public nuisance should be tailored to the type, nature and characteristics of the specific premises and its licensable activities. Licensing authorities should avoid inappropriate or disproportionate measures that could deter events that are valuable to the community, such as live music. Noise limiters, for example, are expensive to purchase and install and are likely to be a considerable burden for smaller venues.
- 2.18 As with all conditions, those relating to noise nuisance may not be appropriate in certain circumstances where provisions in other legislation adequately protect those living in the area of the premises. But as stated earlier in this Guidance, the approach of licensing authorities and responsible authorities should be one of prevention and when their powers are engaged, licensing authorities should be aware of the fact that other legislation may not adequately cover concerns raised in relevant representations and additional conditions may be appropriate.

- 2.19 Where applications have given rise to representations, any appropriate conditions should normally focus on the most sensitive period for people being disturbed by unreasonably loud music is at night and into the early morning when residents in adjacent properties may be attempting to go to sleep or are sleeping. This is why there is still a need for a licence for performances of live music between 11 pm and 8 am. In certain circumstances, conditions relating to noise emanating from the premises may also be appropriate to address any disturbance anticipated as customers enter and leave.
- 2.20 Measures to control light pollution will also require careful thought. Bright lighting outside premises which is considered appropriate to prevent crime and disorder may itself give rise to light pollution for some neighbours. Applicants, licensing authorities and responsible authorities will need to balance these issues.
- 2.21 Beyond the immediate area surrounding the premises, these are matters for the personal responsibility of individuals under the law. An individual who engages in anti-social behaviour is accountable in their own right. However, it would be perfectly reasonable for a licensing authority to impose a condition, following relevant representations, that requires the licence holder or club to place signs at the exits from the building encouraging patrons to be quiet until they leave the area, or that, if they wish to smoke, to do so at designated places on the premises instead of outside, and to respect the rights of people living nearby to a peaceful night.

Appendix 13

Licensing Policy Section 11

Prevention of Public Nuisance

- 11.1 Licensed premises, especially those operating late at night and in the early hours of the morning, can cause a range of nuisances impacting on people living, working or sleeping in the vicinity of the premises.
- 11.2 Like many London boroughs, Tower Hamlets has many areas of the borough where businesses and residents are “cheek by jowl” with each other. Thus, the correct balance needs to be adopted ensuring residents are not unduly disturbed by licensed premises, whilst ensuring this does not stifle growth in the licence trade.
- 11.3 Though all licensed premises must promote the licensing objectives, and thus actively try to prevent public nuisance being caused by their licensable activities, there are some factors that this Licensing Authority would expect to applicants to consider and where appropriate address in their operating schedule. These are:
- a) Music/performances
Measures to reduce impact of noise on residents
 - b) Queue management
Measure to prevent obstruct access to properties, pavements. Measure to reduce the impact of people noise on residents
 - c) Ingress and Egress
Measure to prevent people noise during ingress and egress
 - d) Use of outside areas (see 11.7 below)
 - e) Deliveries, particularly pick-ups by vehicles
Measures to prevent noise/fumes from engines, drivers (including smoking),
 - f) Bottle disposal
Done at reasonable time to prevent impact on residents e.g. between 8am and 8pm
 - g) Litter
Measures to prevent littering around the venue from patrons
- 11.4 The Licensing Authority appreciates that it would not be necessary or appropriate for all applications to have measures to prevent the above issues. Nevertheless, we will take a strong view on applications for licences that are in close proximity to residential premises, and whose intended use has a higher likelihood of causing public nuisance. This also includes those applications in areas covered by a Cumulative Impact Assessment (CIA). Especially where the applications falls outside the scope of any exceptions to such CIAs.
- 11.5 The Licensing Authority, where its discretion is engaged, will consider, where appropriate, attaching conditions to licences and permissions to prevent the

problems identified listed above, or any other conditions it considered appropriate and proportionate to promote the licensing condition of prevention of public nuisance.

- 11.6 **Street Furniture** – placing of street furniture, which includes advertising boards, on the highway can cause a public nuisance by way of obstruction or encourage consumption of alcohol on an unlicensed area. The Licensing Authority expects applicants to have ensured that they fully comply with the Councils rules relating to authorisation of obstructions on the highway, and that the required authorisations are obtained prior to submitting a licence application. Where proportionate and appropriate, and its discretion is engaged, the Licensing Authority will impose conditions in relation to street furniture, including on private land.
- 11.7 **Fly Posting** – The Council has experienced problems with "fly posting" in relation to venues that offer entertainment. Fly posting is the unauthorised posting of posters / advertisements etc. Where it considers it proportionate and appropriate, and its discretion is engaged, the Licensing Authority will attach conditions relating to the control of fly posting to ensure that venues clearly prohibit all fly posting in their contract terms with others and they effectively enforce this control.
- 11.8 **Beer Gardens and outside areas** – since the ending of the restrictions imposed during the Coronavirus pandemic, we have seen an increase the use of outside areas. This has also been encouraged by Government under the Business and Planning Act 2020. We want to strike the right balance between allowing businesses to thrive whilst still protecting residents of the borough being unduly disturbed by the night time economy. Hence, we would encourage applicants address this concern in their operating schedule by detailing what mitigating measures they intend adopt to reduce any disturbance the use of the outside area is likely to have on neighbouring residents. Such measures could include:
- limiting the amount of patrons permitted in the outside area, and/or,
 - restricting the use of areas after a certain time,
 - ceasing its use after a certain time.

Where disturbance of residents from outside areas is likely, and where its discretion is engaged, this Licensing Authority may add conditions limiting the numbers of person permitted to use any outside areas, and/or seek to cease the use of any outside areas after 21:00 hours.

- 11.9 **Party Boats** – An increasing number of complaints have been received in London Boroughs that boarder the River Thames in relation to "Party Boats", which use the River. In respect of this we would encourage applicants for Party Boats to consider adopting the "Boat" conditions, listed in our Model Conditions in Appendix 3, where appropriate to promote the Licensing Objective of Prevention of Public Nuisance. Furthermore, where disturbance of residence from these party boats is likely, and where its discretion is engaged, this Licensing Authority may add one or more of the boat conditions from our Model Conditions.

Appendix 14

Licensing Policy – Sections 20, 21 and Appendix 5

Special Cumulative Impact Policy for the Brick Lane and Bethnal Green Area

1. The Licensing Authority has adopted a special policy relating to cumulative impact in areas of:
 - Brick Lane
 - Bethnal Green

This special policy creates a rebuttable presumption that applications for the grant or variation of premises licences or club premises certificates which are likely to add to the existing cumulative impact will normally be refused following the receipt of representations, unless the applicant can demonstrate in the operation schedule that there will be no negative cumulative impacts with one or more of the licensing objectives.

2. The Council reviewed the Special Cumulative Impact Policy in 2021 and, following consultation, decided it was still of the opinion that the concentration of licensed premises within Brick Lane area was having a cumulative impact on the licensing objectives of crime and disorder and prevention of public nuisance. As part of the review in 2021, the Council also decided that the concentration of licensed premises within the Bethnal Green area was also having a cumulative impact on the licensing objectives of crime and disorder and prevention of public nuisance.

Review of Cumulative Impact Assessment - Supporting Evidence

3. In determining the Councils CIAs for the area of Brick Lane and Bethnal Green (Figures One and Two Below) the Council considered the following evidence:
 - Hot spot maps of incidents of crime and disorder and ASB linked to Licence premises in the defined areas for 2017 to 2020.
 - Complaint data from Environmental Health and Trading Standards relating to Noise and Licensing.
 - Licence Application data for the defined areas for 2017 to 2020
 - Results of the Consultation, that included Survey data and comments and written responses.

This evidence is published on our website:

<http://democracy.towerhamlets.gov.uk/ieListDocuments.aspx?CId=309&MId=12361>.

Cumulative Impact Assessments (Brick Lane and Bethnal Green)

4. The Licensing Authority is of the view that the number, type and density of premises selling/supplying alcohol for consumption on and off the premises and/or the provision of late night refreshment in the Brick Lane and Bethnal Green Areas (highlighted in Figures One and Two below) is having a cumulative impact on the licensing objectives. Therefore, it is likely that granting further licences would be inconsistent with the authority's duty to promote the licensing objectives. Thus, it has declared a cumulative impact assessment within these areas.
 5. The Brick Lane and Bethnal Green CIAs aim to manage the negative cumulative impact of the concentration of licensed premises in these areas and the stresses that the saturation of licensed premises has had on the local amenity, environmental degradation and emergency and regulatory services in managing this impact.
 6. The effect of this Special Cumulative Assessment Policy will apply to the following types of applications:
 - New Premises Licences applications,
 - New Club Premises Certificates applications
 - Provisional Statements,
 - Variation of Premises Licences and Club Premises Certificate applications (where the modifications are relevant to the issue of cumulative impact for example increases in hours or capacity).
- However, it will only apply where the application seeks to permit the Licensable activities of:
- the sale or supply of alcohol for consumption on or off the premises, and/or,
 - the provision of late night refreshment.
7. **This Policy will be strictly applied and where relevant representations are received and it is the view of the Council that the application will be refused. Applicants will need to demonstrate that there are exceptional circumstances and that granting their application will not negatively add to the cumulative effect on the Licensing Objectives within the Brick Lane and Bethnal Green CIAs if they wish to rebut this presumption.**
 8. The Special Cumulative Impact policy creates a rebuttable presumption that where relevant representations are received by one or more of the responsible authorities and/or other persons against applications (Councillors, Members of the Public) within the CIA zones the application will be refused.
 9. Where representations have been received in respect to applications within the CIA zones the onus is on the applicant to adequately rebut the presumption.

10. It must be stressed that the presumption created by this special policy does not relieve responsible authorities or other persons of the need to make a representation. If there are no representations, the licensing authority must grant the application in terms that are consistent with the operating schedule submitted in line with their delegated authority.

11. This special policy is not absolute and the Licensing Authority recognises that it has to balance the needs of businesses with local residents. The circumstances of each application will be considered on its merits and the Licensing Authority shall grant applications, when representations are not received. The applicant should demonstrate that the operation of the premises will not add to the cumulative impact on one or more of the following licensing objectives:
 - Prevention of Crime and Disorder;
 - Prevention of Public Nuisance.

Therefore, applicants will be expected to comprehensively demonstrate why a new or varied licence will not add to the cumulative impact. They are strongly advised to give consideration to mitigating potential cumulative impact issues when setting out steps they will take to promote the licensing objectives in their operating schedule.

12. The Special Cumulative Impact policy will not be used to revoke an existing licence or certificate and will not be applicable during the review of existing licences.

Possible exceptions to the Brick Lane and Bethnal Green Cumulative Impact Assessments

- Applications for licences for small premises with a capacity of fifty persons or less who only intend to operate within framework hours, and that;
 - Only have consumption of food (late night refreshment) and drink (alcohol) on the premises only;
 - Only provide Off sales of food (late night refreshment) and drink (alcohol) for delivery (i.e. not for take away); and,
 - Have arrangements to prevent vertical drinking, for example fully seated venues.

- Applications for licences that are not alcohol led (e.g. Hairdressers wanting to provide alcohol to clients during their hair cut/treatments), .
- Applications for licences where the applicant has recently surrendered a licence for another premises of a similar size and providing similar licensable activities in the same CIA Area.

Licensing Authority will **not** consider the following as possible exceptions:

- that the premises will be well managed and run,
- that the premises will be constructed to a high standard,
- that the applicant operates similar premises elsewhere without complaint.

The Cumulative Impact Assessment Areas for the Brick Lane and Bethnal Green

13. The Cumulative Impact Assessment Areas are detailed in the maps below.

Figure One

Brick Lane area:

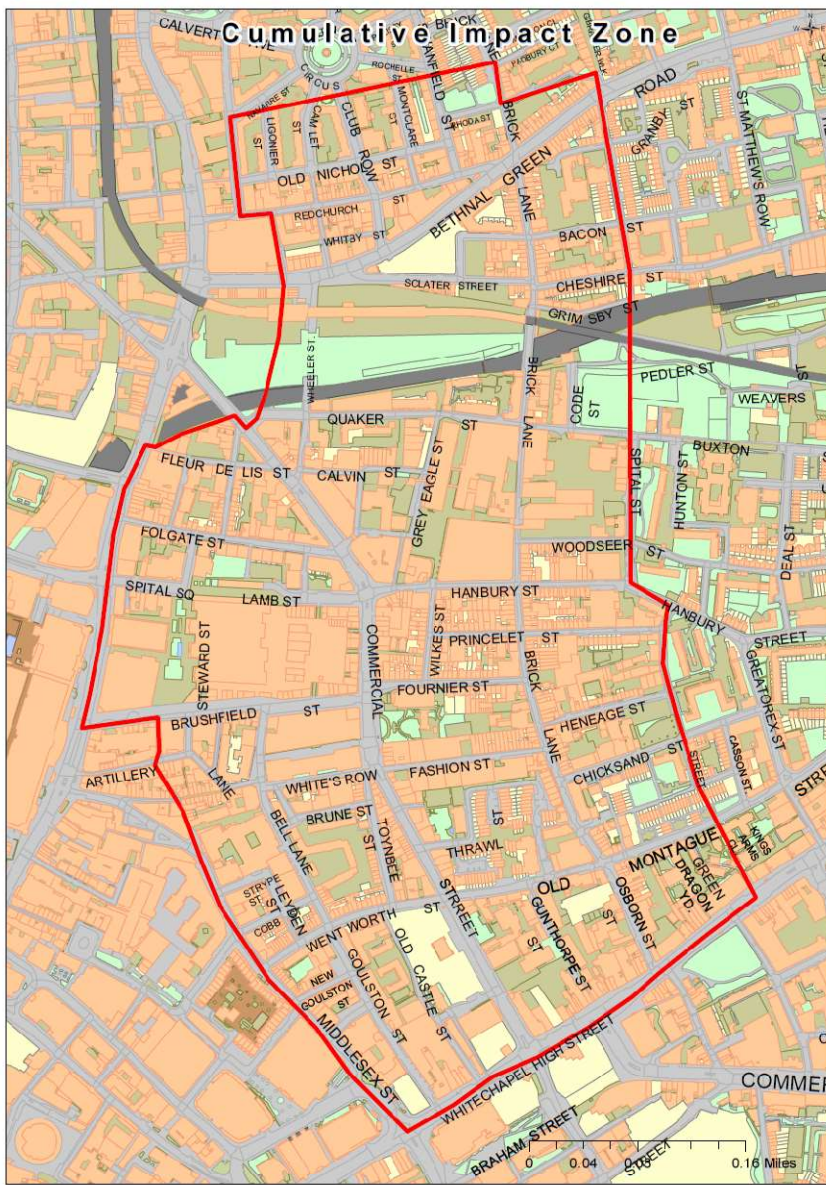
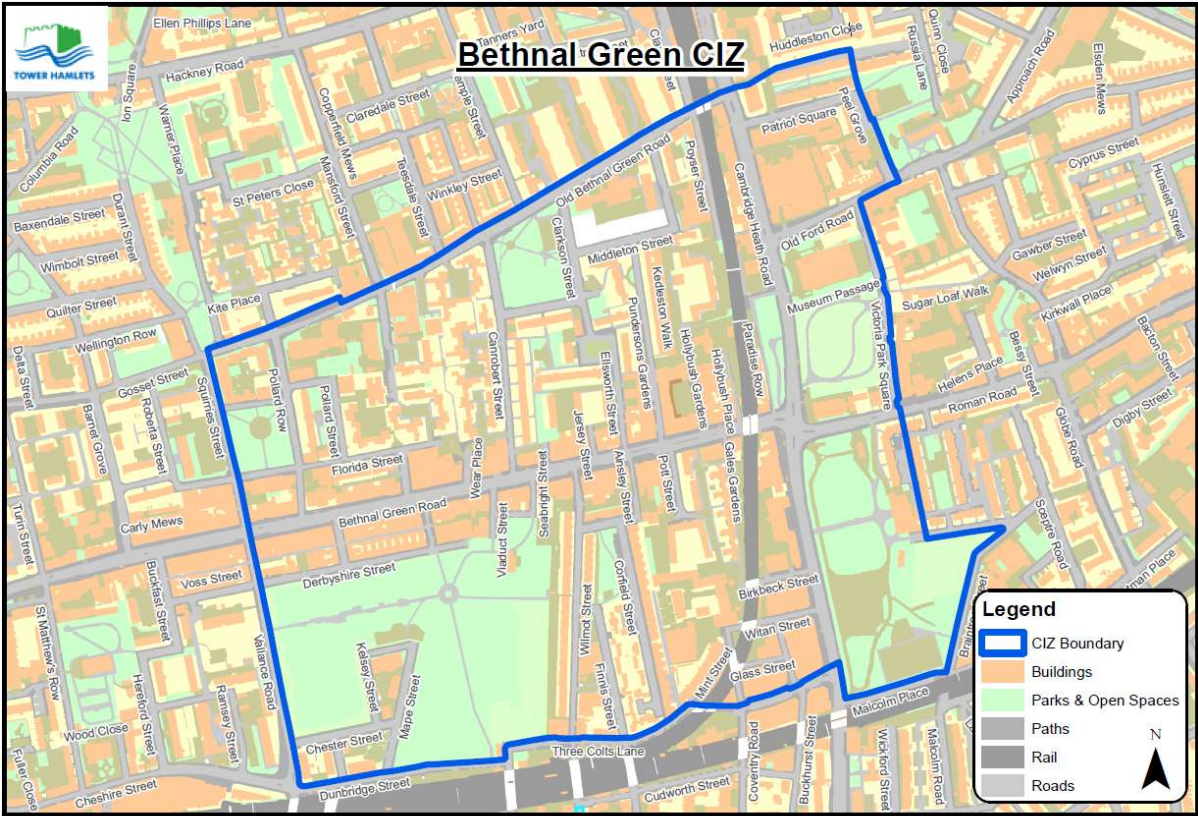

Figure Two:

Bethnal Green Area



Appendix 15

Licensing Policy Relating to Hours of Trading

All applications have to be considered on their own merits.

The Council has however adopted a set of framework hours as follows:

- Monday to Thursday, from 06:00 hrs to 23:30 hrs
- Friday and Saturday, from 06:00 hrs to 00:00 hrs (midnight)
- Sunday, from 06:00 hrs to 22:30 hrs

(see 16.8 of the Licensing Policy)

In considering the applicability of framework hours to any particular application regard should be had to the following

- Location
- Proposed hours of regulated activities, and the proposed hours the premises are open to the public
- The adequacy of the applicant's proposals to deal with issues of crime and disorder and public nuisance
- Previous history
- Access to public transport
- Proximity to other licensed premises, and their hours

(See 16.9 of the Licensing Policy)

Subject to any representations to the contrary in individual cases the following premises are not generally considered to contribute to late night anti-social behaviour and will therefore generally have greater freedom

- Theatres
- Cinemas
- Premises with club premises certificates

Appendix 16

Planning

An application for a Premises Licence can be made in respect of a premises even where the premises does not have relevant Planning Permission. That application has to be considered and Members can only refuse the application where the application itself does not promote one of more of the Licensing Objectives. Members cannot refuse just because there is no planning permission. Where a Premises Licence is granted and which exceeds what is allowed by the Planning Permission and that Premises then operates in breach of planning then the operator would be liable to enforcement by Planning.