

Appendix 1



* required information

Section 1 of 21

You can save the form at any time and resume it later. You do not need to be logged in when you resume.

System reference

Not Currently In Use

This is the unique reference for this application generated by the system.

Your reference

AGS/26508/2106

You can put what you want here to help you track applications if you make lots of them. It is passed to the authority.

Are you an agent acting on behalf of the applicant?

Yes No

Put "no" if you are applying on your own behalf or on behalf of a business you own or work for.

Applicant Details

* First name

Sainsbury's Supermarkets Ltd

* Family name

Sainsbury's Supermarkets Ltd

* E-mail

[REDACTED]

Main telephone number

Include country code.

Other telephone number

Indicate here if the applicant would prefer not to be contacted by telephone

Is the applicant:

Applying as a business or organisation, including as a sole trader
 Applying as an individual

A sole trader is a business owned by one person without any special legal structure. Applying as an individual means the applicant is applying so the applicant can be employed, or for some other personal reason, such as following a hobby.

Applicant Business

Is the applicant's business registered in the UK with Companies House?

Yes No

Note: completing the Applicant Business section is optional in this form.

Registration number

03261722

Business name

Sainsbury's Supermarkets Ltd

If the applicant's business is registered, use its registered name.

VAT number

-

NA

Put "none" if the applicant is not registered for VAT.

Legal status

Private Limited Company

Continued from previous page...

Applicant's position in the business

Home country

The country where the applicant's headquarters are.

Registered Address

Address registered with Companies House.

Building number or name

Street

District

City or town

County or administrative area

Postcode

Country

Agent Details

* First name

* Family name

* E-mail

Main telephone number

Include country code.

Other telephone number

Indicate here if you would prefer not to be contacted by telephone

Are you:

- An agent that is a business or organisation, including a sole trader
- A private individual acting as an agent

A sole trader is a business owned by one person without any special legal structure.

Agent Business

Is your business registered in the UK with Companies House? Yes No

Note: completing the Applicant Business section is optional in this form.

Registration number

Business name

If your business is registered, use its registered name.

VAT number

Put "none" if you are not registered for VAT.

Legal status

Continued from previous page...

Your position in the business

Home country

The country where the headquarters of your business is located.

Agent Registered Address

Address registered with Companies House.

Building number or name

Street

District

City or town

County or administrative area

Postcode

Country

Section 2 of 21

PREMISES DETAILS

I/we, as named in section 1, apply for a premises licence under section 17 of the Licensing Act 2003 for the premises described in section 2 below (the premises) and I/we are making this application to you as the relevant licensing authority in accordance with section 12 of the Licensing Act 2003.

Premises Address

Are you able to provide a postal address, OS map reference or description of the premises?

- Address OS map reference Description

Postal Address Of Premises

Building number or name

Street

District

City or town

County or administrative area

Postcode

Country

Further Details

Telephone number

Non-domestic rateable value of premises (£)

Section 3 of 21

APPLICATION DETAILS

In what capacity are you applying for the premises licence?

- An individual or individuals
- A limited company / limited liability partnership
- A partnership (other than limited liability)
- An unincorporated association
- Other (for example a statutory corporation)
- A recognised club
- A charity
- The proprietor of an educational establishment
- A health service body
- A person who is registered under part 2 of the Care Standards Act 2000 (c14) in respect of an independent hospital in Wales
- A person who is registered under Chapter 2 of Part 1 of the Health and Social Care Act 2008 in respect of the carrying on of a regulated activity (within the meaning of that Part) in an independent hospital in England
- The chief officer of police of a police force in England and Wales

Confirm The Following

- I am carrying on or proposing to carry on a business which involves the use of the premises for licensable activities
- I am making the application pursuant to a statutory function
- I am making the application pursuant to a function discharged by virtue of Her Majesty's prerogative

Section 4 of 21

NON INDIVIDUAL APPLICANTS

Provide name and registered address of applicant in full. Where appropriate give any registered number. In the case of a partnership or other joint venture (other than a body corporate), give the name and address of each party concerned.

Non Individual Applicant's Name

Name

Details

Registered number (where applicable)

Description of applicant (for example partnership, company, unincorporated association etc)

Continued from previous page...

Company

Address

Building number or name

Street

District

City or town

County or administrative area

Postcode

Country

Contact Details

E-mail

Telephone number

Other telephone number

* Date of birth / /

* Nationality

[Documents that demonstrate entitlement to work in the UK](#)

Add another applicant

Section 5 of 21

OPERATING SCHEDULE

When do you want the premises licence to start? / /
dd mm yyyy

If you wish the licence to be valid only for a limited period, when do you want it to end / /
dd mm yyyy

Provide a general description of the premises

For example the type of premises, its general situation and layout and any other information which could be relevant to the licensing objectives. Where your application includes off-supplies of alcohol and you intend to provide a place for consumption of these off- supplies you must include a description of where the place will be and its proximity to the premises.

A convenience store located at 70 Wapping Lane, Tower Hamlets, E1W 2RD.

Continued from previous page...

If 5,000 or more people are expected to attend the premises at any one time, state the number expected to attend

Section 6 of 21

PROVISION OF PLAYS

[See guidance on regulated entertainment](#)

Will you be providing plays?

- Yes No

Section 7 of 21

PROVISION OF FILMS

[See guidance on regulated entertainment](#)

Will you be providing films?

- Yes No

Section 8 of 21

PROVISION OF INDOOR SPORTING EVENTS

[See guidance on regulated entertainment](#)

Will you be providing indoor sporting events?

- Yes No

Section 9 of 21

PROVISION OF BOXING OR WRESTLING ENTERTAINMENTS

[See guidance on regulated entertainment](#)

Will you be providing boxing or wrestling entertainments?

- Yes No

Section 10 of 21

PROVISION OF LIVE MUSIC

[See guidance on regulated entertainment](#)

Will you be providing live music?

- Yes No

Section 11 of 21

PROVISION OF RECORDED MUSIC

[See guidance on regulated entertainment](#)

Will you be providing recorded music?

- Yes No

Section 12 of 21

PROVISION OF PERFORMANCES OF DANCE

[See guidance on regulated entertainment](#)

Will you be providing performances of dance?

Continued from previous page...

Section 13 of 21

PROVISION OF ANYTHING OF A SIMILAR DESCRIPTION TO LIVE MUSIC, RECORDED MUSIC OR PERFORMANCES OF DANCE

[See guidance on regulated entertainment](#)

Will you be providing anything similar to live music, recorded music or performances of dance?

- Yes No

Section 14 of 21

LATE NIGHT REFRESHMENT

Will you be providing late night refreshment?

- Yes No

Section 15 of 21

SUPPLY OF ALCOHOL

Will you be selling or supplying alcohol?

- Yes No

Standard Days And Timings

MONDAY

Start

End

Start

End

Give timings in 24 hour clock.
(e.g., 16:00) and only give details for the days
of the week when you intend the premises
to be used for the activity.

TUESDAY

Start

End

Start

End

WEDNESDAY

Start

End

Start

End

THURSDAY

Start

End

Start

End

FRIDAY

Start

End

Start

End

SATURDAY

Start

End

Start

End

Continued from previous page...

SUNDAY

Start

End

Start

End

Will the sale of alcohol be for consumption:

- On the premises Off the premises Both

If the sale of alcohol is for consumption on the premises select on, if the sale of alcohol is for consumption away from the premises select off. If the sale of alcohol is for consumption on the premises and away from the premises select both.

State any seasonal variations

For example (but not exclusively) where the activity will occur on additional days during the summer months.

Non-standard timings. Where the premises will be used for the supply of alcohol at different times from those listed in the column on the left, list below

For example (but not exclusively), where you wish the activity to go on longer on a particular day e.g. Christmas Eve.

State the name and details of the individual whom you wish to specify on the licence as premises supervisor

Name

First name

Family name

Date of birth / /
dd mm yyyy

Continued from previous page...

Enter the contact's address

Building number or name	<input type="text"/>
Street	<input type="text"/>
District	<input type="text"/>
City or town	<input type="text"/>
County or administrative area	<input type="text"/>
Postcode	<input type="text"/>
Country	<input type="text" value="United Kingdom"/>
Personal Licence number (if known)	<input type="text"/>
Issuing licensing authority (if known)	<input type="text"/>

PROPOSED DESIGNATED PREMISES SUPERVISOR CONSENT

How will the consent form of the proposed designated premises supervisor be supplied to the authority?

- Electronically, by the proposed designated premises supervisor
- As an attachment to this application

Reference number for consent form (if known)

If the consent form is already submitted, ask the proposed designated premises supervisor for its 'system reference' or 'your reference'.

Section 16 of 21

ADULT ENTERTAINMENT

Highlight any adult entertainment or services, activities, or other entertainment or matters ancillary to the use of the premises that may give rise to concern in respect of children

Give information about anything intended to occur at the premises or ancillary to the use of the premises which may give rise to concern in respect of children, regardless of whether you intend children to have access to the premises, for example (but not exclusively) nudity or semi-nudity, films for restricted age groups etc gambling machines etc.

NA

Section 17 of 21

HOURS PREMISES ARE OPEN TO THE PUBLIC

Standard Days And Timings

MONDAY

Start

End

Start

End

Give timings in 24 hour clock. (e.g., 16:00) and only give details for the days of the week when you intend the premises to be used for the activity.

Continued from previous page...

TUESDAY

Start	<input type="text" value="00:00"/>	End	<input type="text" value="24:00"/>
Start	<input type="text"/>	End	<input type="text"/>

WEDNESDAY

Start	<input type="text" value="00:00"/>	End	<input type="text" value="24:00"/>
Start	<input type="text"/>	End	<input type="text"/>

THURSDAY

Start	<input type="text" value="00:00"/>	End	<input type="text" value="24:00"/>
Start	<input type="text"/>	End	<input type="text"/>

FRIDAY

Start	<input type="text" value="00:00"/>	End	<input type="text" value="24:00"/>
Start	<input type="text"/>	End	<input type="text"/>

SATURDAY

Start	<input type="text" value="00:00"/>	End	<input type="text" value="24:00"/>
Start	<input type="text"/>	End	<input type="text"/>

SUNDAY

Start	<input type="text" value="00:00"/>	End	<input type="text" value="24:00"/>
Start	<input type="text"/>	End	<input type="text"/>

State any seasonal variations

For example (but not exclusively) where the activity will occur on additional days during the summer months.

The opening hours of the store are not a licensable activity and the applicant asks that the hours not be restricted by the premises licence.

Non standard timings. Where you intend to use the premises to be open to the members and guests at different times from those listed in the column on the left, list below

For example (but not exclusively), where you wish the activity to go on longer on a particular day e.g. Christmas Eve.

Section 18 of 21

LICENSING OBJECTIVES

Describe the steps you intend to take to promote the four licensing objectives:

a) General – all four licensing objectives (b,c,d,e)

Continued from previous page...

List here steps you will take to promote all four licensing objectives together.

b) The prevention of crime and disorder

1. The licence holder will ensure that the premises benefit from a CCTV system that operates at all times when licensable activities are taking place.
2. The system will incorporate a camera covering each of the entrance doors and the main alcohol display area and will be capable of providing an image which is regarded as identification standard. The precise positions of the cameras may be agreed, subject to compliance with Data Protection legislation, with the police from time to time.
3. The system will incorporate a recording facility and any recording will be retained and stored in a suitable and secure manner for a minimum of 30 days and will be made available, subject to compliance with Data Protection legislation, to the police for inspection on request.
4. The system must be able to export recorded images to a removable means e.g. CD/DVD and have its own software enabled to allow playback/review.
5. A member of staff trained in the use of the CCTV system must be available at the premises at all times that the premises are open to the public.
6. The system will display, on any recording, the correct time and date of the recording.

c) Public safety

The applicant will at all times maintain adequate levels of staff and security. Such staff and security levels will be disclosed, on request, to the licensing authority and police.

d) The prevention of public nuisance

Signage will be displayed at the exit of the premises requesting customers leaving the premises late at night to do so quietly and with consideration so as not to disturb nearby residents.

e) The protection of children from harm

The premises licence holder will ensure that an age verification policy will apply to the premises whereby all cashiers will be trained to ask any customer attempting to purchase alcohol, who appears to be under the age of 25 years (or older if the licence holder so elects) to produce, before being sold alcohol, identification being a passport or photocard driving licence bearing a holographic mark or other form or method of identification that complies with any mandatory condition that may apply to this licence.

Section 19 of 21

NOTES ON DEMONSTRATING ENTITLEMENT TO WORK IN THE UK

Continued from previous page...

Entitlement to work/immigration status for individual applicants and applications from partnerships which are not limited liability partnerships:

A licence may not be held by an individual or an individual in a partnership who is resident in the UK who:

- does not have the right to live and work in the UK; or
- is subject to a condition preventing him or her from doing work relating to the carrying on of a licensable activity.

Any premises licence issued in respect of an application made on or after 6 April 2017 will become invalid if the holder ceases to be entitled to work in the UK.

Applicants must demonstrate that they have an entitlement to work in the UK and are not subject to a condition preventing them from doing work relating to the carrying on of a licensable activity. They do this in one of two ways: 1) by providing with this application copies or scanned copies of the documents listed below (which do not need to be certified), or 2) by providing their 'share code' to enable the licensing authority to carry out a check using the Home Office online right to work checking service (see below).

Documents which demonstrate entitlement to work in the UK

- An expired or current passport showing the holder, or a person named in the passport as the child of the holder, is a British citizen or a citizen of the UK and Colonies having the right of abode in the UK [please see note below about which sections of the passport to copy].
- An expired or current passport or national identity card showing the holder, or a person named in the passport as the child of the holder, is a national of a European Economic Area country or Switzerland.
- A Registration Certificate or document certifying permanent residence issued by the Home Office to a national of a European Economic Area country or Switzerland.
- A Permanent Residence Card issued by the Home Office to the family member of a national of a European Economic Area country or Switzerland.
- A **current** Biometric Immigration Document (Biometric Residence Permit) issued by the Home Office to the holder indicating that the person named is allowed to stay indefinitely in the UK, or has no time limit on their stay in the UK.
- A **current** passport endorsed to show that the holder is exempt from immigration control, is allowed to stay indefinitely in the UK, has the right of abode in the UK, or has no time limit on their stay in the UK.
- A **current** Immigration Status Document issued by the Home Office to the holder with an endorsement indicating that the named person is allowed to stay indefinitely in the UK or has no time limit on their stay in the UK, **when produced in combination with** an official document giving the person's permanent National Insurance number and their name issued by a Government agency or a previous employer.
- A birth or adoption certificate issued in the UK, **when produced in combination with** an official document giving the person's permanent National Insurance number and their name issued by a Government agency or a previous employer.
- A birth or adoption certificate issued in the Channel Islands, the Isle of Man or Ireland **when produced in combination with** an official document giving the person's permanent National Insurance number and their name issued by a Government agency or a previous employer.
- A certificate of registration or naturalisation as a British citizen, **when produced in combination with** an official document giving the person's permanent National Insurance number and their name issued by a Government agency or a previous employer.

Continued from previous page...

- A **current** passport endorsed to show that the holder is allowed to stay in the UK and is currently allowed to work and is not subject to a condition preventing the holder from doing work relating to the carrying on of a licensable activity.
- A **current** Biometric Immigration Document (Biometric Residence Permit) issued by the Home Office to the holder which indicates that the named person can currently stay in the UK and is allowed to work relation to the carrying on of a licensable activity.
- A **current** Residence Card issued by the Home Office to a person who is not a national of a European Economic Area state or Switzerland but who is a family member of such a national or who has derivative rights or residence.
- A **current** Immigration Status Document containing a photograph issued by the Home Office to the holder with an endorsement indicating that the named person may stay in the UK, and is allowed to work and is not subject to a condition preventing the holder from doing work relating to the carrying on of a licensable activity **when produced in combination with** an official document giving the person's permanent National Insurance number and their name issued by a Government agency or a previous employer.
- A Certificate of Application, **less than 6 months old**, issued by the Home Office under regulation 18(3) or 20(2) of the Immigration (European Economic Area) Regulations 2016, to a person who is not a national of a European Economic Area state or Switzerland but who is a family member of such a national or who has derivative rights of residence.
- Reasonable evidence that the person has an outstanding application to vary their permission to be in the UK with the Home Office such as the Home Office acknowledgement letter or proof of postage evidence, or reasonable evidence that the person has an appeal or administrative review pending on an immigration decision, such as an appeal or administrative review reference number.
- Reasonable evidence that a person who is not a national of a European Economic Area state or Switzerland but who is a family member of such a national or who has derivative rights of residence in exercising treaty rights in the UK including:-
 - evidence of the applicant's own identity – such as a passport,
 - evidence of their relationship with the European Economic Area family member – e.g. a marriage certificate, civil partnership certificate or birth certificate, and
 - evidence that the European Economic Area national has a right of permanent residence in the UK or is one of the following if they have been in the UK for more than 3 months:
 - (i) working e.g. employment contract, wage slips, letter from the employer,
 - (ii) self-employed e.g. contracts, invoices, or audited accounts with a bank,
 - (iii) studying e.g. letter from the school, college or university and evidence of sufficient funds; or
 - (iv) self-sufficient e.g. bank statements.

Family members of European Economic Area nationals who are studying or financially independent must also provide evidence that the European Economic Area national and any family members hold comprehensive sickness insurance in the UK. This can include a private medical insurance policy, an EHIC card or an S1, S2 or S3 form.

Original documents must not be sent to licensing authorities. If the document copied is a passport, a copy of the following pages should be provided:-

- (i) any page containing the holder's personal details including nationality;
- (ii) any page containing the holder's photograph;
- (iii) any page containing the holder's signature;
- (iv) any page containing the date of expiry; and
- (v) any page containing information indicating the holder has permission to enter or remain in the UK and is permitted to work.

Continued from previous page...

If the document is not a passport, a copy of the whole document should be provided.

Your right to work will be checked as part of your licensing application and this could involve us checking your immigration status with the Home Office. We may otherwise share information with the Home Office. Your licence application will not be determined until you have complied with this guidance.

Home Office online right to work checking service

As an alternative to providing a copy of the documents listed above, applicants may demonstrate their right to work by allowing the licensing authority to carry out a check with the Home Office online right to work checking service.

To demonstrate their right to work via the Home Office online right to work checking service, applicants should include in this application their 9-digit share code (provided to them upon accessing the service at <https://www.gov.uk/prove-right-to-work>) which, along with the applicant's date of birth (provided within this application), will allow the licensing authority to carry out the check.

In order to establish the applicant's right to work, the check will need to indicate that the applicant is allowed to work in the United Kingdom and is not subject to a condition preventing them from doing work relating to the carrying on of a licensable activity.

An online check will not be possible in all circumstances because not all applicants will have an immigration status that can be checked online. The Home Office online right to work checking service sets out what information and/or documentation applicants will need in order to access the service. Applicants who are unable to obtain a share code from the service should submit copy documents as set out above.

Section 20 of 21

NOTES ON REGULATED ENTERTAINMENT

Continued from previous page...

In terms of specific **regulated entertainments** please note that:

- Plays: no licence is required for performances between 08:00 and 23.00 on any day, provided that the audience does not exceed 500.
- Films: no licence is required for 'not-for-profit' film exhibition held in community premises between 08.00 and 23.00 on any day provided that the audience does not exceed 500 and the organiser (a) gets consent to the screening from a person who is responsible for the premises; and (b) ensures that each such screening abides by age classification ratings.
- Indoor sporting events: no licence is required for performances between 08.00 and 23.00 on any day, provided that the audience does not exceed 1000.
- Boxing or Wrestling Entertainment: no licence is required for a contest, exhibition or display of Greco-Roman wrestling, or freestyle wrestling between 08.00 and 23.00 on any day, provided that the audience does not exceed 1000. Combined fighting sports – defined as a contest, exhibition or display which combines boxing or wrestling with one or more martial arts – are licensable as a boxing or wrestling entertainment rather than an indoor sporting event.
- Live music: no licence permission is required for:
 - o a performance of unamplified live music between 08.00 and 23.00 on any day, on any premises.
 - o a performance of amplified live music between 08.00 and 23.00 on any day on premises authorised to sell alcohol for consumption on those premises, provided that the audience does not exceed 500.
 - o a performance of amplified live music between 08.00 and 23.00 on any day, in a workplace that is not licensed to sell alcohol on those premises, provided that the audience does not exceed 500.
 - o a performance of amplified live music between 08.00 and 23.00 on any day, in a church hall, village hall, community hall, or other similar community premises, that is not licensed by a premises licence to sell alcohol, provided that (a) the audience does not exceed 500, and (b) the organiser gets consent for the performance from a person who is responsible for the premises.
 - o a performance of amplified live music between 08.00 and 23.00 on any day, at the non-residential premises of (i) a local authority, or (ii) a school, or (iii) a hospital, provided that (a) the audience does not exceed 500, and (b) the organiser gets consent for the performance on the relevant premises from: (i) the local authority concerned, or (ii) the school or (iii) the health care provider for the hospital.
- Recorded Music: no licence permission is required for:
 - o any playing of recorded music between 08.00 and 23.00 on any day on premises authorised to sell alcohol for consumption on those premises, provided that the audience does not exceed 500.
 - o any playing of recorded music between 08.00 and 23.00 on any day, in a church hall, village hall, community hall, or other similar community premises, that is not licensed by a premises licence to sell alcohol, provided that (a) the audience does not exceed 500, and (b) the organiser gets consent for the performance from a person who is responsible for the premises.
 - o any playing of recorded music between 08.00 and 23.00 on any day, at the non-residential premises of (i) a local authority, or (ii) a school, or (iii) a hospital, provided that (a) the audience does not exceed 500, and (b) the organiser gets consent for the performance on the relevant premises from: (i) the local authority concerned, or (ii) the school proprietor or (iii) the health care provider for the hospital.

Continued from previous page...

- Dance: no licence is required for performances between 08.00 and 23.00 on any day, provided that the audience does not exceed 500. However, a performance which amounts to adult entertainment remains licensable.
- Cross activity exemptions: no licence is required between 08.00 and 23.00 on any day, with no limit on audience size for:
 - o any entertainment taking place on the premises of the local authority where the entertainment is provided by or on behalf of the local authority;
 - o any entertainment taking place on the hospital premises of the health care provider where the entertainment is provided by or on behalf of the health care provider;
 - o any entertainment taking place on the premises of the school where the entertainment is provided by or on behalf of the school proprietor; and
 - o any entertainment (excluding films and a boxing or wrestling entertainment) taking place at a travelling circus, provided that (a) it takes place within a moveable structure that accommodates the audience, and (b) that the travelling circus has not been located on the same site for more than 28 consecutive days.

Section 21 of 21

PAYMENT DETAILS

This fee must be paid to the authority. If you complete the application online, you must pay it by debit or credit card.

Premises Licence Fees are determined by the non domestic rateable value of the premises.

To find out a premises non domestic rateable value go to the Valuation Office Agency site at http://www.voa.gov.uk/business_rates/index.htm

Band A - No RV to £4,300 = £100.00

Band B - £4,301 to £33,000 = £190.00

Band C - £33,001 to £8700 = 315.00

Band D - £87001 to £12500 = £450.00*

Band E - £125001 and over = 635.00*

*If the premises rateable value is in Bands D or E and the premises is primarily used for the consumption of alcohol on the premises then your are required to pay a higher fee

Band D - £7001 to £12500 = £900.00

Band E - £125001 and over £1,905.00

There is an exemption from the payment of fees in relation to the provision of regulated entertainment at church halls, chapel halls or premises of a similar nature, village halls, parish or community halls, or other premises of a similar nature. The costs associated with these licences will be met by central Government. If, however, the licence also authorises the use of the premises for the supply of alcohol or the provision of late night refreshment, a fee will be required.

Schools and sixth form colleges are exempt from the fees associated with the authorisation of regulated entertainment only where the entertainment is provided by and at the school or college and for the purposes of the school or college.

If you operate a large event you are subject to ADDITIONAL fees based upon the number in attendance at any one time

Capacity 5000-9999 = £1,000.00

Capacity 10000 -14999 = £2,000.00

Capacity 15000-19999 = £4,000.00

Capacity 20000-29999 = £8,000.00

Capacity 30000-39000 = £16,000.00

Capacity 40000-49999 = £24,000.00

Capacity 50000-59999 = £32,000.00

Capacity 60000-69999 = £40,000.00

Capacity 70000-79999 = £48,000.00

Capacity 80000-89999 = £56,000.00

Capacity 90000 and over = £64,000.00

NOTE: From 1st January 2018 Licences if you are granted a Licence to permit the sale/supply of alcohol between midnight and 6am (00:00 and 06:00 hours) on any day you will be liable to pay the Late Night Levy charge. The charge must be paid 14 days after the grant of your Licence, unless you fall within one of the exemption categories. Non-payment of the levy can result in suspension of your licence, as per sections 55A and 92A of the Licensing Act 2003, as amended and section 229(6) of the Police and Social Responsibility Act 2011. For more information below visit <https://www.towerhamlets.gov.uk/latenightlevy>

Continued from previous page...

* Fee amount (£)

315.00

ATTACHMENTS

AUTHORITY POSTAL ADDRESS

Address

Building number or name

Street

District

City or town

County or administrative area

Postcode

Country

United Kingdom

DECLARATION

* I/we understand it is an offence, liable on conviction to a fine up to level 5 on the standard scale, under section 158 of the licensing act 2003, to make a false statement in or in connection with this application.

[APPLICABLE TO INDIVIDUAL APPLICANTS ONLY, INCLUDING THOSE IN A PARTNERSHIP WHICH IS NOT A LIMITED LIABILITY PARTNERSHIP] I UNDERSTAND I AM NOT ENTITLED TO BE ISSUED WITH A LICENCE IF I DO NOT HAVE THE ENTITLEMENT TO LIVE AND WORK IN THE UK (OR IF I AM SUBJECT TO A CONDITION PREVENTING ME FROM DOING WORK RELATING TO THE CARRYING ON OF A LICENSABLE ACTIVITY) AND THAT MY LICENCE WILL BECOME INVALID IF I CEASE TO BE ENTITLED TO LIVE AND WORK IN THE UK (PLEASE READ GUIDANCE NOTE 15). THE DPS NAMED IN THIS APPLICATION FORM IS ENTITLED TO WORK IN THE UK (AND IS NOT SUBJECT TO CONDITIONS PREVENTING HIM OR HER FROM DOING WORK RELATING TO A LICENSABLE ACTIVITY) AND I HAVE SEEN A COPY OF HIS OR HER PROOF OF ENTITLEMENT TO WORK, IF APPROPRIATE (PLEASE SEE NOTE 15).

Ticking this box indicates you have read and understood the above declaration

This section should be completed by the applicant, unless you answered "Yes" to the question "Are you an agent acting on behalf of the applicant?"

* Full name

* Capacity

Date (dd/mm/yyyy)

Add another signatory

Once you're finished you need to do the following:

1. Save this form to your computer by clicking file/save as...
2. Go back to <https://www.gov.uk/apply-for-a-licence/premises-licence/tower-hamlets/apply-1> to upload this file and continue with your application.

Don't forget to make sure you have all your supporting documentation to hand.

Continued from previous page...

IT IS AN OFFENCE LIABLE TO SUMMARY CONVICTION TO A FINE OF ANY AMOUNT UNDER SECTION 158 OF THE LICENSING ACT 2003, TO MAKE A FALSE STATEMENT IN OR IN CONNECTION WITH THIS APPLICATION

IT IS AN OFFENCE UNDER SECTION 24B OF THE IMMIGRATION ACT 1971 FOR A PERSON TO WORK WHEN THEY KNOW, OR HAVE REASONABLE CAUSE TO BELIEVE, THAT THEY ARE DISQUALIFIED FROM DOING SO BY REASON OF THEIR IMMIGRATION STATUS. THOSE WHO EMPLOY AN ADULT WITHOUT LEAVE OR WHO IS SUBJECT TO CONDITIONS AS TO EMPLOYMENT WILL BE LIABLE TO A CIVIL PENALTY UNDER SECTION 15 OF THE IMMIGRATION, ASYLUM AND NATIONALITY ACT 2006 AND PURSUANT TO SECTION 21 OF THE SAME ACT, WILL BE COMMITTING AN OFFENCE WHERE THEY DO SO IN THE KNOWLEDGE, OR WITH REASONABLE CAUSE TO BELIEVE, THAT THE EMPLOYEE IS DISQUALIFIED

Appendix 2

The entire store is to be licensed for the sale of alcohol

BANK

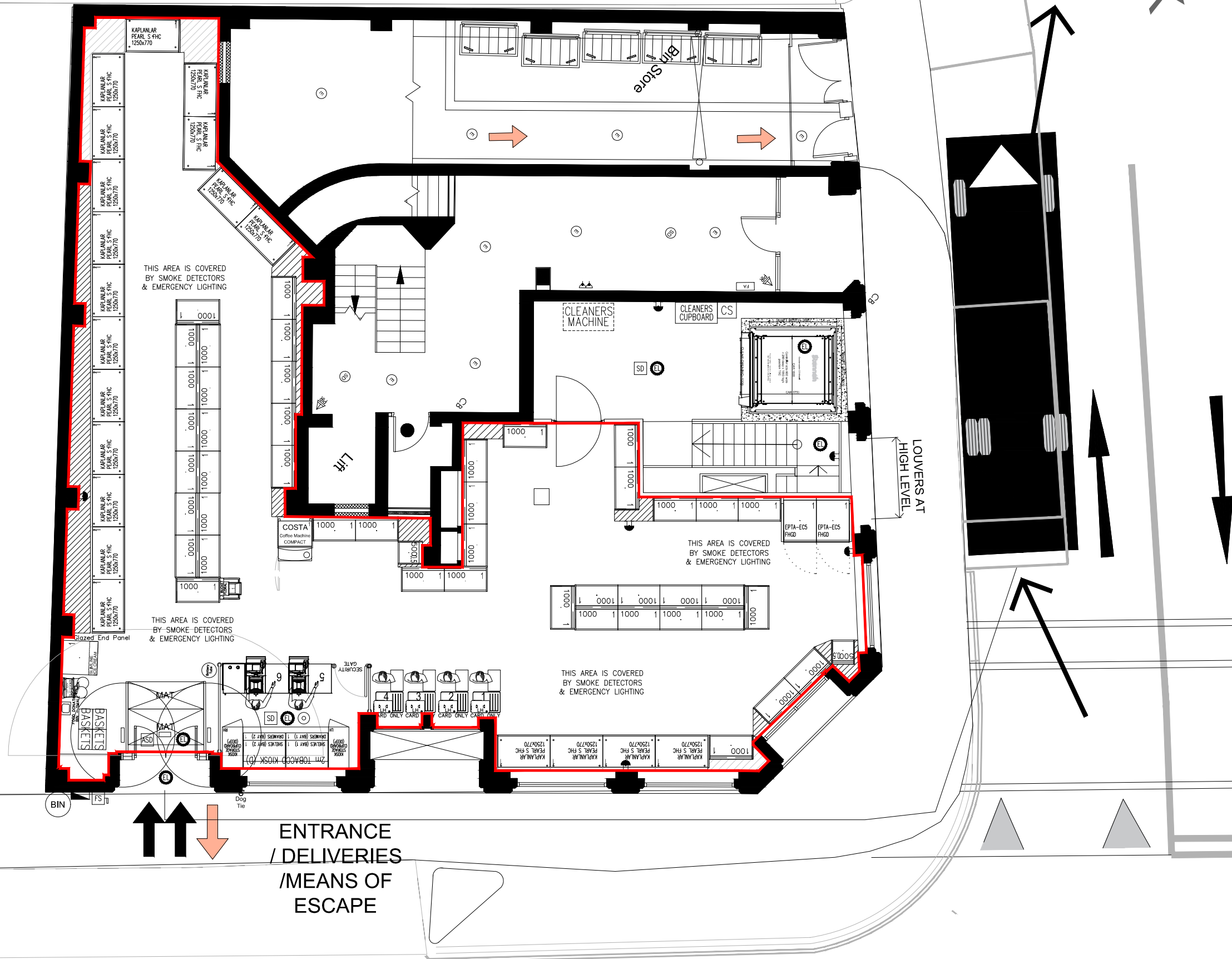

NOTES
DO NOT SCALE

REVISIONS

NO.	DESCRIPTION

LEGEND

DESCRIPTION	DESCRIPTION
[PB]	PUSH BAR
[FS]	FIREMANS SWITCH
[CA]	FIRE ALARM CALL POINT
[W]	FIRE EXTINGUISHER WATER
[F]	FIRE EXTINGUISHER FOAM
[D]	FIRE EXTINGUISHER DRY POWDER
[C]	FIRE EXTINGUISHER CARBON DIOXIDE
[B]	FIRE BLANKET
[M]	AFFF MULTIPURPOSE EXTINGUISHER
[R]	FIRE FIGHTING HOSE REEL
[E]	FIRE EXIT DOORS
[ASD]	AUTOMATIC SLIDING DOORS
[M]	DOORS WITH ELECTRO MAGNETIC LOCKS
[E]	EXIT SIGN (RUNNING MAN)
[SD]	SMOKE DETECTOR CEILING MOUNTED.
[HFD]	HIDDEN FIRE DETECTOR
[B]	FIRE ALARM BELL
[P]	FIRE ALARM PANEL
[SP]	AUTOMATIC SPRINKLER POINTS
[ELP]	EMERGENCY LIGHTING POINT
[ELI]	EMERGENCY LIGHTING ILLUMINATED EXIT BOX

0000
WAPPING LANE

PROPOSED
GROUND FLOOR
STORE PLAN

LICENSING MANAGER JOANNE SURGUY	AGENCY CAD
DRAWING CREATOR 29.11.2022	SCALE 1:100
DRAWING NUMBER 0000G01-1	REVISION -

Sainsbury's
STORE DEVELOPMENT GROUP, SAINSBURY'S SUPERMARKETS LTD
33 HOLBORN, LONDON, EC1N 2HT
TELEPHONE: 020 7695 6000 FAX: 020 7695 7610

The entire store is to be licensed for the sale of alcohol

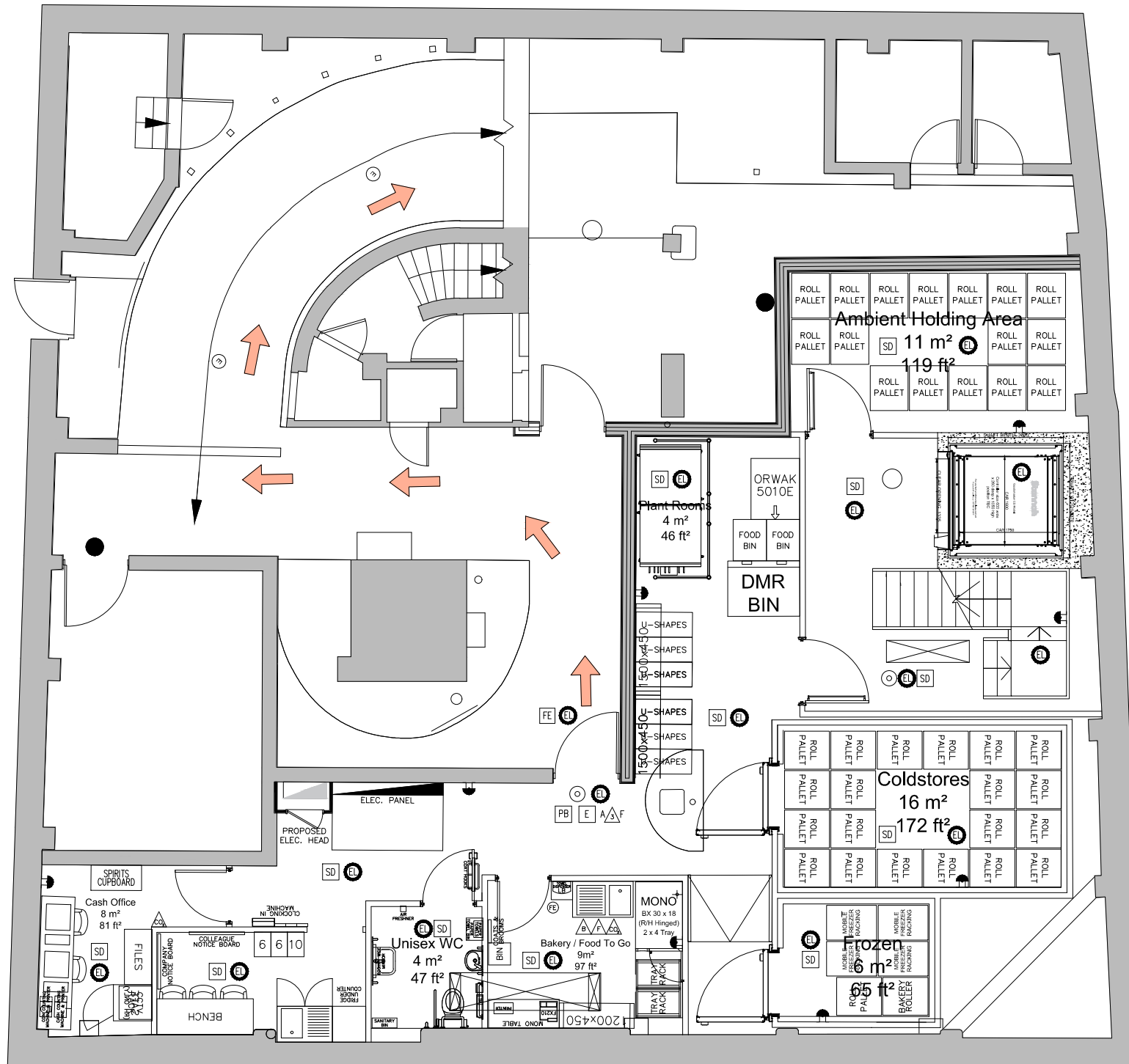

NOTES

DO NOT SCALE

REVISIONS

LEGEND

DESCRIPTION	DESCRIPTION
[PB]	PUSH BAR
[FS]	FIREMANS SWITCH
[C]	FIRE ALARM CALL POINT
[W]	FIRE EXTINGUISHER WATER
[F]	FIRE EXTINGUISHER FOAM
[D]	FIRE EXTINGUISHER DRY POWDER
[C]	FIRE EXTINGUISHER CARBON DIOXIDE
[B]	FIRE BLANKET
[M]	AFFF MULTIPURPOSE EXTINGUISHER
[R]	FIRE FIGHTING HOSE REEL
[E]	FIRE EXIT DOORS
[ASD]	AUTOMATIC SLIDING DOORS
[M]	DOORS WITH ELECTRO MAGNETIC LOCKS
[E]	EXIT SIGN (RUNNING MAN)
[SD]	SMOKE DETECTOR CEILING MOUNTED.
[HFD]	HIDDEN FIRE DETECTOR
[B]	FIRE ALARM BELL
[P]	FIRE ALARM PANEL
[S]	AUTOMATIC SPRINKLER POINTS
[E]	EMERGENCY LIGHTING POINT
[E]	EMERGENCY LIGHTING ILLUMINATED EXIT BOX

0000
WAPPING LANE

PROPOSED
BASEMENT
STORE PLAN

LICENSING MANAGER JOANNE SURGUY	AGENCY CAD
DRAWING CREATOR 29.11.2022	SCALE 1:100
DRAWING NUMBER 0000B01-I	REVISION -

Sainsbury's
STORE DEVELOPMENT GROUP, SAINSBURY'S SUPERMARKETS LTD
33 HOLBORN, LONDON, EC1N 2HT
TELEPHONE: 020 7695 6000 FAX: 020 7695 7610

Appendix 3

Maps – 70 Wapping Lane

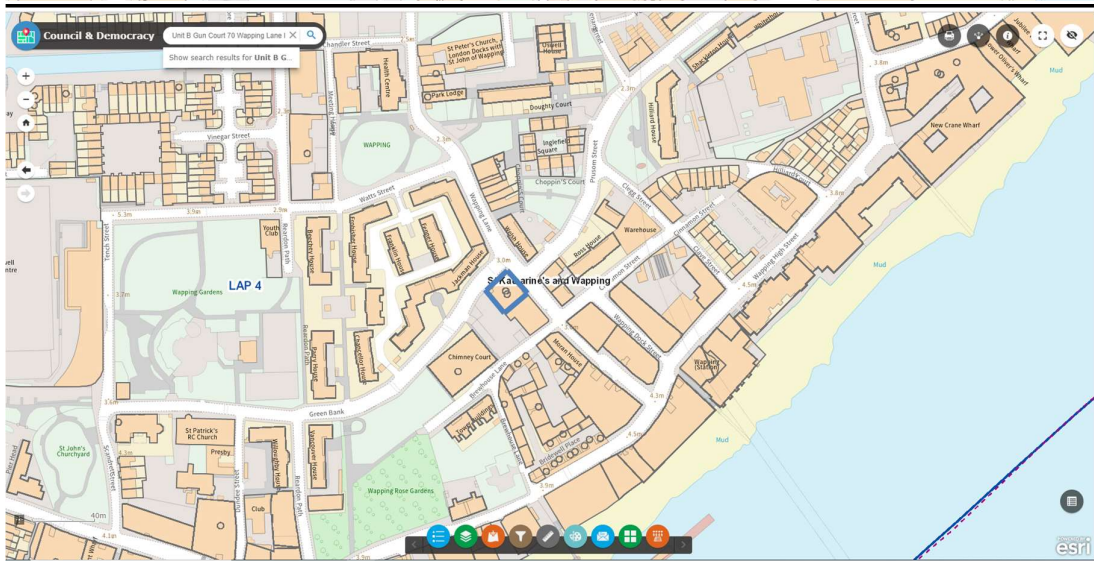
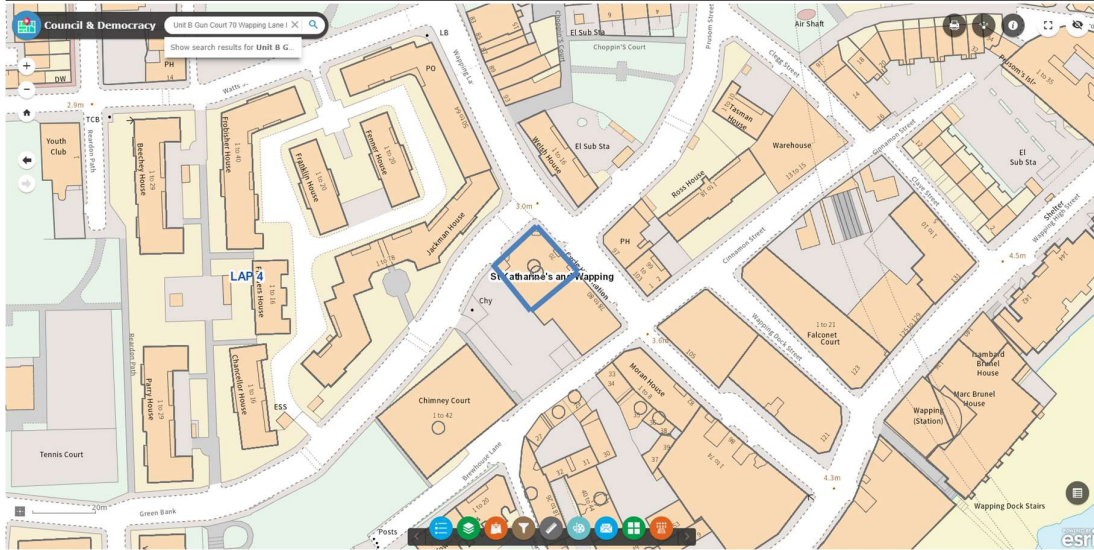
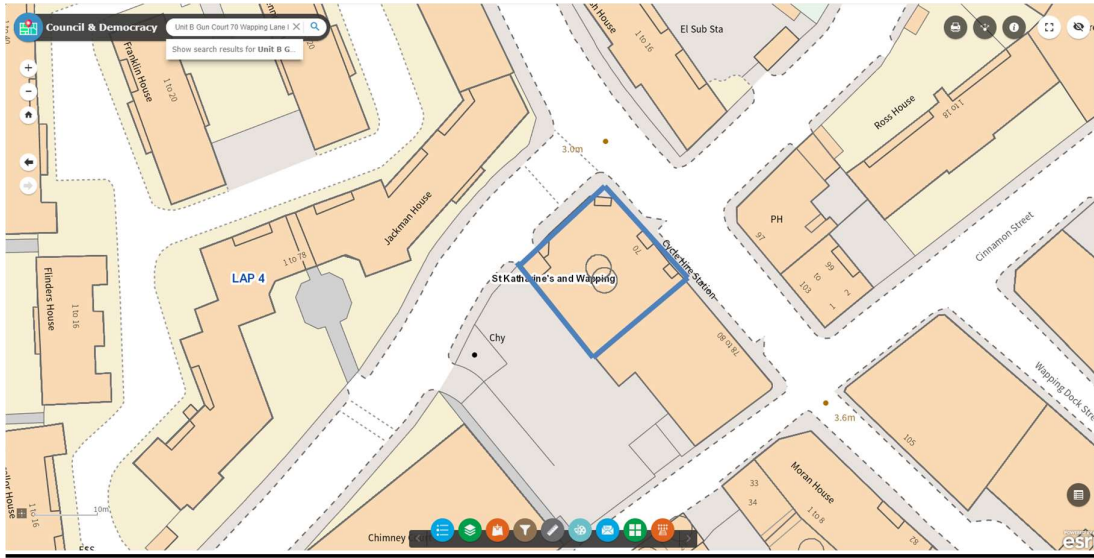

Appendix 4

Photos – Sainsbury's , 70 Wapping Lane

Licensing Act 2003
Application for a Premises Licence

Name of Applicant: Sainsbury's Supermarkets Ltd

Address: Sainsbury's, 70 Wapping Lane, Tower Hamlets, E1W 2RD

Licensing Authority: London Borough of Tower Hamlets Council

Licensing Authority Address: Licensing Team, London Borough of Tower Hamlets, Mulberry Place, 5 Clove Crescent, London, E14 2BG
(where a record of the application may be inspected during normal office hours).

Licensing Authority Website: www.towerhamlets.gov.uk

The applicant has applied to the Licensing Authority for a premises licence for the above premises for the following licensable activities:

To allow the sale of alcohol to between the hours of 0700 and 2300 daily for consumption off the premises

Any person or responsible authority (as defined by the Licensing Act 2003) may make representations to the Licensing Authority no later than 29 December 2022.

Any representations made to the Licensing Authority must be in writing.

It is an offence to knowingly or recklessly make a false statement in connection with an application and the maximum fine for which a person is liable on summary conviction for the offence is an unlimited fine.

Winckworth Sherwood LLP,
Minerva House, 5 Montague Close,
London, SE1 9BB
Ref: AGS/26508/02106/RPB
Solicitors and authorised agents for the applicant.

Dated: 1 December 2022







Appendix 5

Premises	Licensable Activities	Opening Hours
<p>(Dockers Inn) 97 Wapping Lane</p>	<p>The sale by retail of alcohol (on and off sales): Monday to Thursday from 11:00 hours to midnight Friday and Saturday 11:00 hours to 02:00 hours the following day Sunday from 12:00 hours to midnight</p> <p>Regulated Entertainment: Recorded music and anything of a similar description, Indoor Sporting events: Monday, Tuesday, Wednesday, Thursday from 11:00 hours to midnight Friday and Saturday 11:00 hours to 02:00 hours the following day Sunday from 12:00 hours to midnight</p> <p>Live Music: Friday and Saturday from 12:00 hours to midnight Sunday from 12:00 hours to 23:00 hours</p> <p>Late Night Refreshment Sunday to Thursday from 23:00 hours to 00:30 hours the following day Friday and Saturday 23:00 hours to 02:30 hours the following day</p> <p>In addition to the above: Christmas Eve, Patron Saints Days and Burns Night from 10:00 hours to 02:00 am the following day.</p> <p>Note: New Years Eve is subject to the Regulatory Reform (Special Occasion Licensing) Order 2002. Which means that while that order is in effect the premises may remain open for the twelve hours between 11pm on New Years Eve and 11am on New Years Day. However, live music to finish at 01:00 hours New Years Day.</p>	<p>Monday to Thursday from 11:00 hours to 00:30 hours the following day Friday and Saturday 11:00 hours to 02:30 hours the following day Sunday from 12:00 hours to 00:30 hours the following day In addition to the above: Christmas Eve, Patron Saints Days and Burns Night from 10:00 hours to 02:30 am the following day.</p> <p>Note: New Years Eve is subject to the Regulatory Reform (Special Occasion Licensing) Order 2002. Which means that while that order is in effect the premises may remain open for the twelve hours between 11pm on New Years Eve and 11am on New Years Day.</p>

<p>(Best One Supermarket) 56 - 58 Wapping Lane</p>	<p>Sale of Alcohol (off sales): a. On weekdays, other than Christmas Day, 8 a.m. to 11 p.m. b. On Sundays, other than Christmas Day, 10 a.m. to 10.30 p.m. c. On Christmas Day, 12 noon to 3 p.m. and 7 p.m. to 10.30 p.m. d. On Good Friday, 8 a.m. to 10.30 p.m.</p>	<p>There are no restrictions on the hours during which this premises is open to the public</p>
<p>(Fresh Foods) 87A Wapping Lane</p>	<p>The sale by retail of alcohol (off sales)</p> <ul style="list-style-type: none"> • Monday to Saturday from 08:00hrs to 23:00hrs • Sunday from 09:00hrs to 23:00hrs 	<ul style="list-style-type: none"> • Monday to Saturday from 08:00hrs to 23:00hrs • Sunday from 09:00hrs to 23:00hrs
<p>(Wapping Tavern) 78-80 Wapping Lane</p>	<p>The sale by retail of alcohol and late night refreshment: Monday, Tuesday, Wednesday, Thursday, Friday and Saturday from 10:00 hours to midnight. Sunday from 12:00 hours to 23:30 hours</p> <p>Regulated Entertainment consisting of live music and provision of facilities for making music: Monday, Tuesday, Wednesday, Thursday, Friday, Saturday and Sunday from 19:00 hours to 22:30 hours.</p> <p>In addition to the above: New Years Eve is subject to the Regulatory Reform (Special Occasion Licensing) Order 2002. Which means that while that order is in effect the premises may remain open for the twelve hours between 11pm on New Years Eve and 11am on New Years Day.</p>	<p>Monday, Tuesday, Wednesday, Thursday, Friday, Saturday and Sunday from 10:00 hours to 00:30 hours. Note: However, New Years Eve is subject to the Regulatory Reform (Special Occasion Licensing) Order 2002. Which means that while that order is in effect the premises may remain open for the twelve hours between 11pm on New Years Eve and 11am on New Years Day.</p>

<p>(Wapping Wines) 101 Wapping Lane</p>	<p>Sale of Alcohol (off sales):</p> <ul style="list-style-type: none"> a. On weekdays, other than Christmas Day, 8 a.m. to 11 p.m. b. On Sundays, other than Christmas Day, 10 a.m. to 10.30 p.m. c. On Christmas Day, 12 noon to 3 p.m. and 7 p.m. to 10.30 p.m. d. On Good Friday, 8 a.m. to 10.30 p.m. <p>See Mandatory conditions for drinking up time</p>	<p>There are no restrictions on the hours during which this premises is open to the public</p>
<p>(Laksha Bay) 83 Wapping Lane</p>	<p>Alcohol may be sold or supplied (on sales)</p> <ul style="list-style-type: none"> (1) On weekdays, other than Christmas Day, Good Friday or New Year's Eve from 10am to 12pm. (2) On Sundays, other than Christmas Day or New Year's Eve, and on Good Friday: 12 noon to 11:30pm (3) On Christmas Day: 12 noon to 11:30pm; (4) On New Year's Eve, except on a Sunday, 11 a.m. to midnight; (5) On New Year's Eve on a Sunday, 12 noon to 11.30 p.m. (6) On New Year's Eve from the end of permitted hours on New Year's Eve to the start of permitted hours on the following day (or, if there are no permitted hours on the following day, midnight on 31st December). <p>Note: However, New Years Eve is subject to the Regulatory Reform (Special Occasion Licensing) Order 2002. Which means that while that order is in effect the premises may remain open for the twelve hours between 11pm on New Years Eve and 11am on New Years Day.</p>	<p>There are no restrictions on the hours during which this premises is open to the public</p>

Appendix 6

Corinne Holland

From: amanda day [REDACTED] >
Sent: 29 December 2022 16:40
To: Licensing
Subject: Ref CLC/EHTSLIC/155582

REPRESENTATION FROM AMANDA DAY AGAINST PREMISES LICENCE APPLICATION FOR 70 WAPPING LANE
E1W 2RD

AMANDA DAY
[REDACTED]

I would like to submit the following representation against the above application and argue for extenuating circumstances outside of the regular licensing objectives.

The granting of a premises licence for 70 Wapping Lane will have a significant and detrimental impact on the remaining shops on Wapping Lane. If footfall on Wapping Lane is significantly reduced it could lead to an increase in anti social behaviour. There have been many issues of drug dealing behind the former bakery in the past 4 years, CCTV was installed but is faulty. The local shops are a lifeline for people in Wapping and is where people meet and chat and without them the strong community spirit in Wapping will disappear.

Since 2018 Wapping Lane has lost 4 shops: a betting shop, a bakery, an Indian Restaurant and a grocery store which was forced to close because of a fire in the flat above. The shops have closed because of financial difficulties, COVID and increased rates and rent and rates which have have doubled in the past year. The bakery, which had been there for decades has been vacant since March. The betting shop closed in 2018 and remains vacant as does the restaurant and Wapping Lane is deserted most of the time. Is more shops are forced to close it would mean a further loss of rents and rates which in turn will make the area poorer in financial, social and economic terms and open it up to more anti-social behaviour.

Amanda Day

Appendix 7

Corinne Holland

From: Abdul Foyez <[REDACTED]>
Sent: 21 December 2022 11:46
To: Licensing
Subject: Sainsbury's planning complaint letter

Follow Up Flag: Follow up
Flag Status: Completed

To whom it may concern,

I am writing in reference to the following application; CLC/EHTS/LIC/155582 made to Tower Hamlets council on behalf of Sainsbury's supermarkets Ltd and their request for a licence under the licensing act 2003.

As you maybe aware they are attempting to open and operate at 70 Wapping lane, it is my wish to put in a formal letter of discontent and objection to this under the requirements of the planning and licensing laws.

I have several conflixtions to your granting of a potential licence, one of which is the over saturation of premises having the ability to sell alcohol in such a small area, current consensus putting the total area of Wapping at just over 5 hectares with a mean population of 10,581 residents in total.

In Wapping lane alone, we have

- 2 off-licences,
- 1 wine and high end spirits seller
- best one supermarket with an alcohol license,
- 2 pubs
- the old pizza express that has literally been turnt in to another alcohol venue
- tobacco dock and its multiple venues and spaces all of which have alcohol licenses.

We currently have all these premises operating with licenses and this is to a ward with 8,809 16-64 year olds that's a 83.3% share of the Wapping area with readily accessible exposure and availability to alcohol a leading cause to the current high rate of property crime we experience in Wapping, as confirmed by the current consensus and freedom of information request and widely available data on tower hamlets own council website under crime and safety section.

These are only but a few of the more pressing issues facing your woeful acceptance of yet another venue selling in the area, furthermore it will be of no benefit to our community, we may be a ward in tower hamlets in the city of London but we are the smallest of all of them and have a more village/ family friendly community vibe going on, we do our best to retain the old east end values of looking after our neighbours especially during Covid when so many was isolated and vulnerable, it's is our feelings that with a supermarket like Sainsbury's being opened and allowed to sell alcohol in our area it will attract more people to the area and inevitably more crime, the numbers of which are easily accessible on the tower hamlets website.

If this does not sway your consciousness then can we think about the religious and youth makeup of the area and how we have 2 churches, a mosque and a community centre and several primary schools in the area, all of which already have to contend with the over saturation of alcohol premises and have a considerable effort to fight against the negative impact and inflictions that currently exist but to subject them further with the granting of the Sainsbury's is moral reprehensible.

In addition to the moral dilemmas Sainsbury's poses there is the added issue of traffic build up and delivery trucks coming and going at all hours causing real time problems for the many key workers and children's sleeping, the very close proximity to social housing and families it will have and how the delivery trucks will prevent resident parking which is already restricted due to the bus gate in current operation which we fought hard to keep as traffic was a already compelling issue to install a gate in the first place now by your actions is almost like you are dismissing your (tower hamlets council's) own arguments and justifications.

At the existing space of 70 Wapping lane there is no loading bay as it is to provide one will cause an unimaginable amount of damage and distruction to the area not to mention the historic value of the ancient cobble stone roads and the active conservation of the docks and area.

It is my deepest wish that you take all I have said and many other mitigating factors in to consideration and I implore you to side with residents in rejecting the application and withhold any and all licenses you're able to.

Yours sincerely,

Mr Raju Foyez



Appendix 8

Corinne Holland

From: Licensing
Sent: 23 December 2022 10:41
To: Corinne Holland
Subject: FW: Sainsburys supermarkets LTD, Sainsburys 70 Wapping Lane, tower hamlets E1W 2RD - M/155582

-----Original Message-----

From: Abul Hussain <[REDACTED]>
Sent: 23 December 2022 10:20
To: Licensing <Licensing@towerhamlets.gov.uk>
Subject: Re: Sainsburys supermarkets LTD, Sainsburys 70 Wapping Lane, tower hamlets E1W 2RD - M/155582

Dear sir/madam

Thank you for getting back to me regarding premises license, I understand that business competition is not a valid reason to not to grant a premises license, But I did mention about anti social behaviour around this area as most of the shop closes around 7pm, but a Sainsburys staying open till 11pm and selling alcohol will attract,

- crime and disorder
- public nuisance
- public safety
- protection of children from harm

As i mentioned Wapping is a very quite area and having a Sainsburys that stays open very late and selling alcohol compare to most of the local stores it will attract a lot of illegal activities.

Please do not ignore my concern when granting an premises license.

Thank you
Abul Hussain
(A local resident and business owner)

Sent from my iPhone

> On 21 Dec 2022, at 15:13, Licensing <Licensing@towerhamlets.gov.uk> wrote:

>

> Dear Mr Hussain

>

> I'm afraid I cannot accept your objection as valid at this stage as it does not address how the granting of this licence will undermine the licensing objectives.



>

> Business competition or having another licensed premises in the area alone are not reasons to make your objection valid.

>

> Please be advised that under the Licensing Act 2003, the criteria for your representation to be valid is that you must make it clear how granting this particular application will have an impact on you only in relation to one or more of the following licensing objectives:

- > • the prevention of crime and disorder
- > • the prevention of public nuisance
- > • public safety
- > • the protection of children from harm

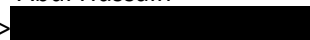
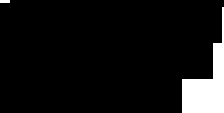
>
> Please see the link to our website for further details.
>
> https://gbr01.safelinks.protection.outlook.com/?url=https%3A%2F%2Fwww.towerhamlets.gov.uk%2Fignl%2Fbusiness%2Flicences%2FAlcohol_and_ent&data=05%7C01%7CCorinne.Holland%40towerhamlets.gov.uk%7C6f7abf20aefb415beb808dae4d23667%7C3c0aec87f983418fb3dcd35db83fb5d2%7C0%7C0%7C638073888740258932%7CUnknown%7CTWFpbGZsb3d8eyJWIjoiMC4wLjAwMDAiLCJQIjoiV2luMzliLjBtIl6Ik1haWwiLCJXVCi6Mn0%3D%7C3000%7C%7C%7C&sdata=0EpKBtDQsYWClc8cP5xIZt%2F9guVPUJ2rbSI%2FEzLzjsk%3D&reserved=0
> entertainment/Representation.aspx
>
> If you wish to make a representation to this application it must be received by the licensing authority by midnight on the 29th December 2022.
>
>
> Kind regards
>
> Corinne Holland
> Licensing Officer
> Environmental Health and Trading Standards Place Directorate London
> Borough of Tower Hamlets 2nd Floor, Mulberry Place
> 5 Clove Crescent
> London
> E14 2BG
>
> 
> <https://gbr01.safelinks.protection.outlook.com/?url=http%3A%2F%2Fwww.towerhamlets.gov.uk%2F&data=05%7C01%7CCorinne.Holland%40towerhamlets.gov.uk%7C6f7abf20aefb415beb808dae4d23667%7C3c0aec87f983418fb3dcd35db83fb5d2%7C0%7C0%7C638073888740258932%7CUnknown%7CTWFpbGZsb3d8eyJWIjoiMC4wLjAwMDAiLCJQIjoiV2luMzliLjBtIl6Ik1haWwiLCJXVCi6Mn0%3D%7C3000%7C%7C%7C&sdata=Of%2Bx3C3jgpJsmSRCNas5fDfwzgtzJLp13rPwPpgAMV0%3D&reserved=0>
>
> Follow us on:
> Facebook | Twitter | LinkedIn | Instagram
>
> -----Original Message-----
> From: Abul Hussain < >
> Sent: 21 December 2022 12:30
> To: Licensing <Licensing@towerhamlets.gov.uk>
> Subject: Sainsburys supermarkets LTD, Sainsburys 70 Wapping Lane, tower hamlets E1W 2RD
>
> Abul Hussain
> 
> 
>
> Dear sir/madam
>
> I have a store close to proposed Sainsburys location that have applied for a premises license to sell alcohol, I'm opposed to this as it will damage businesses nearby that sell alcohol but are closed early due to anti social behaviour late nights. Wapping is a very quite area most of the shops closes early around 7pm, but having a Sainsburys will damaged a lot of business nearby.

- > Currently all businesses nearby are petitioning against having a Sainsburys here altogether.
- > Please take my concern into consideration before granting a premises license.
- > Thank
- > Abul Hussain
- >
- >
- >
- >
- > Sent from my iPhone

Appendix 9

Corinne Holland

From: Ann Jackson <[REDACTED]>
Sent: 03 January 2023 14:31
To: Corinne Holland
Subject: Re: Sainsbury's, 70 Wapping Lane - M/155582

Hi

[REDACTED]

Thanks

Ann Jackson

Sent from my iPhone

> On 3 Jan 2023, at 14:14, Corinne Holland [REDACTED] wrote:

>

> Dear Sir/Madam

>

> In order for your representation to be valid you are required to provide your full name and address. These will be forwarded to the applicant at the end of the consultation period where they can contact you to mediate with you to address your concerns.

>

> As the consultation period for this application expired on 29th December 2022 please respond with these details within the next seven days in order for us to consider your representation.

>

>

> Kind regards

>

> Corinne Holland

> Licensing Officer

> Environmental Health and Trading Standards Place Directorate London

> Borough of Tower Hamlets 2nd Floor, Mulberry Place

> 5 Clove Crescent

> London

> E14 2BG

>

>

> <https://gbr01.safelinks.protection.outlook.com/?url=http%3A%2F%2Fwww.towerhamlets.gov.uk%2F&data=05%7C01%7CCorinne.Holland%40towerhamlets.gov.uk%7C9d9353b958264e8cf48f08daed972d4c%7C3c0aec87f983418fb3dcd35db83fb5d2%7C0%7C0%7C638083530797338530%7CUnknown%7CTWFpbGZsb3d8eyJWljoiMC4wLjAwMDAiLCJQIjoiV2luMzliLCJBTiI6Ikk1haWwiLCJXVCi6Mn0%3D%7C3000%7C%7C%7C&sddata=mpXmEBOYV3eOrtgDsPkjBvSGroCDS2dLbnlkUHYJm3E%3D&reserved=0>

> v.uk%7C9d9353b958264e8cf48f08daed972d4c%7C3c0aec87f983418fb3dcd35db83f

> b5d2%7C0%7C0%7C638083530797338530%7CUnknown%7CTWFpbGZsb3d8eyJWljoiMC4w

> LjAwMDAiLCJQIjoiV2luMzliLCJBTiI6Ikk1haWwiLCJXVCi6Mn0%3D%7C3000%7C%7C%7C

> &sddata=mpXmEBOYV3eOrtgDsPkjBvSGroCDS2dLbnlkUHYJm3E%3D&reserved=0

>

>

> Follow us on:

> Facebook | Twitter | LinkedIn | Instagram

>

> -----Original Message-----

> From: Ann Jackson <[REDACTED]>

> Sent: 28 December 2022 22:00

> To: Licensing <Licensing@towerhamlets.gov.uk>

> Subject: Wapping Lane

>

> NO to Sainsbury's on Wapping

>

> Representation AGAINST PREMISES LICENCE APPLICATION FOR 70 WAPPING

> LANE E1W 2RD

>

> I would like to submit the following representation against the above application and argue for extenuating circumstances outside of the regular licensing objectives.

>

> The granting of a premises licence for 70 Wapping Lane will have a significant and detrimental impact on not just the remaining shops on Wapping Lane but across Wapping in general. This includes the shops on Garnet Street, Wapping Wall Wapping High Street. If footfall on Wapping Lane is significantly reduced it could lead to gangs taking over – there have been many issues of drug dealing behind the former bakery in the past 4 years, CCTV was installed but is faulty. The local shops are a lifeline for people in Wapping and is where people meet and chat and without them the strong community spirit in Wapping will disappear.

>

> Since 2018 Wapping Lane has lost 4 shops: a betting shop, a bakery, an Indian Restaurant and a grocery store which was forced to close because of a fire in the flat above. The shops have closed because of financial difficulties, COVID and increased rates and rents. My rent and rates have doubled in the past year. The bakery, which had been there for decades has been vacant since March. The betting shop closed in 2018 and remains vacant as does the restaurant. Wapping Lane is deserted most of the time and if Sainsbury's is allowed to trade there, my shop will be not be able to compete nor Wapping Wines at 101 Wapping Lane and it's unlikely the grocery store will reopen. That would mean a further loss of rents and rates which in turn will make the area poorer in financial, social and economic terms and open it up to more anti-social behaviour.

>

> There are also issues over parking and loading as Wapping Lane is now single lane traffic. If car/van usage increases it could cause traffic issues on the junction of Green Bank, Wapping Lane and Cinnamon Street which is a no entry street. Traffic build up could cause problems for children and the elderly. In the past there was a lollipop lady on the crossing by Wapping Lane shops but the service stopped a few years ago. Buses have difficulties travelling along Wapping Lane since the pavements were widened last year so large lorries making deliveries will cause hold ups.

>

> This application could see the end of Wapping Lane as a shopping area and goes against the Council's policies to reinvigorate local high streets.

>

> Regards

> A Jackson Wapping Resident

>

> Sent from my iPhone

Appendix 10

Corinne Holland

From: Amy West <[REDACTED]>
Sent: 28 December 2022 21:57
To: Licensing
Subject: Wapping Lane Sainsburys

Dear Licencing Committee,

I am writing to you as a resident of Wapping to object against the current license application.

Having a shop like this serving more alcohol will cause problems for the local community & already established local businesses.

We already have problems with ASB coming from non-residents visiting Tobacco Docks and the issues that causes the local community. This includes drunk individuals fighting, urinating on the street, acting intoxicated in our local community.

We are also concerned about the impact on our local small businesses - many who cater to our elderly residents and have relationships with them - eg home delivery, understanding their needs etc. It is extremely likely that the business of Sainsbury's will cause the small shops to close as not able to compete. This will have a direct and devastating effect on our elderly residents & those with disabilities. We no longer have a meals on wheels service due to the last Mayor cutting this service and many rely on the local shops & the extra mile they will go for these residents.

There are already enough Sainsburys and other big chain outlets in the area. Why have another one when there is one just up the road on the Highway?

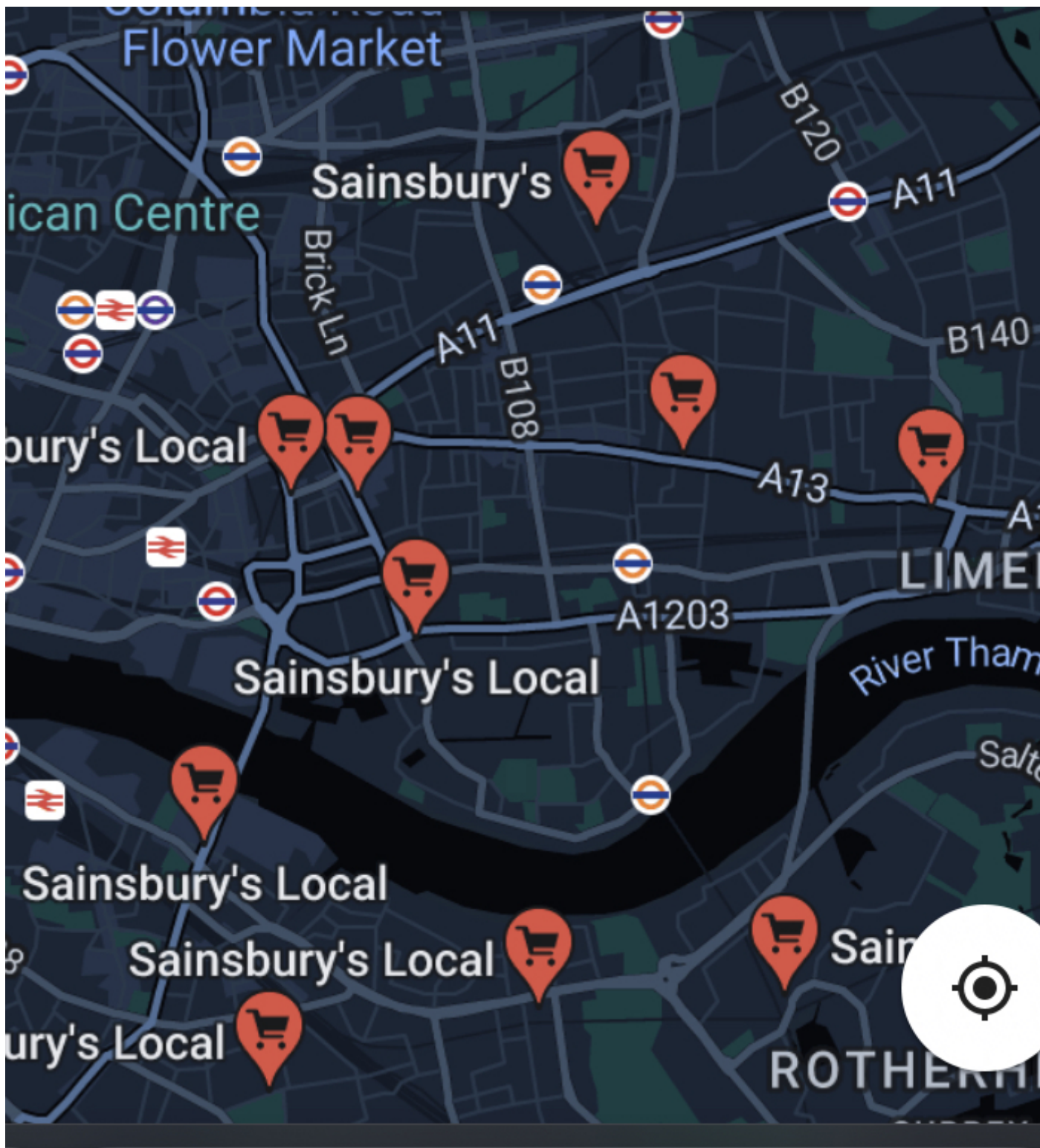

I ask that you please reject this application.

Many Thanks

Kind Regards

Amy West

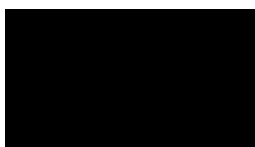

Appendix 11

Corinne Holland

From: Charlie Tymms <[REDACTED]>
Sent: 29 December 2022 10:52
To: Licensing
Subject: Objection

Dear Sirs/Madam

Representation FROM Charlotte Tymms, [REDACTED] AGAINST PREMISES LICENCE APPLICATION FOR 70 WAPPING LANE E1W 2RD

I would like to submit the following representation against the above application and argue for extenuating circumstances outside of the regular licensing objectives.

The granting of a premises licence for 70 Wapping Lane will have a significant and detrimental impact on not just the remaining shops on Wapping Lane but across Wapping in general. This includes the shops on Garnet Street, Wapping Wall Wapping High Street. If footfall on Wapping Lane is significantly reduced it could lead to gangs taking over – there have been many issues of drug dealing behind the former bakery in the past 4 years, CCTV was installed but is faulty. The local shops are a lifeline for people in Wapping and is where people meet and chat and without them the strong community spirit in Wapping will disappear.

Since 2018 Wapping Lane has lost 4 shops: a betting shop, a bakery, an Indian Restaurant and a grocery store which was forced to close because of a fire in the flat above. The shops have closed because of financial difficulties, COVID and increased rates and rents. My rent and rates have doubled in the past year. The bakery, which had been there for decades has been vacant since March. The betting shop closed in 2018 and remains vacant as does the restaurant. Wapping Lane is deserted most of the time and if Sainsbury's is allowed to trade there, my shop will be not be able to compete nor Wapping Wines at 101 Wapping Lane and it's unlikely the grocery store will reopen. That would mean a further loss of rents and rates which in turn will make the area poorer in financial, social and economic terms and open it up to more anti-social behaviour.

There are also issues over parking and loading as Wapping Lane is now single lane traffic. If car/van usage increases it could cause traffic issues on the junction of Green Bank, Wapping Lane and Cinnamon Street which is a no entry street. Traffic build up could cause problems for children and the elderly. In the past there was a lollipop lady on the crossing by Wapping Lane shops but the service stopped a few years ago. Buses have difficulties travelling along Wapping Lane since the pavements were widened last year so large lorries making deliveries will cause hold ups.

This application could see the end of Wapping Lane as a shopping area and goes against the Council's policies to reinvigorate local high streets.

Yours sincerely
Charlotte Tymms

Appendix 12

Corinne Holland

From: Charlotte W <[REDACTED]>
Sent: 28 December 2022 23:33
To: Licensing
Subject: Application for 70 wapping lane

Follow Up Flag: Follow up
Flag Status: Flagged

Hi,

Id like to object to the licence application at 70 wapping Lane. Granting this licence will kill the other shops on Wapping Lane and elsewhere in Wapping. I think this will affect safety due to drop in pedestrian activity and also an increase in ASB as premises become empty.

My address is [REDACTED]

Thanks
Charlotte webster

Appendix 13

Corinne Holland

From: Giles Sparrow <[REDACTED]>
Sent: 29 December 2022 22:04
To: Licensing
Subject: Objection to change of use proposed licensing of new Sainsbury's store on Wapping Lane/Green Bank

Follow Up Flag: Follow up
Flag Status: Completed

Dear Tower Hamlets,

We are writing as long-time Wapping residents, having just been made aware of the application for a new Sainsbury's Local supermarket, understood to have applied for a license to sell alcohol for consumption off-premises, in the redevelopment of Gun Court, 68 Wapping Lane.

We wish to express our objections to this application in the strongest possible terms on the following grounds:

1) The insertion of a chain supermarket onto Wapping Lane will be harmful to the area's unique character, and crucially to independent local businesses at a time when many are struggling to survive. We understand Tower Hamlets Council has a stated policy to support independent retailers in our local high streets and, small though the cluster of shops on Wapping Lane and nearby may be, it is *our* de facto High Street – the mix of different retailers plays a vital role at the heart of our community which would be damaged by further losses. Introducing the Sainsbury's would threaten the viability of the Best One convenience store, probably ensure that the smaller late-night convenience store at 87 Wapping Lane is unable to reopen (it is currently closed due to damage after a fire in the flats above), and also endanger our local independent butcher's and greengrocer's stores as well as the Wapping Wines off-licence directly opposite.

2) With both Best One and Wapping Wines licensed to sell alcohol for home consumption, the granting of a similar licence to Sainsbury's seems excessive - their corporate nature will undoubtedly lead to undercutting the independent competition and forcing them out of business, ultimately limiting choice in the area. What's more, the licensors at Best One and Wapping Wines are responsible members of our community, and ultimately accountable to their neighbours with regard to the behaviour of their customers. We believe these two factors lead them to quietly "police" their sales of alcohol, thus reducing anti-social behaviour in the area. An anonymous supermarket chain with casual staffing will feel no such responsibility, and even if later enforcement action such as revocation of licence could be taken, the damage would already be done.

3) The roads around the proposed Sainsbury's premises are narrow, prone to jams and are used by two key bus routes for our community (the D3 and 100). The site is therefore highly unsuitable for the substantial delivery vehicles required by even the smallest supermarkets.

My wife Katja and I have lived in Wapping for some 22 years and are writing now out of deep alarm that the proposed Sainsbury's threatens well established and much-used local businesses as well as the entire character of our community. We would be grateful to know that these concerns will be taken into account - **and if there are other ways in which we should formally voice our objections, please let us know the relevant details.**

We would also note that despite living less than 100 metres from the location in question, we have received no notice regarding a planning or licence application, and no outreach from either the developer or Sainsbury's themselves – something that we feel reveals a telling disregard for our community.

Yours sincerely,

Giles Sparrow & Katja Seibold

Appendix 14

Corinne Holland

From: Ikraam miah <[REDACTED]>
Sent: 22 December 2022 16:57
To: Licensing
Subject: RE: Sainsburys, 70 Wapping Lane, Tower Hamlets, E1W 2RD

Follow Up Flag: Follow up
Flag Status: Completed

Dear Sir/Madam,

RE: SAINSBURYS, 70 Wapping Lane, Tower Hamlets, E1W 2RD

I am writing to inform you of the distress within our community regarding the sale of alcohol in a small and overwhelmed area. You should be aware that there are a variety of premises which hold alcohol licences within our small village. This includes 3 off licences as well as 3 pubs on the same road and also Tobacco dock that hosts events regularly which permit sale and consumption of alcohol.

Permitting alcohol licence on another premises within our small village like area makes the people of our community vulnerable and uneasy. There are too many off-licences in a small area which would only increase anti-social behaviour on our streets, as well as encourage more drinking. The development of Sainsbury's is in close proximity with social housing, primary schools, community centres, places of worship and our local health centre which puts people at risk of being in contact with intoxicated people as well as anti social behaviour.

A wide-spread supermarket operating within a small communal area, that which consists of narrow historic roads only poses threat to our family friendly streets. Deliveries would cause problems for our key workers, and also come as a disturbance to bus routes, access to resident parking and vehicles operating causing unnecessary congestion. The shop is also limited to unloading space, and will also cause disruption on public foot path.

I have informed the environmental head and licensing team in the council over my concerns regarding Sainsbury's. I oppose to the development and ask you to reconsider.

We have enough supermarkets within the same road as well as this whole area. The development of Sainsbury's will be putting our small local shops in risk resulting in them closing down. We need these small businesses around as they give local residents benefits such as, credit and this vital due to the cost of the living crisis.

Regards,

Ikraam Miah

[REDACTED]

Appendix 15

Follow us on:

[Facebook](#) | [Twitter](#) | [LinkedIn](#) | [Instagram](#)

From: Ilaria Rosa [REDACTED]
Sent: 28 December 2022 21:46
To: Licensing <Licensing@towerhamlets.gov.uk>
Subject: REPRESENTATION AGAINST PREMISES LICENCE APPLICATION FOR 70 WAPPING LANE E1W 2RD

REPRESENTATION AGAINST PREMISES LICENCE APPLICATION FOR 70 WAPPING LANE E1W 2RD

I would like to submit the following representation against the above application and argue for extenuating circumstances outside of the regular licensing objectives.

The granting of a premises licence for 70 Wapping Lane will have a significant and detrimental impact on not just the remaining shops on Wapping Lane but across Wapping in general. This includes the shops on Garnet Street, Wapping Wall Wapping High Street. If footfall on Wapping Lane is significantly reduced it could lead to gangs taking over – there have been many issues of drug dealing behind the former bakery in the past 4 years, CCTV was installed but is faulty. The local shops are a lifeline for people in Wapping and is where people meet and chat and without them the strong community spirit in Wapping will disappear.

Since 2018 Wapping Lane has lost 4 shops: a betting shop, a bakery, an Indian Restaurant and a grocery store which was forced to close because of a fire in the flat above. The shops have closed because of financial difficulties, COVID and increased rates and rents. My rent and rates have doubled in the past year. The bakery, which had been there for decades has been vacant since March. The betting shop closed in 2018 and remains vacant as does the restaurant. Wapping Lane is deserted most of the time and if Sainsbury's is allowed to trade there, my shop will be not be able to compete nor Wapping Wines at 101 Wapping Lane and it's unlikely the grocery store will reopen. That would mean a further loss of rents and rates which in turn will make the area poorer in financial, social and economic terms and open it up to more anti-social behaviour.

There are also issues over parking and loading as Wapping Lane is now single lane traffic. If car/van usage increases it could cause traffic issues on the junction of Green Bank, Wapping Lane and Cinnamon Street which is a no entry street. Traffic build up could cause problems for children and the elderly. In the past there was a lollipop lady on the crossing by Wapping Lane shops but the service stopped a few years ago. Buses have difficulties travelling along Wapping Lane since the pavements were widened last year so large lorries making deliveries will cause hold ups.

This application could see the end of Wapping Lane as a shopping area and goes against the Council's policies to reinvigorate local high streets.

Regards,

Ilaria Rosa

Appendix 16

Corinne Holland

From: Marie Cahill [REDACTED]
Sent: 03 January 2023 15:22
To: Licensing
Subject: Re: Wapping Lane licensing

Hi, thx for the chaser & my details are-



From: Licensing <Licensing@towerhamlets.gov.uk>
Sent: 03 January 2023 15:02
To: Marie Cahill [REDACTED]
Subject: RE: Wapping Lane licensing

Dear Sir/Madam

In order for your representation to be valid you are required to provide your full name and address. These will be forwarded to the applicant at the end of the consultation period where they can contact you to mediate with you to address your concerns.

As the consultation period for this application expired on 29th December 2022 please respond with these details within the next seven days in order for us to consider your representation.

Kind regards

Corinne Holland
Licensing Officer
Environmental Health and Trading Standards
Place Directorate
London Borough of Tower Hamlets
2nd Floor, Mulberry Place
5 Clove Crescent
London
E14 2BG

[REDACTED]
<https://emea01.safelinks.protection.outlook.com/?url=http%3A%2F%2Fwww.towerhamlets.gov.uk%2F&data=05%7C01%7C%7C623a5f8daa994e02160708daed9b92d4%7C84df9e7fe9f640afb435aaaaaaaaaaaa%7C1%7C0%7C638083549676799767%7CUnknown%7CTWFpbGZsb3d8eyJWljiMC4wLjAwMDAiLCJQIjoiV2luMzliLCJBTiI6I1haWwiLCJXVCi6Mn0%3D%7C3000%7C%7C%7C&sdata=CikPdO6Dtp8C0mz60T%2FI3hjs%2FSyOhlx2GFA%2BDTyvUP0%3D&reserved=0>

Follow us on:
Facebook | Twitter | LinkedIn | Instagram

-----Original Message-----

From: Marie Cahill <[REDACTED]>

Sent: 29 December 2022 09:02

To: Licensing <Licensing@towerhamlets.gov.uk>

Subject: Wapping Lane licensing

REPRESENTATION AGAINST PREMISES LICENCE APPLICATION FOR 70 WAPPING LANE E1W 2RD

I would like to submit the following representation against the above application and argue for extenuating circumstances outside of the regular licensing objectives.

The granting of a premises licence for 70 Wapping Lane will have a significant and detrimental impact on not just the remaining shops on Wapping Lane but across Wapping in general. This includes the shops on Garnet Street, Wapping Wall Wapping High Street. If footfall on Wapping Lane is significantly reduced it could lead to gangs taking over – there have been many issues of drug dealing behind the former bakery in the past 4 years, CCTV was installed but is faulty. The local shops are a lifeline for people in Wapping and is where people meet and chat and without them the strong community spirit in Wapping will disappear.

Since 2018 Wapping Lane has lost 4 shops: a betting shop, a bakery, an Indian Restaurant and a grocery store which was forced to close because of a fire in the flat above. The shops have closed because of financial difficulties, COVID and increased rates and rents. My rent and rates have doubled in the past year. The bakery, which had been there for decades has been vacant since March. The betting shop closed in 2018 and remains vacant as does the restaurant. Wapping Lane is deserted most of the time and if Sainsbury's is allowed to trade there, my shop will be not be able to compete nor Wapping Wines at 101 Wapping Lane and it's unlikely the grocery store will reopen. That would mean a further loss of rents and rates which in turn will make the area poorer in financial, social and economic terms and open it up to more anti-social behaviour.

There are also issues over parking and loading as Wapping Lane is now single lane traffic. If car/van usage increases it could cause traffic issues on the junction of Green Bank, Wapping Lane and Cinnamon Street which is a no entry street. Traffic build up could cause problems for children and the elderly. In the past there was a lollipop lady on the crossing by Wapping Lane shops but the service stopped a few years ago. Buses have difficulties travelling along Wapping Lane since the pavements were widened last year so large lorries making deliveries will cause hold ups.

This application could see the end of Wapping Lane as a shopping area and goes against the Council's policies to reinvigorate local high streets.

Thx

Marie

Sent from my iPhone

Appendix 17

Corinne Holland

From: Natasha Stone <[REDACTED]>
Sent: 03 January 2023 19:17
To: Licensing
Subject: Re: Sainsbury's, 70 Wapping Lane - M/155582

Follow Up Flag: Follow up
Flag Status: Completed

Dear Corinne,

Thanks for your email.

My details are:

Natasha Stone
[REDACTED]

Best wishes,

Natasha

From: Licensing <Licensing@towerhamlets.gov.uk>
Sent: Tuesday, January 3, 2023 5:45:06 PM
To: Natasha Stone [REDACTED]
Subject: Sainsbury's, 70 Wapping Lane - M/155582

Dear Sir/Madam

In order for your representation to be valid you are required to provide your full name and address. These will be forwarded to the applicant at the end of the consultation period where they can contact you to mediate with you to address your concerns.

As the consultation period for this application expired on 29th December 2022 please respond with these details within the next seven days in order for us to consider your representation.

Kind regards

Corinne Holland
Licensing Officer
Environmental Health and Trading Standards
Place Directorate
London Borough of Tower Hamlets
2nd Floor, Mulberry Place
5 Clove Crescent
London
E14 2BG

[REDACTED]
www.towerhamlets.gov.uk

Follow us on:

[Facebook](#) | [Twitter](#) | [LinkedIn](#) | [Instagram](#)

From: Natasha Stone <[REDACTED]>

Sent: 29 December 2022 16:07

To: Licensing <Licensing@towerhamlets.gov.uk>

Subject: Feedback to plans for Wapping Lane supermarket

Dear Sir / Madam,

I write to give feedback re. the proposed new Tesco on Wapping Lane and its alcohol license. I am concerned about this as a local resident and a frequent shopper on Wapping Lane. The shops there are crucial to the community and were particularly so during the pandemic, e.g. many community service efforts from the off-license. I am concerned that these shops will go out of business with a large chain supermarket nearby, and I would like to see smaller, local businesses encouraged. I am also concerned about noise, parking and antisocial behaviour in this key community hub for local residents. Thank you for considering my feedback.

Best wishes,

Natasha

Appendix 18

REPRESENTATION FROM :- [REDACTED], PURNESH PATEL, [REDACTED]
[REDACTED]

AGAINST PREMISES LICENCE APPLICATION FOR :- 70 WAPPING LANE E1W 2RD

I would like to submit the following representation against the above application and argue for extenuating circumstances outside of the regular licensing objectives.

The granting of a premises licence for 70 Wapping Lane will have a significant and detrimental impact on not just my Business but also on the remaining shops on Wapping Lane and across Wapping in general. This includes the shops on Garnet Street, Wapping Wall Wapping High Street. If footfall on Wapping Lane is significantly reduced it could lead to gangs taking over – there have been many issues of drug dealing behind the former bakery in the past 4 years, CCTV was installed but is faulty. The local shops are a lifeline for people in Wapping and is where people meet and chat and without them the strong community spirit in Wapping will disappear.

Since 2018 Wapping Lane has lost 4 shops: a betting shop, a bakery, an Indian Restaurant and a grocery store which was forced to close because of a fire in the flat above. The shops have closed because of financial difficulties, COVID and increased rates and rents. My rent and rates have doubled in the past year. The bakery, which had been there for decades has been vacant since March. The betting shop closed in 2018 and remains vacant as does the restaurant. Wapping Lane is deserted most of the time and if Sainsbury's is allowed to trade there, my shop will be not be able to compete nor Wapping Wines at 101 Wapping Lane and it's unlikely the grocery store will reopen. That would mean a further loss of rents and rates which in turn will make the area poorer in financial, social and economic terms and open it up to more anti-social behaviour.

There are also issues over parking and loading as Wapping Lane is now single lane traffic. If car/van usage increases it could cause traffic issues on the junction of Green Bank, Wapping Lane and Cinnamon Street which is a no entry street. Traffic build up could cause problems for children and the elderly. In the past there was a lollipop lady on the crossing by Wapping Lane shops but the service stopped a few years ago. Buses have difficulties travelling along Wapping Lane since the pavements were widened last year so large lorries making deliveries will cause hold ups.

This application could see the end of Wapping Lane as a shopping area and goes against the Council's policies to reinvigorate local high streets.

Mr Purnesh Patel
[REDACTED]

Appendix 19

Corinne Holland

From: terab ali <[REDACTED]>
Sent: 22 December 2022 00:14
To: Licensing
Subject: RE: Objection: Regarding new Sainsbury's in 70 Wapping Lane E1W

Follow Up Flag: Follow up
Flag Status: Completed

Dear sir/madam

I'm from [REDACTED] I am writing in reference to the following application; CLC/EHTS/LIC/155582 made to Tower Hamlets council on behalf of Sainsbury's supermarkets Ltd and their request for a licence under the licensing act 2003.

As you maybe aware they are attempting to open and operate at 70 Wapping lane, it is my wish to put in a formal letter of discontent and objection to this under the requirements of the planning and licensing laws.

I have several conflictions to your granting of a potential licence, one of which is the over saturation of premises having the ability to sell alcohol in such a small area, current consensus putting the total area of Wapping at just over 5 hectares with a mean population of 10,581 residents in total.

In Wapping lane alone, we have

- 2 off-licences,
- 1 wine and high end spirits seller
- best one supermarket with an alcohol license, • 2 pubs • the old pizza express that has literally been turnt in to another alcohol venue • tobacco dock and its multiple venues and spaces all of which have alcohol licenses.

We currently have all these premises operating with licenses and this is to a ward with 8,809 16-64 year olds that's a 83.3% share of the Wapping area with readily accessible exposure and availability to alcohol a leading cause to the current high rate of property crime we experience in Wapping, as confirmed by the current consensus and freedom of information request and widely available data on tower hamlets own council website under crime and safety section.

These are only but a few of the more pressing issues facing your woeful acceptance of yet another venue selling in the area, furthermore it will be of no benefit to our community, we may be a ward in tower hamlets in the city of London but we are the smallest of all of them and have a more village/ family friendly community vibe going on, we do our best to retain the old east end values of looking after our neighbours especially during Covid when so many was isolated and vulnerable, it's is our feelings that with a supermarket like Sainsbury's being opened and allowed to sell alcohol in our area it will attract more people to the area and inevitably more crime, the numbers of which are easily accessible on the tower hamlets website.

If this does not sway your consciousness then can we think about the religious and youth makeup of the area and how we have 2 churches, a mosque and a community centre and several primary schools in the area, all of which already have to contend with the over saturation of alcohol premises and have a considerable effort to fight against the negative impact and inflictions that currently exist but to subject them further with the granting of the Sainsbury's is moral reprehensible.

In addition to the moral dilemmas Sainsbury's poses there is the added issue of traffic build up and delivery trucks coming and going at all hours causing real time problems for the many key workers and children's sleeping, the very close proximity to social housing and families it will have and how the delivery trucks will prevent resident parking which is already restricted due to the bus gate in current operation which we fought hard to keep as traffic was a

already compelling issue to install a gate in the first place now by your actions is almost like you are dismissing your (tower hamlets council's) own arguments and justifications.

At the existing space of 70 Wapping lane there is no loading bay as it is to provide one will cause an unimaginable amount of damage and distruction to the area not to mention the historic value of the ancient cobble stone roads and the active conservation of the docks and area.

It is my deepest wish that you take all I have said and many other mitigating factors in to consideration and I implore you to side with residents in rejecting the application and withhold any and all licenses you're able to.

Kind regards

Mr Ali Terab

Appendix 20

Corinne Holland

From: Elli Thomas [REDACTED]
Sent: 29 December 2022 15:48
To: Licensing
Subject: CLC/EHTS/LIC/155582

Dear Tower Hamlets licensing,

I'm writing in support of the application CLC/EHTS/LIC/155582 from sainsburys supermarket for licensing for a store at Wapping Lane.

The presence of a sainsburys supermarket and associated license would be a positive thing for the local community in a context where we have limited choices of shops and would enable a much needed amenity and would support more natural footfall on the High Street, increasing natural surveillance and local safety and reducing anti social behaviour.

I look forward to the new license being granted.

Best wishes
Eleri Thomas
[REDACTED]

Appendix 21

Corinne Holland

From: Nicola Cadzow
Sent: 08 February 2023 09:15
To: Robert Botkai; Corinne Holland Licensin
Cc: Andrew Sanders; [REDACTED]
Subject: 155582 New premise license application for Sainsbury's 70 Wapping Lane, London

Good morning Robert,

I can agree to the amendment to the hours as below

1. No collections of waste or recycling materials (including bottles) from the premises shall take place between 22:00 hours and **07:00** hours on the following day.
2. No deliveries to the premises shall take place between 22:00 hours and **07:00** hours the following day.

Licensing, see amendment to conditions above, as agreed with applicant for 07:00 hours (as opposed to 08:00 hours)

regards

Nicola Cadzow
Environmental Protection Officer
Place Directorate

From: Robert Botkai <[REDACTED]>
Sent: Tuesday, February 7, 2023 4:39 PM
To: Nicola Cadzow <[REDACTED]>; Corinne Holland <[REDACTED]>
<Corinne.Holland@[REDACTED]> [Licensing]
Cc: Andrew Sanders <[REDACTED]>
[REDACTED]
Subject: RE: 155582 New premise license application for Sainsbury's 70 Wapping Lane, London

Hi Nicola

Apologies can we amend to be as follows:

1. No collections of waste or recycling materials (including bottles) from the premises shall take place between 22:00 hours and 07:00 hours on the following day.
2. No deliveries to the premises shall take place between 22:00 hours and 07:00 hours the following day.

Many thanks

Robert

From: Nicola Cadzow <[REDACTED]>
Sent: 02 February 2023 10:35
To: Robert Botkai <[REDACTED]>; Corinne Holland <[REDACTED]>; Licensing <[REDACTED]>
>
Cc: Andrew Sanders <[REDACTED]>

[REDACTED]
Subject: 155582 New premise license application for Sainsbury's 70 Wapping Lane, London

This message originated outside Winckworth Sherwood and was sent from email address
[REDACTED]

Good morning Robert,

Having considered your email with regards the conditions I am will to agree to conditions 1 and 2 only, as below:

1. No collections of waste or recycling materials (including bottles) from the premises shall take place between 22:00 hours and 08:00 hours on the following day.
2. No deliveries to the premises shall take place between 22:00 hours and 08:00 hours the following day.

Licensing, please take this as my withdrawing my objection to the new premise license application for Sainsbury's 70 Wapping Lane, London

Kind regards

Nicola Cadzow
Environmental Protection Officer
Place Directorate

From: Robert Botkai [REDACTED]
Sent: Tuesday, January 17, 2023 4:48 PM
To: Nicola Cadzow <[REDACTED]>
Cc: Andrew Sanders [REDACTED]
<[REDACTED]>
Subject: RE: 155582 New premise license application for Sainsbury's 70 Wapping Lane, London

Hi Nicola

Thanks for this.

Condition 3 remains difficult in terms of compliance and enforcement. Its rationale is understood, and our client will ensure that the message is given loud (inside not out) and clear but I am reluctant to recommend a condition which is quite as subjective as this.

Can we agree to proceed with conditions 1 and 2 only please?

Thanks

Robert

From: Nicola Cadzow <[REDACTED]>
Sent: 17 January 2023 14:29
To: Robert Botkai [REDACTED]
Cc: Andrew Sanders [REDACTED]; [REDACTED]
Subject: 155582 New premise license application for Sainsbury's 70 Wapping Lane, London

This message originated outside Winckworth Sherwood and was sent from email address
[REDACTED]

Hi Robert

Happy New Year to you too!

I would be willing to agree to

1. Amending condition 3 to read - No idling of delivery vehicles outside the premises, no drivers shouting or raised voices, nor loud music/radios, whilst the premises is operating.
2. Removed condition 4

Kind regards

Nicola Cadzow
Environmental Protection Officer
Place Directorate

From: Robert Botkai [redacted] >
Sent: Thursday, January 12, 2023 5:37 PM
To: Nicola Cadzow <[redacted]>
Cc: Andrew Sanders [redacted]; [redacted] >
Subject: RE: 155582 New premise license application for Sainsbury's 70 Wapping Lane, London

Hi Nicola

Happy new year!

Have you had the opportunity to look at this please?

Thanks

Robert

From: Robert Botkai
Sent: 29 December 2022 14:35
To: Nicola Cadzow <[redacted]>
Cc: Andrew Sanders <[redacted]>; [redacted]
Subject: 155582 New premise license application for Sainsbury's 70 Wapping Lane, London
Importance: High

Hi Nicola

I hope you enjoyed the Christmas period.

Thank you for your email below addressed to my colleague Andrew Sanders.

Our client can agree the following conditions:

1. No collections of waste or recycling materials (including bottles) from the premises shall take place between 22:00 hours and 08:00 hours on the following day.
2. No deliveries to the premises shall take place between 22:00 hours and 08:00 hours the following day.

Conditions 3 and 4 are more problematic as deliveries are to the front of the store. There is no place for the signage.

Our client would always expect its drivers to be respectful to neighbours.

Can we agree to proceed with the 2 conditions above please?

If we don't speak before, have a very Happy New Year!

Best wishes

Robert

From: Nicola Cadzow [REDACTED]
Sent: 19 December 2022 13:58
To: Andrew Sanders [REDACTED]
Cc: 'MARK.J.Perr [REDACTED] <[REDACTED]>
Subject: 155582 New premise license application for Sainsbury's 70 Wapping Lane, London

[REDACTED]

Good afternoon Mr Sanders,

I am reviewing your client's new premises licence application for Sainsbury's 70 Wapping Lane, London, ref 155405 with particular attention to the licensing objective for the prevention of public nuisance and would ask for the additional noise conditions to apply as below:

1. No collections of waste or recycling materials (including bottles) from the premises shall take place between 22:00 hours and 08:00 hours on the following day.
2. No deliveries to the premises shall take place between 22:00 hours and 08:00 hours the following day.
3. The premises licence holder will display notices requiring drivers of delivery vehicles not to leave vehicle engines idling outside the premises whilst the premises is in operation
4. The premises licence holder will display notices on their premises requesting that delivery drivers remain respectful of neighbours by keeping noise to a minimum whilst waiting outside the premises to collect or make deliveries.

Kind regards

Nicola Cadzow
Environmental Protection Team
Place Directorate
London Borough of Tower Hamlets
Mulberry Place Town Hall
5 Clove Crescent
London E14 2BG

[REDACTED]
www.towerhamlets.gov.uk

Follow us on:
[Facebook](#) | [Twitter](#) | [LinkedIn](#) | [Instagram](#)

Section 61 consent

To apply for all Control of Pollution Act 1974 Section 61 consents, dispensations and variations please apply here: https://www.towerhamlets.gov.uk/ignl/environment_and_waste/environmental_health/pollution/Guidance-for-Section-61-Applications.aspx

Appendix 22

Section 182 Advice by the Home Office Updated on December 2022

Relevant, vexatious and frivolous representations

9.4 A representation is “relevant” if it relates to the likely effect of the grant of the licence on the promotion of at least one of the licensing objectives. For example, a representation from a local businessperson about the commercial damage caused by competition from new licensed premises would not be relevant. On the other hand, a representation by a businessperson that nuisance caused by new premises would deter customers from entering the local area, and the steps proposed by the applicant to prevent that nuisance were inadequate, would be relevant. In other words, representations should relate to the impact of licensable activities carried on from premises on the objectives. For representations in relation to variations to be relevant, they should be confined to the subject matter of the variation. There is no requirement for a responsible authority or other person to produce a recorded history of problems at premises to support their representations, and in fact this would not be possible for new premises.

9.5 It is for the licensing authority to determine whether a representation (other than a representation from responsible authority) is frivolous or vexatious on the basis of what might ordinarily be considered to be vexatious or frivolous. A representation may be considered to be vexatious if it appears to be intended to cause aggravation or annoyance, whether to a competitor or other person, without reasonable cause or justification. Vexatious circumstances may arise because of disputes between rival businesses and local knowledge will therefore be invaluable in considering such matters. Licensing authorities can consider the main effect of the representation, and whether any inconvenience or expense caused by it could reasonably be considered to be proportionate.

9.6 Frivolous representations would be essentially categorised by a lack of seriousness. Frivolous representations would concern issues which, at most, are minor and in relation to which no remedial steps would be warranted or proportionate.

9.7 Any person who is aggrieved by a rejection of their representations on either of these grounds may lodge a complaint through the local authority’s corporate complaints procedure. A person may also challenge the authority’s decision by way of judicial review.

9.8 Licensing authorities should not take decisions about whether representations are frivolous, vexatious or relevant to the licensing objectives on the basis of any political judgement. This may be difficult for councillors who receive complaints from residents within their own wards. If consideration is not to be delegated, contrary to the recommendation in this

Guidance, an assessment should be prepared by officials for consideration by the sub-committee before any decision is taken that necessitates a hearing. Any councillor who considers that their own interests are such that they are unable to consider the matter independently should disqualify themselves.

9.9 It is recommended that, in borderline cases, the benefit of the doubt about any aspect of a representation should be given to the person making that representation. The subsequent hearing would then provide an opportunity for the person or body making the representation to amplify and clarify it.

9.10 Licensing authorities should consider providing advice on their websites about how any person can make representations to them.

Appendix 23

Prevention of Public Nuisance

- 9.1 Licensed premises, especially those operating late at night and in the early hours of the morning, can cause a range of nuisances impacting on people living, working or sleeping in the vicinity of the premises.
- 9.2 The concerns mainly relate to noise nuisance both from the premises and customer egress, light pollution, noxious smells and disruption from parked vehicles and due regard will be taken of the impact these may have in considering a licence. The Licensing Authority will expect Operating Schedules to satisfactorily address these issues. Applicants are advised to seek advice from the Council's Environmental Health Officers before preparing their plans and Schedules.
- 9.3 The Licensing Authority, where its discretion is engaged, will consider, where appropriate, attaching conditions to licences and permissions to prevent the problems identified in Section 18 of this Policy (Special Cumulative Impact Policy for the Brick Lane and Bethnal Green Area), and these may include conditions drawn from the Model Pool of Conditions found in the Secretary of States Guidance.
- 9.4 **Street Furniture** – placing of street furniture, which includes advertising boards, on the highway can cause a public nuisance by way of obstruction, or encourage consumption of alcohol on an unlicensed area. The Licensing Authority expects applicants to have ensured that they fully comply with the Council's rules relating to authorisation of obstructions on the highway, and that the required authorisations are obtained prior to submitting a licence application. Where proportionate and appropriate, and its discretion is engaged, the Licensing Authority will impose conditions in relation to street furniture, including on private land.
- 9.5 **Fly Posting** – The Council has experienced problems with "fly posting" in relation to venues that offer entertainment. Fly posting is the unauthorised posting of posters / advertisements etc. Where it considers it proportionate and appropriate, and its discretion is engaged, the Licensing Authority will attach conditions relating to the control of fly posting to ensure that venues clearly prohibit all fly posting in their contract terms with others and they effectively enforce this control.

Appendix 24

Guidance Issued by the Home Office under Section 182 of the Licensing Act 2003

Updated December 2022

Public nuisance

- 2.15 The 2003 Act enables licensing authorities and responsible authorities, through representations, to consider what constitutes public nuisance and what is appropriate to prevent it in terms of conditions attached to specific premises licences and club premises certificates. It is therefore important that in considering the promotion of this licensing objective, licensing authorities and responsible authorities focus on the effect of the licensable activities at the specific premises on persons living and working (including those carrying on business) in the area around the premises which may be disproportionate and unreasonable. The issues will mainly concern noise nuisance, light pollution, noxious smells and litter.
- 2.16 Public nuisance is given a statutory meaning in many pieces of legislation. It is however not narrowly defined in the 2003 Act and retains its broad common law meaning. It may include in appropriate circumstances the reduction of the living and working amenity and environment of other persons living and working in the area of the licensed premises. Public nuisance may also arise as a result of the adverse effects of artificial light, dust, odour and insects or where its effect is prejudicial to health.
- 2.17 Conditions relating to noise nuisance will usually concern steps appropriate to control the levels of noise emanating from premises. This might be achieved by a simple measure such as ensuring that doors and windows are kept closed after a particular time, or persons are not permitted in garden areas of the premises after a certain time. More sophisticated measures like the installation of acoustic curtains or rubber speaker mounts to mitigate sound escape from the premises may be appropriate. However, conditions in relation to live or recorded music may not be enforceable in circumstances where the entertainment activity itself is not licensable (see chapter 16). Any conditions appropriate to promote the prevention of public nuisance should be tailored to the type, nature and characteristics of the specific premises and its licensable activities. Licensing authorities should avoid inappropriate or disproportionate measures that could deter events that are valuable to the community, such as live music. Noise limiters, for example, are expensive to purchase and install and are likely to be a considerable burden for smaller venues.
- 2.18 As with all conditions, those relating to noise nuisance may not be appropriate in certain circumstances where provisions in other legislation adequately protect those living in the area of the premises. But as stated earlier in this Guidance, the approach of licensing authorities and responsible authorities should be one of prevention and when their powers are engaged, licensing authorities should be aware of the fact that other legislation may not adequately cover concerns raised in relevant representations and additional conditions may be appropriate.

- 2.19 Where applications have given rise to representations, any appropriate conditions should normally focus on the most sensitive period for people being disturbed by unreasonably loud music is at night and into the early morning when residents in adjacent properties may be attempting to go to sleep or are sleeping. This is why there is still a need for a licence for performances of live music between 11 pm and 8 am. In certain circumstances, conditions relating to noise emanating from the premises may also be appropriate to address any disturbance anticipated as customers enter and leave.
- 2.20 Measures to control light pollution will also require careful thought. Bright lighting outside premises which is considered appropriate to prevent crime and disorder may itself give rise to light pollution for some neighbours. Applicants, licensing authorities and responsible authorities will need to balance these issues.
- 2.21 Beyond the immediate area surrounding the premises, these are matters for the personal responsibility of individuals under the law. An individual who engages in anti-social behaviour is accountable in their own right. However, it would be perfectly reasonable for a licensing authority to impose a condition, following relevant representations, that requires the licence holder or club to place signs at the exits from the building encouraging patrons to be quiet until they leave the area, or that, if they wish to smoke, to do so at designated places on the premises instead of outside, and to respect the rights of people living nearby to a peaceful night.

Appendix 25

Licensing Policy, updated November 2018

Crime and Disorder

- 7.1 Licensed premises, especially those offering late night / early morning entertainment, alcohol and refreshment for large numbers of people, can be a source of crime and disorder problems and to store prescribed information.
- 7.2 When addressing crime and disorder the applicant should initially identify any particular issues (having regard to their particular type of premises and / or activities) which are likely to adversely affect the promotion of the crime and disorder licensing objective. Such steps as are required to deal with these identified issues should be included within the applications operating schedule. Where the Metropolitan Police, acting as a responsible authority, makes recommendations in respect of an application relating to the licensing objectives the Licensing Authority would expect the applicant to incorporate these into their operating schedule.
- 7.3 Applicants are recommended to seek advice from Council Officers and the Police as well as taking into account, as appropriate, local planning and transport policies, with tourism, cultural and crime prevention strategies, when preparing their plans and Schedules.
- 7.4 In addition to the requirements for the Licensing Authority to promote the licensing objectives, it also has duties under Section 17 of the Crime and Disorder Act 1998 to do all it reasonably can to prevent crime and disorder in the Borough and to share prescribed information.
- 7.5 The Licensing Authority, if its discretion is engaged, will consider attaching Conditions to licences and permissions to deter and prevent crime and disorder both inside and immediately outside the premises and these may include Conditions drawn from the Model Pool of Conditions relating to Crime and Disorder given in the Secretary of State's Guidance.
- 7.6 **CCTV** - The Licensing Authority, if its discretion is engaged, will attach conditions to licences, as appropriate where the conditions reflect local crime prevention strategies, for example the provision of closed circuit television cameras.

7.7 **Touting** – This is soliciting for custom. There has been a historic problem with Touting in the borough, mainly in relation to restaurants, and as such in 2006 the Council introduced a byelaw under Section 235 of the Local Government Act 1972 for the good rule and government of the London Borough of Tower Hamlets and for the prevention and suppression of nuisances.

As a result, in relation to premises where there is intelligence that touting is, or has been carried out, the Licensing Authority, where its discretion is engaged will insert a standard condition that prohibits 'touting' as follows:-

- 1) No person shall be employed to solicit for custom or be permitted to solicit for custom for business for the premises in any public place within a 500 meters radius of the premises as shown edged red on the attached plan.(marked as Appendix -)
- 2) Clear Signage to be placed in the restaurant windows stating that the premises supports the Council's 'No Touting' policy.

7.8 **Responsible Drinking** - The Licensing Authority expects alcohol to be promoted in a responsible way in the Borough. This should incorporate relevant industry standards, such as the Portman Group Code of Practice. Where appropriate and proportionate, if its discretion is engaged, the Licensing Authority will apply conditions to ensure responsible drinking. The Licensing Authority also recognises the positive contribution to best practice that "Pubwatch" and other similar schemes can make in promoting the licensing objectives and is committed to working with them.

Model Pool Conditions can be found in the Secretary of State's Guidance.

7.9 **Criminal Activity** - There is certain criminal activity that may arise in connection with licensed premises which the Licensing Authority will treat particularly seriously. These are the use of the licensed premises:

- for the sale and distribution of drugs controlled under the Misuse of Drugs Act 1971 and the laundering of the proceeds of drugs crime;
- for the sale and distribution of illegal firearms;
- for the evasion of copyright in respect of pirated or unlicensed films and music, which does considerable damage to the industries affected;
- for the illegal purchase and consumption of alcohol by minors which impacts on the health, educational attainment, employment prospects and propensity for crime of young people;
- for prostitution or the sale of unlawful pornography;
- by organised groups of paedophiles to groom children;

- as the base for the organisation of criminal activity, particularly by gangs;
- for the organisation of racist activity or the promotion of racist attacks;
- for employing a person who is disqualified from that work by reason of their immigration status in the UK;
- for unlawful gambling; and
- for the sale or storage of smuggled tobacco and alcohol.

The Secretary State's Guidance states that it is envisaged that licensing authorities, the police, the Home Office (Immigration Enforcement) and other law enforcement agencies, which are responsible authorities, will use the review procedures effectively to deter such activities and crime. Where reviews arise and this Licensing Authority determines that the crime prevention objective is being undermined through the premises being used to further crimes, it is expected that revocation of the licence, even in the first instance, should be seriously considered.

7.10 In particular the Licensing Authority is mindful of the Secretary of State's Guidance "Reviews arising in connection with crime".

7.11 From 1 April 2017, businesses which sell alcohol (for example, retailers of alcohol and trade buyers) will need to ensure that the UK wholesalers that they buy alcohol from have been approved by HMRC under the Alcohol Wholesaler Registration Scheme (AWRS). They will need to check their wholesalers Unique Registration Number (URN) against the HMRC online database which will be available from April 2017. This is an ongoing obligation and if a business is found to have bought alcohol from an unapproved wholesaler, they may be liable to a penalty or could even face criminal prosecution and their alcohol stock may be seized. Any trader who buys alcohol from a wholesaler for onward sale to the general public (known as a 'trade buyer') does not need to register unless they sell alcohol to other businesses. Examples of trade buyers would be pubs, clubs, restaurants, cafes, retailers and hotels. However, they will need to check that the wholesaler they purchase alcohol from is registered with HMRC. Further information may be found at: <https://www.gov.uk/guidance/the-alcohol-wholesaler-registration-scheme-awrs>.

Smuggled goods

7.12 The Licensing Authority will exercise its discretion to add a standard condition as follows:-

- 1) The premises licence holder and any other persons responsible for the purchase of stock shall not purchase any goods from door-to-door sellers other than from established traders who provide full receipts at the time of delivery to provide traceability.
- 2) The premises licence holder shall ensure that all receipts for goods bought include the following details:
 - i. Seller's name and address
 - ii. Seller's company details, if applicable
 - iii. Seller's VAT details, if applicable
 - iv. Vehicle registration detail, if applicable
- 3) Legible copies of the documents referred to in 2) shall be retained on the premises and made available to officers on request.
- 4) The trader shall obtain and use a UV detection device to verify that duty stamps are valid.
- 5) Where the trader becomes aware that any alcohol may be not duty paid they shall inform the Police of this immediately.

Olympic Park – Football Ground

7.13 Premises where Police intelligence shows that football supporters congregate within the borough should consider in their application form the following conditions:

- 1) On Match Days for premises licensed for the supply of alcohol for consumption on the premises:
 - a) Drinks shall only be supplied in polypropylene or similar plastic and all bottled drinks shall be poured into such drinking vessels before being handed to the customer. These should be made of recyclable materials.
 - b) Registered door staff shall be employed to control the entry and exits to the premises and to manage any licensed outside area(s).

Appendix 26

Guidance Issued by the Home Office under Section 182 of the Licensing Act 2003

Updated December 2022

Crime and disorder

- 2.1 Licensing authorities should look to the police as the main source of advice on crime and disorder. They should also seek to involve the local Community Safety Partnership (CSP).
- 2.2 In the exercise of their functions, licensing authorities should seek to co-operate with the Security Industry Authority (“SIA”) as far as possible and consider adding relevant conditions to licences where appropriate. The SIA also plays an important role in preventing crime and disorder by ensuring that door supervisors are properly licensed and, in partnership with police and other agencies, that security companies are not being used as fronts for serious and organised criminal activity. This may include making specific enquiries or visiting premises through intelligence led operations in conjunction with the police, local authorities and other partner agencies. Similarly, the provision of requirements for door supervision may be appropriate to ensure that people who are drunk, drug dealers or people carrying firearms do not enter the premises and ensuring that the police are kept informed.
- 2.3 Conditions should be targeted on deterrence and preventing crime and disorder including the prevention of illegal working in licensed premises (see paragraph 10.10). For example, where there is good reason to suppose that disorder may take place, the presence of closed-circuit television (CCTV) cameras both inside and immediately outside the premises can actively deter disorder, nuisance, anti-social behaviour and crime generally. Some licence holders may wish to have cameras on their premises for the prevention of crime directed against the business itself, its staff, or its customers. But any condition may require a broader approach, and it may be appropriate to ensure that the precise location of cameras is set out on plans to ensure that certain areas are properly covered and there is no subsequent dispute over the terms of the condition.
- 2.4 The inclusion of radio links and ring-round phone systems should be considered an appropriate condition for public houses, bars and nightclubs operating in city and town centre leisure areas with a high density of licensed premises. These systems allow managers of licensed premises to communicate instantly with the police and facilitate a rapid response to any disorder which may be endangering the customers and staff on the premises.

- 2.5 Conditions relating to the management competency of designated premises supervisors should not normally be attached to premises licences. It will normally be the responsibility of the premises licence holder as an employer, and not the licensing authority, to ensure that the managers appointed at the premises are competent and appropriately trained. The designated premises supervisor is the key person who will usually be responsible for the day to day management of the premises by the premises licence holder, including the prevention of disorder. A condition of this kind may only be justified as appropriate in rare circumstances where it can be demonstrated that, in the circumstances associated with particular premises, poor management competency could give rise to issues of crime and disorder and public safety.
- 2.6 The prevention of crime includes the prevention of immigration crime including the prevention of illegal working in licensed premises. Licensing authorities should work with Home Office Immigration Enforcement, as well as the police, in respect of these matters. Licence conditions that are considered appropriate for the prevention of illegal working in licensed premises might include requiring a premises licence holder to undertake right to work checks on all staff employed at the licensed premises or requiring that evidence of a right to work check, either physical or digital (e.g. a copy of any document checked as part of a right to work check or a clear copy of the online right to work check) are retained at the licensed premises.

Appendix 27

Anti-Social Behaviour from Patrons Leaving the Premises

General Advice

Members need to bear in mind that once patrons have left a premises they are no longer under direct control. Members will need to be satisfied that there is a link between the way the premises is operating and the behaviour that is complained of. An example of this would be that irresponsible drinking is being encouraged. Before deciding that any particular licensing conditions are proportionate, Members will also need to be satisfied that other legislation is not a more effective route. For example, if the problem is drinking in the street it may be that the Council should designate the area as a place where alcohol cannot be consumed in public.

Members may also wish to consider whether the hours of opening relate to any problems of anti-social behaviour.

If Members believe that there is a substantial problem of anti-social behaviour and it cannot be proportionately addressed by licensing conditions they should refuse the application.

Licensing Policy

The policy recognises that other legislation or measures may be more appropriate but also states that licensing laws are “a key aspect of such control and will always be part of an overall approach to the management of the evening and night time economy” (**see Section 4.15 and 4.16 of the Licensing Policy**).

The Licensing Authority expects the applicant to have addressed all crime and disorder issues relating to the premises in their operating schedule and to have sought appropriate advice. (**See Sections 6.2 of the Licensing Policy**)

The Licensing Authority will consider attaching conditions to deter crime and disorder and these may include Conditions drawn from the Model Poll of Conditions relating to Crime and Disorder. (**See Appendix 3 of the Licensing Policy**). In particular Members may wish to consider (this list is not exhaustive):

- Bottle Bans
- Plastic containers
- CCTV (outside the premises)
- Restrictions on open containers for “off sales”
- Proof of Age scheme
- Crime prevention notices
- Drinks promotions-aimed at stopping irresponsible promotions
- Signage

Cumulative Impact

There is a process by which the Licensing Authority can determine that an area is saturated following representations. However, the process for this involves wide consultation and cannot come from representations about a particular application. (**See Section 8 of the Licensing Policy**).

Police Powers

The Licensing Act 2003, Part 8 gives a senior police officer the power to close a premises for up to 24 hours where the officer believes there is, or is likely to be disorder on or in the vicinity and closure is necessary in the interests of public.

Guidance Issued under Section 182 of the Licensing Act 2003

The key role of the Police is acknowledged (2.1).

Conditions attached to licences cannot seek to manage the behaviour of customers once they are beyond the direct management of the licence holder, but can relate to the immediate vicinity of the premises as they seek entry or leave (1.16).

Conditions are best targeted on deterrence and preventing crime and disorder (2.3) CCTV inside & out, communication, police liaison, no glasses are all relevant

There is also guidance issued around public nuisance (2.15 – 2.21).

The pool of conditions, adopted by the Council is recommended (see Appendix 3 of the Licensing Policy). Licence conditions should not duplicate other legislation (1.16).

Necessary and appropriate conditions should normally focus on the most sensitive periods and may address disturbance as customers enter or leave the premises but it is essential that conditions are focused on measures within the direct control of the licence holder (2.18/2.21).

Licensing law is not the primary mechanism for the general control of nuisance and anti-social behaviour by individuals once they are away from the licensed premises and, therefore, beyond the direct control of the individual, club or business holding the licence, certificate or authorisation concerned (14.13).

Other Legislation

Crime and Disorder Act 1998

The Council has a duty under Section 17 of the Crime and Disorder Act 1998 to do all it reasonably can to prevent crime and disorder.

The Act also introduced a wide range of measures designed to address anti-social behaviour committed by adults and young people. These include:

- Anti-Social Behaviour Orders
- Child Curfew Schemes
- Truancy
- Parenting Orders
- Reparation Orders
- Tackling Racism

Appendix 28

Public Safety

- 8.1 The 2003 Act covers a wide range of premises that require a licence, and so such premises present a mixture of risks to users and should be constructed or adapted and operated so as to acknowledge and safeguard occupants against these risks.
- 8.2 The Licensing Authority will expect Operating Schedules to satisfactorily address these issues and applicants are advised to seek advice from the Council's Environmental Health (Health & Safety) Officers and the London Fire Brigade before preparing their plans and Schedules.
- 8.3 Where an applicant identifies an issue in regard to public safety (including fire safety) which is not covered by existing legislation, the applicant should identify in their operating schedule the steps that will be taken to ensure public safety. This needs to take into account any unique characteristics that arise in connection with the licensable activity, any requirements that are specific to the premises.
- 8.4 One of the Council's Community Safety Partnership Priorities is tackling violence against women and girls. As a result the Licensing Authority expects Licence holders to take a proactive approach to customer safety including the following:
- Making provisions to ensure that customers safely leave their premises, for example providing information on licensed taxi companies, adequate lighting outside the premises,
 - Training of staff in spotting signs of harassment, and how to intervene where safe and appropriate to do so, and/or reporting such harassment to management/emergency services.

The Licensing Authority may be able to sign post Licence Holders in regards to local/national safeguarding schemes which may assist with the above.

- 8.5 The Licensing Authority, where its discretion is engaged, will consider attaching proportionate and appropriate Conditions to licences and permissions to promote safety, and these may include Conditions drawn from a the Model Pool of Conditions found in the Secretary of States Guidance.
- 8.6 The Licensing Authority will impose conditions that relate to its licensing objectives, and in a way that is proportionate to the individual circumstances of the premises seeking a licence.

Appendix 29

Public safety

- 2.7 Licence holders have a responsibility to ensure the safety of those using their premises, as a part of their duties under the 2003 Act. This concerns the safety of people using the relevant premises rather than public health which is addressed in other legislation. Physical safety includes the prevention of accidents and injuries and other immediate harms that can result from alcohol consumption such as unconsciousness or alcohol poisoning. Conditions relating to public safety may also promote the crime and disorder objective as noted above. There will of course be occasions when a public safety condition could incidentally benefit a person's health more generally, but it should not be the purpose of the condition as this would be outside the licensing authority's powers (be ultra vires) under the 2003 Act. Conditions should not be imposed on a premises licence or club premises certificate which relate to cleanliness or hygiene.
- 2.8 A number of matters should be considered in relation to public safety. These may include:
- Fire safety;
 - Ensuring appropriate access for emergency services such as ambulances;
 - Good communication with local authorities and emergency services, for example communications networks with the police and signing up for local incident alerts (see paragraph 2.4 above);
 - Ensuring the presence of trained first aiders on the premises and appropriate first aid kits;
 - Ensuring the safety of people when leaving the premises (for example, through the provision of information on late-night transportation);
 - Ensuring appropriate and frequent waste disposal, particularly of glass bottles;
 - Ensuring appropriate limits on the maximum capacity of the premises (see paragraphs 2.12-2.13, and Chapter 10; and
 - Considering the use of CCTV in and around the premises (as noted in paragraph 2.3 above, this may also assist with promoting the crime and disorder objective).
- 2.9 The measures that are appropriate to promote public safety will vary between premises and the matters listed above may not apply in all cases. As set out in Chapter 8 (8.38-8.46), applicants should consider when making their application which steps it is appropriate to take to promote the public safety objective and demonstrate how they achieve that.

Ensuring safe departure of those using the premises

- 2.10 Licence holders should make provision to ensure that premises users safely leave their premises. Measures that may assist include:
- Providing information on the premises of local taxi companies who can provide safe transportation home; and
 - Ensuring adequate lighting outside the premises, particularly on paths leading to and from the premises and in car parks.

Maintenance and repair

- 2.11 Where there is a requirement in other legislation for premises open to the public or for employers to possess certificates attesting to the safety or satisfactory nature of certain equipment or fixtures on the premises, it would be inappropriate for a licensing condition to require possession of such a certificate. However, it would be permissible to require as a condition of a licence or certificate, if appropriate, checks on this equipment to be conducted at specified intervals and for evidence of these checks to be retained by the premises licence holder or club provided this does not duplicate or gold-plate a requirement in other legislation. Similarly, it would be permissible for licensing authorities, if they receive relevant representations from responsible authorities or any other persons, to attach conditions which require equipment of particular standards to be maintained on the premises. Responsible authorities – such as health and safety authorities – should therefore make their expectations clear in this respect to enable prospective licence holders or clubs to prepare effective operating schedules and club operating schedules.

Safe capacities

- 2.12 “Safe capacities” should only be imposed where appropriate for the promotion of public safety or the prevention of disorder on the relevant premises. For example, if a capacity has been imposed through other legislation, it would be inappropriate to reproduce it in a premises licence. Indeed, it would also be wrong to lay down conditions which conflict with other legal requirements. However, if no safe capacity has been imposed through other legislation, a responsible authority may consider it appropriate for a new capacity to be attached to the premises which would apply at any material time when the licensable activities are taking place and make representations to that effect. For example, in certain circumstances, capacity limits may be appropriate in preventing disorder, as overcrowded venues can increase the risks of crowds becoming frustrated and hostile.
- 2.13 The permitted capacity is a limit on the number of persons who may be on the premises at any time, following a recommendation by the relevant fire and rescue authority under the Regulatory Reform (Fire Safety) Order 2005. For any application for a premises licence or club premises certificate for premises without an existing permitted capacity where the applicant wishes to take advantage of the special provisions set out in section 177 of the 2003 Act¹, the applicant should conduct their own risk assessment as to the appropriate capacity of the premises. They should send their recommendation to the fire and rescue authority which will consider it and decide what the “permitted capacity” of

¹ S 177 of the 2003 Act now only applies to performances of dance.

those premises should be.

- 2.14 Public safety may include the safety of performers appearing at any premises, but does not extend to the prevention of injury from participation in a boxing or wrestling entertainment.

Appendix 30

Licensing Policy Relating to Hours of Trading

All applications have to be considered on their own merits.

The Council has however adopted a set of framework hours as follows:

- Monday to Thursday, from 06:00 hrs to 23:30 hrs
- Friday and Saturday, from 06:00 hrs to 00:00 hrs (midnight)
- Sunday, from 06:00 hrs to 22:30 hrs

(see 14.8 of the Licensing Policy)

In considering the applicability of framework hours to any particular application regard should be had to the following

- Location
- Proposed hours of regulated activities, and the proposed hours the premises are open to the public
- The adequacy of the applicant's proposals to deal with issues of crime and disorder and public nuisance
- Previous history
- Access to public transport
- Proximity to other licensed premises, and their hours

(See 14.9 of the licensing policy)

Subject to any representations to the contrary in individual cases the following premises are not generally considered to contribute to late night anti-social behaviour and will therefore generally have greater freedom

- Theatres
- Cinemas
- Premises with club premises certificates

Appendix 31

Planning

An application for a Premises Licence can be made in respect of a premises even where the premises does not have relevant Planning Permission. That application has to be considered and Members can only refuse the application where the application itself does not promote one of more of the Licensing Objectives. Members cannot refuse just because there is no planning permission. Where a Premises Licence is granted and which exceeds what is allowed by the Planning Permission and that Premises then operates in breach of planning then the operator would be liable to enforcement by Planning.