

# Appendix 1



\* required information

## Section 1 of 9

You can save the form at any time and resume it later. You do not need to be logged in when you resume.

System reference

Not Currently In Use

This is the unique reference for this application generated by the system.

Your reference

31 October 2021

You can put what you want here to help you track applications if you make lots of them. It is passed to the authority.

Are you an agent acting on behalf of the applicant?

- Yes  No

Put "no" if you are applying on your own behalf or on behalf of a business you own or work for.

### Applicant Details

First name

Ivaylo

Family name

Manev

E-mail address

[REDACTED]

Main telephone number

[REDACTED]

Include country code.

Other telephone number

[REDACTED]

- Indicate here if you would prefer not to be contacted by telephone

Are you:

- Applying as a business or organisation, including as a sole trader  
 Applying as an individual

A sole trader is a business owned by one person without any special legal structure. Applying as an individual means you are applying so you can be employed, or for some other personal reason, such as following a hobby.

### Applicant Business

Is your business registered in the UK with Companies House?

- Yes  No

Note: completing the Applicant Business section is optional in this form.

Registration number

03826120

Business name

93 Feet East Ltd.

If your business is registered, use its registered name.

VAT number

GB 744-2665-24

Put "none" if you are not registered for VAT.

Legal status

Private Limited Company

*Continued from previous page...*

Your position in the business

Home country

The country where the headquarters of your business is located.

**Registered Address**

Address registered with Companies House.

Building number or name

Street

District

City or town

County or administrative area

Postcode

Country

**Section 2 of 9**

**APPLICATION DETAILS** ([See also guidance on completing the form, general notes and note 1](#))

Have you had any previous or maiden names?

- Yes  No

Your date of birth

Applicant must be 18 years of age or older

National Insurance number

This box need not be completed if you are an individual not liable to pay UK national insurance.

Place of birth

**Correspondence Address**

Is the address the same as (or similar to) the address given in section one?

- Yes  No

If "Yes" is selected you can re-use the details from section one, or amend them as required. Select "No" to enter a completely new set of details.

Building number or name

Street

District

City or town

County or administrative area

Postcode

Country

Continued from previous page...

### Additional Contact Details

Are the contact details the same as (or similar to) those given in section one?

If "Yes" is selected you can re-use the details from section one, or amend them as required. Select "No" to enter a completely new set of details.

- Yes  No

Telephone number

Other telephone number

### Section 3 of 9

#### THE PREMISES

I, the proposed user, hereby give notice under section 100 of the Licensing Act 2003 of my proposal to carry out a temporary activity at the premises described below.

Give the address of the premises where you intend to carry on the licensable activities or if it has no address give a detailed description (including the Ordnance Survey references). [\(See also guidance on completing the form, note 2\)](#)

Does the premises have an address?

- Yes  No

#### Address

Is the address the same as (or similar to) the address given in section one?

If "Yes" is selected you can re-use the details from section one, or amend them as required. Select "No" to enter a completely new set of details.

- Yes  No

Building number or name

Street

District

City or town

County or administrative area

Postcode

Country

Does a premises licence or club premises certificate have effect in relation to the premises (or any part of the premises)?

- Neither  Premises licence  Club premises certificate

Premises licence number

#### Location Details

Provide further details about the location of the event

Main Bar, Live Room, Private Rooms, Garden.

*Continued from previous page...*

If you intend to use only part of the premises at this address or intend to restrict the area to which this notice applies, give a description and details below ([see also guidance on completing the form, note 3](#))

Describe the nature of the premises below ([see also guidance on completing the form, note 4](#))

Bar, club, and live music.

Describe the nature of the event below ([see also guidance on completing the form, note 5](#))

Playing Disco, House, Techno and Funky House.

#### Section 4 of 9

#### LICENSABLE ACTIVITIES

State the licensable activities that you intend to carry on at the premises

([see also guidance on completing the form, note 6](#)):

- The sale by retail of alcohol
  
- The supply of alcohol by or on behalf of a club to, or to the order of, a member of the club
  
- The provision of regulated entertainment
- The provision of late night refreshment
- The giving of a late temporary event notice

Late notices can be given no later than 5 working days but no earlier than 9 working days before the event.

([See also guidance on completing the form, note 7](#)).

#### Event Dates

There must be a period of at least 10 working days between the date you submit this form and the date of the earliest event when you will be using these premises for licensable activities.

State the dates on which you intend to use these premises for licensable activities

([see also guidance on completing the form, note 8](#))

Event start date

31	/	10	/	2021
dd		mm		yyyy

The maximum period for using premises for licensable activities under the authority of a temporary event notice is 168 hours or seven days.

Event end date

31	/	10	/	2021
dd		mm		yyyy

*Continued from previous page...*

State the times during the event period that you propose to carry on licensable activities (give times in 24 hour clock) [\(see also guidance on completing the form, note 9\)](#)

From 01:00h on the 31/10/21 to 05:30h on the 31/10/21  
From 22:30h on the 31/10/21 to 23:55h on the 31/10/21

State the maximum number of people at any one time that you intend to allow to be present at the premises during the times when you intend to carry on licensable activities, including any staff, organisers or performers [\(see also guidance on completing the form, note 10\)](#)

499

Note that the maximum number of people cannot exceed 499.

If the licensable activities will include the supply of alcohol, state whether the supplies will be for consumption on or off the premises, or both [\(see also guidance on completing the form, note 11\)](#):

- On the premises only
- Off the premises only
- Both

### Section 5 of 9

#### RELEVANT ENTERTAINMENT [\(See also guidance on completing the form, note 12\)](#)

State if the licensable activities will include the provision of relevant entertainment. If so, state the times during the event period that you propose to provide relevant entertainment

From 01:00h on the 31/10/21 to 05:30h on the 31/10/21  
From 22:30h on the 31/10/21 to 23:55h on the 31/10/21

### Section 6 of 9

#### PERSONAL LICENCE HOLDERS [\(See also guidance on completing the form, note 13\)](#)

Do you currently hold a valid personal licence?  Yes  No

Provide the details of your personal licence below.

Issuing licensing authority

Licence number

Date of issue  /  /   
dd mm yyyy

*Continued from previous page...*

Date of expiry

29	/	10	/	2023
dd		mm		yyyy

Any further relevant details

N/A
-----

### Section 7 of 9

#### PREVIOUS TEMPORARY EVENT NOTICES [\(See also guidance on completing the form, note 14\)](#)

Have you previously given a temporary event notice in respect of any premises for events falling in the same calendar year as the event for which you are now giving this temporary event notice?

Yes  No

Have you already given a temporary event notice for the same premises in which the event period:

- a) Ends 24 hours or less before; or  
b) Begins 24 hours or less after the event period proposed in this notice?
- Yes  No

### Section 8 of 9

#### ASSOCIATES AND BUSINESS COLLEAGUES [\(See also guidance on completing the form, note 15\)](#)

Has any associate of yours given a temporary event notice for an event in the same calendar year as the event for which you are now giving a temporary event notice?

Yes  No

Has any associate of yours already given a temporary event notice for the same premises in which the event period:

- a) Ends 24 hours or less before; or  
b) Begins 24 hours or less after the event period proposed in this notice?
- Yes  No

*Continued from previous page...*

Has any person with whom you are in business carrying on licensable activities given a temporary event notice for an event in the same calendar year as the event for which you are now giving a temporary event notice?  Yes  No

Has any person with whom you are in business carrying on licensable activities already given a temporary event notice for the same premises in which the event period:  
a) Ends 24 hours or less before; or  
b) Begins 24 hours or less after the event period proposed in this notice?  Yes  No

**Section 9 of 9**

**CONDITION** [\(See also guidance on completing the form, note 17\)](#)

It is a condition of this temporary event notice that where the relevant licensable activities described in Sections 4 and 5 above include the supply of alcohol that all such supplies are made by or under the authority of the premises user.

**PAYMENT DETAILS**

This fee must be paid to the authority. If you complete the application online, you must pay it by debit or credit card.  
This formality requires a fixed fee of £21

**DECLARATION** [\(See also guidance on completing the form, note 18\)](#)

- \* The information contained in this form is correct to the best of my knowledge and belief
- \* I understand that it is an offence:
  - \* (i) to knowingly or recklessly make a false statement in connection with this temporary event notice and that a person is liable on conviction for such an offence to a fine up to level 5 on the standard scale; and
  - \* (ii) to permit an unauthorised licensable activity to be carried on at any place and that a person is liable on conviction for any such offence to a fine not exceeding £20,000, or to imprisonment for a term not exceeding six months, or to both
- \* ..... For completion by the Licensing Authority .....
- \* ..... I acknowledge receipt of this temporary event notice .....
- \* SIGNATURE \_\_\_\_\_ On behalf of the Licensing Authority NAME OF OFFICER \_\_\_\_\_  
DATE \_\_\_\_\_
- Ticking this box indicates you have read and understood the above declaration

This section should be completed by the applicant, unless you answered "Yes" to the question "Are you an agent acting on behalf of the applicant?"

Full name



Continued from previous page...

Capacity

Date  /  /   
dd mm yyyy

Once you're finished you need to do the following:

1. Save this form to your computer by clicking file/save as...
2. Go back to <https://www.gov.uk/apply-for-a-licence/temporary-event-notice/tower-hamlets/apply-1> to upload this file and continue with your application.

Don't forget to make sure you have all your supporting documentation to hand.

**OFFICE USE ONLY**

Applicant reference number

Fee paid

Payment provider reference

ELMS Payment Reference

Payment status

Payment authorisation code

Payment authorisation date

Date and time submitted

Approval deadline

Error message

Is Digitally signed

< Previous [1](#) [2](#) [3](#) [4](#) [5](#) [6](#) [7](#) [8](#) [9](#) Next >



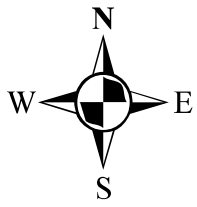

# Appendix 2

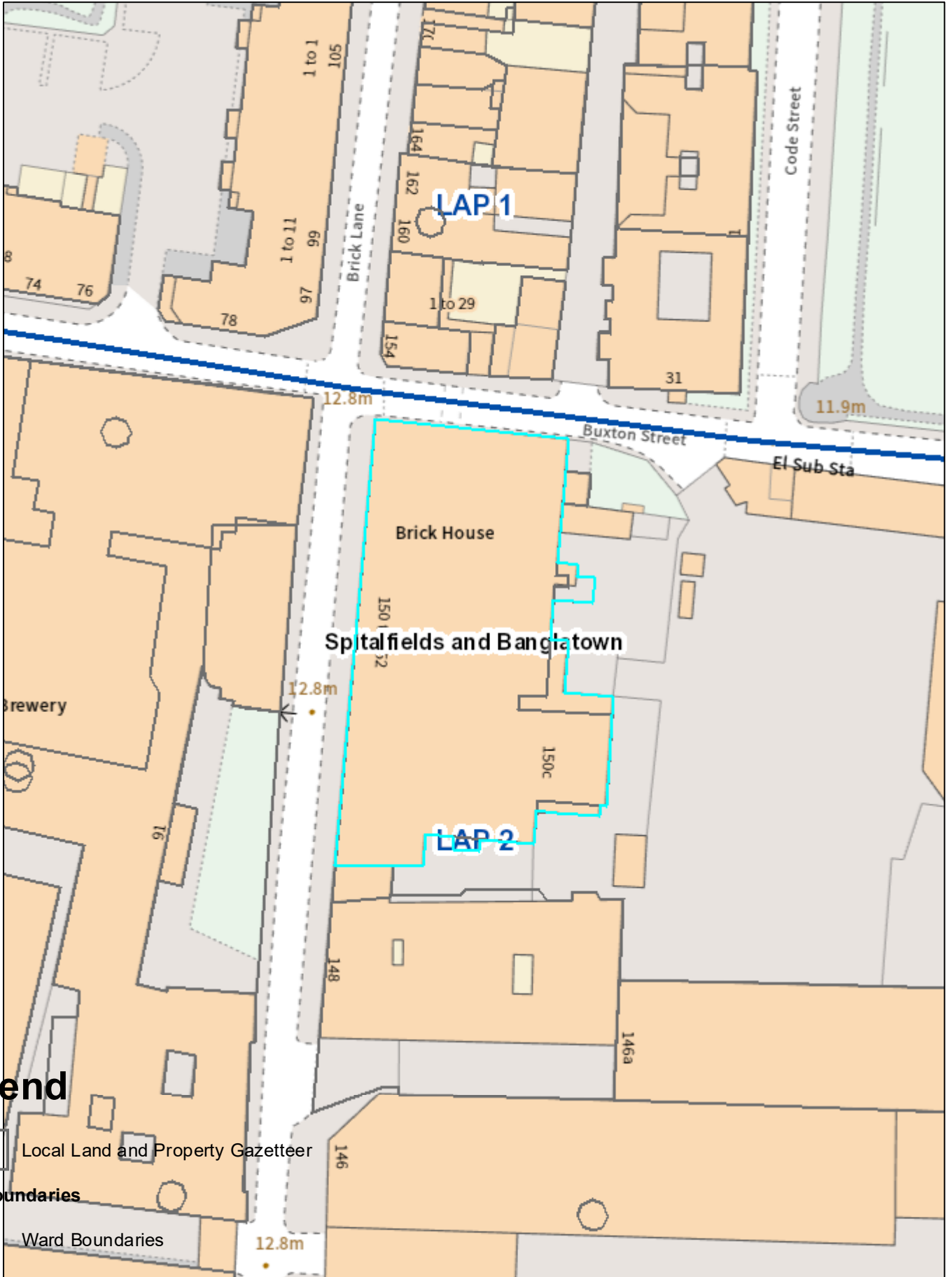

# 150 Brick Lane



## Legend

-  Local Land and Property Gazetteer
-  Ward Boundaries
-  Ward Boundaries
-  LAP Boundaries

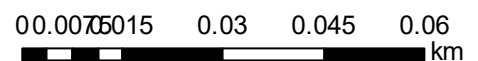

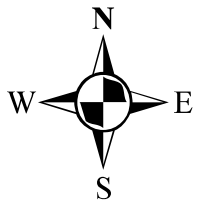

# 150 Brick Lane

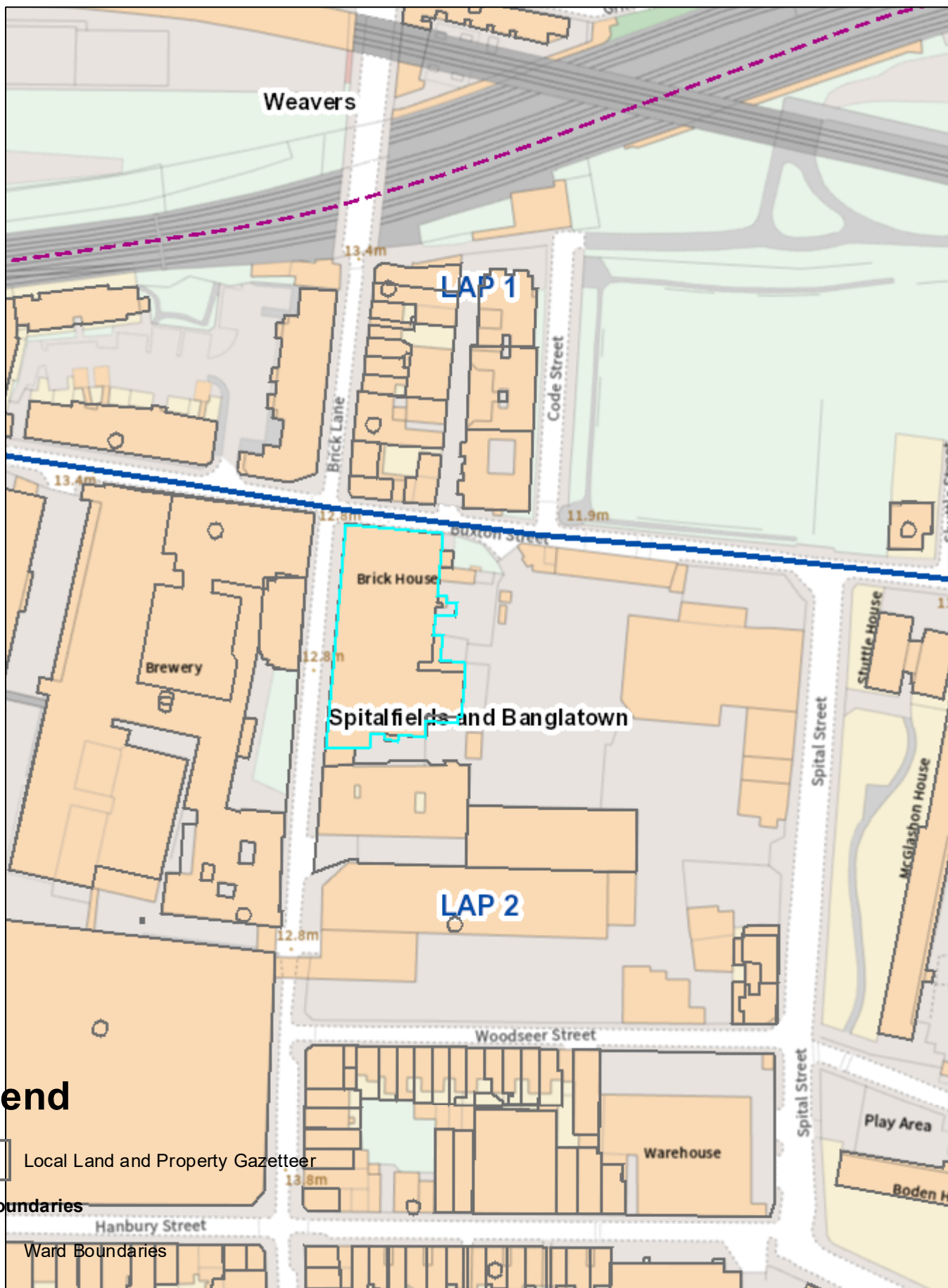

## Legend

Local Land and Property Gazetteer

### Ward Boundaries

Ward Boundaries

### LAP Boundaries

LAP Boundaries

0 0.015 0.03 0.06 0.09 0.12 km

# Appendix 3

**(93 Feet East)  
150-152 Brick Lane  
London  
E1 6RU**

**Licensable Activities authorised by the licence**

The sale by retail of alcohol  
The provision of regulated entertainment  
The provision of late night refreshment

**See the attached licence for the licence conditions**

**Signed by**

**John McCrohan**   
**Trading Standards and Licensing Manager**

**Date: 3<sup>rd</sup> March 2009  
Amended 17<sup>th</sup> May 2013 at Court Hearing**



LICENSING ACT 2003

**Part A - Format of premises licence**

Premises licence number

16987

**Part 1 - Premises details**

**Postal address of premises, or if none, ordnance survey map reference or description**

150-152 Brick Lane

**Post town**

London

**Post code**

E1 6RU

**Tele hone number**

**Where the licence is time limited the dates**

N/A

**Licensable activities authorised by the licence**

The sale by retail of alcohol

The provision of regulated entertainment

The provision of late night refreshment

**The times the licence authorises the carrying out of licensable activities**

**The sale by retail of alcohol**

Monday to Thursday 10:00 hrs to 23:00 hrs

Friday & Saturday 10:00 hrs to 01:30 hrs

Sunday 10:00 hrs to 22:30 hrs

**The provision of regulated entertainment**

Consisting of: Films; Indoor sporting events; Live music; Recorded music; Performances of dance; Anything similar to the aforementioned; Provision of facilities for making music; Provision of facilities for dancing; Provision of facilities for entertainment of a similar description to that of making music or dancing:-

Monday to Thursday 10:00 hrs to 23:00 hrs

Friday & Saturday 10:00 hrs to 01:30 hrs

Sunday 10:00 hrs to 22:30 hrs

**The provision of late night refreshment**

Friday & Saturday until 01:30 hrs

**The opening hours of the premises**

Monday to Thursday 09:00 hrs to 23:30 hrs

Friday & Saturday 09:00 hrs to 02:00 hrs

Sunday 09:00 hrs to 23:00 hrs

**Where the licence authorises supplies of alcohol whether these are on and/ or off supplies**

On and off sales



## **Part 2**

**Name, (registered) address, telephone number and email (where relevant) of holder of premises licence**

93 Feet East Ltd  
150-152 Brick Lane  
London  
E1 6RU

**Registered number of holder, for example company number, charity number (where applicable)**

Not applicable

**Name, address and telephone number of designated premises supervisor where the premises licence authorises the supply of alcohol**

Mr Iva lo Manev



**Personal licence number and issuing authority of personal licence held by designated premises supervisor where the premises licence authorises for the supply of alcohol**

Licence No: 046516  
Issuing Authority: The London Borough of Redbridge

## **Annex 1 - Mandatory conditions**

1.

- (1) The responsible person shall take all reasonable steps to ensure that staff on relevant premises do not carry out, arrange or participate in any irresponsible promotions in relation to the premises.
- (2) In this paragraph, an irresponsible promotion means any one or more of the following activities, or substantially similar activities, carried on for the purpose of encouraging the sale or supply of alcohol for consumption on the premises in a manner which carries a significant risk of leading or contributing to crime and disorder, prejudice to public safety, public nuisance, or harm to children—
  - (a) games or other activities which require or encourage, or are designed to require or encourage, individuals to;
    - (i) drink a quantity of alcohol within a time limit (other than to drink alcohol sold or supplied on the premises before the cessation of the period in which the responsible person is authorised to sell or supply alcohol), or
    - (ii) drink as much alcohol as possible (whether within a time limit or otherwise);
  - (b) provision of unlimited or unspecified quantities of alcohol free or for a fixed or discounted fee to the public or to a group defined by a particular characteristic (other than any promotion or discount available to an individual in respect of alcohol for consumption at a table meal, as defined in section 159 of the Act);
  - (c) provision of free or discounted alcohol or any other thing as a prize to encourage or reward the purchase and consumption of alcohol over a period of 24 hours or less;
  - (d) provision of free or discounted alcohol in relation to the viewing on the premises of a sporting event, where that provision is dependent on;
    - (i) the outcome of a race, competition or other event or process, or
    - (ii) the likelihood of anything occurring or not occurring;
  - (e) selling or supplying alcohol in association with promotional posters or flyers on, or in the vicinity of, the premises which can reasonably be considered to condone, encourage or glamorise anti-social behaviour or to refer to the effects of drunkenness in any favourable manner.

2. The responsible person shall ensure that no alcohol is dispensed directly by one person into the mouth of another (other than where that other person is unable to drink without assistance by reason of a disability).
3. The responsible person shall ensure that free tap water is provided on request to customers where it is reasonably available.

**Effective from 10<sup>th</sup> October 2010:**

4.
  - (1) The premises licence holder or club premises certificate holder shall ensure that an age verification policy applies to the premises in relation to the sale or supply of alcohol.
  - (2) The policy must require individuals who appear to the responsible person to be under 18 years of age (or such older age as may be specified in the policy) to produce on request, before being served alcohol, identification bearing their photograph, date of birth and a holographic mark.
5. The responsible person shall ensure that;
  - (a) where any of the following alcoholic drinks is sold or supplied for consumption on the premises (other than alcoholic drinks sold or supplied having been made up in advance ready for sale or supply in a securely closed container) it is available to customers in the following measures—
    - (i) beer or cider: ½ pint;
    - (ii) gin, rum, vodka or whisky: 25 ml or 35 ml; and
    - (iii) still wine in a glass: 125 ml; and
  - (b) customers are made aware of the availability of these measures.

No supply of alcohol may be made under the premises licence-

- a) at a time where there is no designated premises supervisor in respect of the premises licence, or
- b) at a time when the designated premises supervisor does not hold a personal licence or his personal licence is suspended

Every supply of alcohol under the premises licence must be made or authorised by a person who holds a personal licence.

## **Door supervisors**

Where a premises licence includes a condition that at specified times one or more individuals must be at the premises to carry out a security activity, such individuals must be licensed with the Security Industry Authority. This does not apply to premises within paragraph 8(3)(a) of Schedule 2 to the Private Security Industry Act 2001, (premises with premises licences authorising plays or films), or in respect of premises in relation to-

- any occasion mentioned in paragraph 8(3)(b) or (c) of Schedule 2 (premises being used exclusively by club with club premises certificate, under a temporary event notice authorising plays or films or under a gaming licence), or
- any occasion within paragraph 8(3)(d) of Schedule 2 (occasions prescribed by regulations under that Act) unless the Licence specifically states otherwise.

Security activity means an activity to which paragraph 2(1)(a) of Schedule 2 of the Private Security Industry Act 2001 of that schedule applies, and Paragraph 8(5) of Schedule 2 (interpreting of references to an occasion) applies as it applies in relation to paragraph 8 of Schedule 2 of the Private Security Industry Act 2001

## **Films**

Where the exhibition of films is authorised, the admission of children to the exhibition of any film must be to be restricted as follows:

If the London Borough of Tower Hamlets Licensing Section has issued a particular notification of restriction to the licence holder, that restriction Otherwise the recommendation of the film classification body.

Children means persons aged under 18 and

“film classification body” means the person or persons designated as the authority under section 4 of the Video Recordings Act 1984 (currently the British Board of Film Classification)

## **Annex 2 - Conditions consistent with the operating Schedule**

1. No nudity or semi nudity permitted.
2. Signs are to be prominently displayed inside and outside the premises warning customers that drug use on the premises will not be tolerated, there will be random searching on entry and the police may be called if drugs are found.
3. To support the written search policy at the premises, a secure drugs box is to be installed at the premises. Any confiscated items that are, or are

believed to be drugs, are to be placed into this box. Any such seizures are to be entered into a drug seizures log, which is to be kept in a safe place. This log will record the following details

- a) Time/ date and location of the seizure.
  - b) Member of staff seizing the item.
  - c) Name or description of the customer from whom the item was seized.
4. The management of the premises will contact the Police at least once every calendar month, for an officer to attend the premises, empty the drugs box, and sign the drugs log accordingly.
  5. Any customer or member of staff found using or supplying illegal drugs (of whatever quantity) on the premises is to be permanently excluded from the premises. Any customer or member of staff found possessing or supplying illegal drugs (of whatever quantity) on the premises is to be permanently excluded from the premises if the management of the Premises acting reasonably considers this prudent, and if the management of the Premises has any doubts about this they should consult the Police. A record of such exclusions is to be entered into the incident book. All reasonable steps must be taken to ensure all staff (including door staff) are aware of the identity of excluded persons.
  6. No person shall be allowed to leave the premises whilst in the possession of any open glass vessel, whether empty or containing any beverage. Bottle bins shall be provided at the exit doors and staff shall prevent glass bottles and glass glasses being taken from the premises
  7. An Incident Register shall be kept at the premises. This register will be maintained and kept for a minimum of 12 months. This register should record the following;
    - a) Name of the person responsible for the premises on each given day.
    - b) All incidents in relation to the use of force by staff or Door Supervisors in the removal of persons from the premises. It shall record the time and date of the occurrence, name or brief description of the person removed, and details of the staff involved.
    - c) Door Supervisors shall enter their full details at the commencement of work (full name, home address and contact telephone number, SIA registration number and the time they commenced and concluded working). If the Door Supervisor was supplied by an agency, details of that agency will also be recorded including the name of the agency, the registered business address and a contact telephone number.
  8. The premises will have door supervisors of both sexes on duty at all times when the management reasonably believe this to be necessary taking into account specifically the day of the week and the number of customers

expected to attend the premises on any particular day. All Door Supervisors working outside the premises or whilst engaged in the dispersal of patrons at the close of business shall wear 'High Visibility Clothing'.

9. All management staff shall be trained in dealing with persons who are incapacitated through the use of drugs or the combined effect of drugs and alcohol.
10. An adequate and appropriate supply of first aid equipment and materials shall be available on the premises.
11. All members of staff at the premises shall seek "credible photographic proof of age evidence" from any person who appears to be under the age of 18 years and who is seeking to purchase or consume alcohol on the premises. Such credible evidence shall be in the form of a passport or photographic driving licence. The premises shall be permitted to occasionally run specific events where persons under the age of 18 are permitted on the premises - such events will be for persons under the age of 18 only and there shall be no alcohol sold at these events. The premises shall provide the police with two weeks notice in advance that such an event is taking place.
12. The Licence Holder shall implement a written dispersal policy, to move customers from the premises and the immediate vicinity in such a way as to cause minimum disturbance or nuisance to neighbours. The policy shall be approved in writing by the Tower Hamlets Licensing Police.
13. A CCTV system shall be installed or the existing system maintained covering the inside and outside areas of the premises. The system will incorporate a camera covering each of the entrance doors and be capable of providing an image that is regarded as 'identification standard.'
  - a) To obtain a clear head and shoulders image of every person entering the premises on the CCTV system, persons entering the premises should be asked to remove headwear which obscures the person's face, unless worn as part of religious observance.
  - b) CCTV is to comply with the Data Protection Act 1998 and is to be working and recording correctly when the premises are open to the public.
  - c) The CCTV system shall incorporate a recording facility and any recordings shall be retained and stored in a suitable and secure manner for a minimum of one calendar month. A system shall be in place to maintain the quality of the recorded image. The system will comply with other essential legislation, and all signs as required will be clearly displayed. The system will be maintained and fully operational

throughout the hours that the premises are open for any licensable activity.

- d) The positions of all CCTV cameras shall be agreed with the Police Crime Prevention officer for the area, and any subsequent changes must be discussed with the Police Crime Prevention Team beforehand.
  - e) A staff member from the premises that is conversant with the operation of the CCTV system will be on the premises at all times that the premises is open to the public. This staff member will be able to show police recent data or footage with the absolute minimum of delay when requested.
14. Where external promoters are to be used for running events in the premises then Police risk assessment forms (Form 696) are to be fully completed before the event and emailed to the relevant police units, so that artists, DJ's, MC's and promoters can be checked. The forms will be completed and returned to the required police addresses electronically at least 2 weeks prior to the event taking place. A post event form will also be completed (F696a) and returned to the required police addresses. The management should act on police advice in response to such risk assessment forms.
15. Direct telephone access to reputable local taxi company shall be available for use by patrons.
16. A Designated Premises Supervisor, Personal Licence Holder or Nominated person to be on the premises at all times.
17. Persons under the age of 18 shall not be permitted on the premises after 19.30hrs.

### **Annex 3 - Conditions attached after a hearing by the licensing authority**

18. No entry or re-entry to the premises after 00:30.

### **Annex 4 – Conditions attached after a hearing at Magistrates' Court, 17<sup>th</sup> May, 2013.**

- 19 a) There shall be one SIA accredited security guard on duty for every 45 customers in the premises.
- b) A comprehensive and stand-alone Drugs Policy for the premises must be produced, adopted and reviewed annually by the Designated Premises Supervisor.

c) A “Challenge 21” policy must be adapted at the premises, under which any person purchasing or attempting to purchase alcohol who appears to be under 21 will be asked for photographic ID as proof of their age.

d) An identity scanner must be installed at the premises.



## Annex 5 - Plans

The plans are those submitted to the licensing authority on the following date:

3rd August 2005

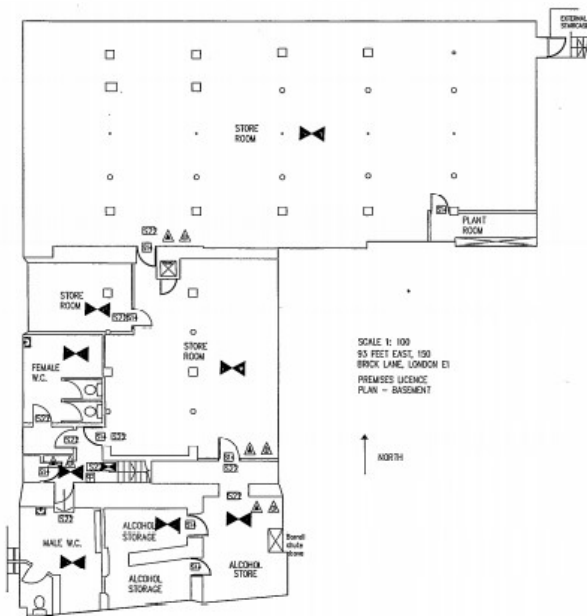
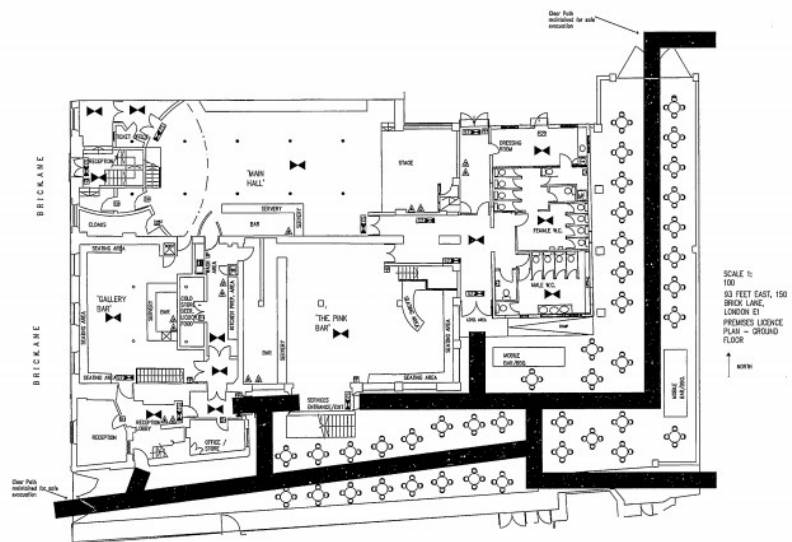
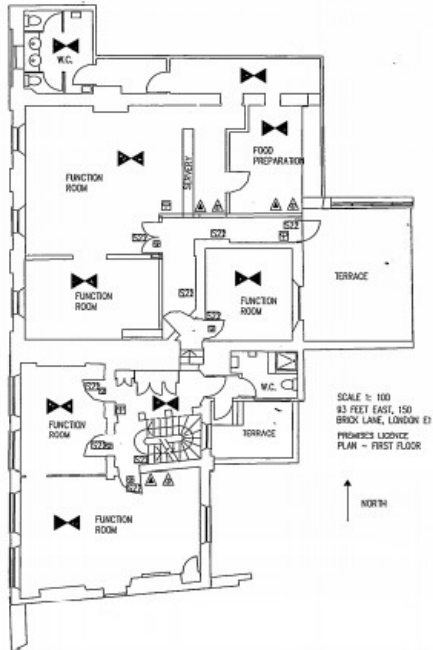



**Part B - Premises licence summary**

**Premises licence number**

16987

**Premises details**

**Postal address of premises, or if none, ordnance survey map reference or description**

150-152 Brick Lane

**Post town**  
London

**Post code**  
E1 6RU

**Telephone number**  
020 7247 3293

Where the licence is time limited the dates

N/A

Licensable activities authorised by the licence

The sale by retail of alcohol  
The provision of regulated entertainment  
The provision of late night refreshment

The times the licence authorises the carrying out of licensable activities

**The sale by retail of alcohol**  
Monday to Thursday 10:00 hrs to 23:00 hrs  
Friday & Saturday 10:00 hrs to 01:30 hrs  
Sunday 10:00 hrs to 22:30 hrs

**The provision of regulated entertainment**  
**Consisting of: Films; Indoor sporting events; Live music; Recorded music; Performances of dance; Anything similar to the aforementioned; Provision of facilities for making music; Provision of facilities for dancing; Provision of facilities for entertainment of a similar description to that of making music or dancing:-**

Monday to Thursday 10:00 hrs to 23:00 hrs  
Friday & Saturday 10:00 hrs to 01:30 hrs  
Sunday 10:00 hrs to 22:30 hrs

**The provision of late night refreshment**  
Friday & Saturday until 01:30 hrs

The opening hours of the premises

Monday to Thursday 09:00 hrs to 23:30 hrs  
Friday & Saturday 09:00 hrs to 02:00 hrs  
Sunday 09:00 hrs to 23:00 hrs

Name, (registered) address of holder of premises licence

93 Feet East Ltd  
150-152 Brick Lane  
London  
E1 6RU

Where the licence authorises supplies of alcohol whether these are on and / or off supplies

On and off sales

Registered number of holder, for example company number, charity number (where applicable)

Not applicable

Name of designated premises supervisor where the premises licence authorises for the supply of alcohol

Ivaylo Manev

State whether access to the premises by children is restricted or prohibited

Persons under the age of 18 shall not be permitted on the premises after 19:30 hrs.

# Appendix 4



**METROPOLITAN  
POLICE**

Working together for a safer London

TERRITORIAL POLICING

Tom Lewis  
Head of Licensing  
Tower Hamlets Council

**HT - Tower Hamlets Borough**

Licensing Office  
Stoke Newington Police Station  
33 Stoke Newington High Street

Email: [Barry.D.leban@met.police.uk](mailto:Barry.D.leban@met.police.uk)  
[www.met.police.uk](http://www.met.police.uk)

20<sup>th</sup> October 2021

Dear Sir,

Central East Police Licensing formally object to the application of a LATE TEN for 93 FEET EAST, 150, BRICK LNE E1 6QL on the ground of CRIME and DISORDER and PUBLIC NUISANCE. The venue is located in the ward of Spitalfields and Banglatown, during the months of August and September 2021 there were two hundred and twenty three (223) and two hundred and twenty nine (229) reported crimes.

In September 2021 I contacted the applicant as I had concerns regarding the amount of 'NOS CANNISTERS' littering the area directly outside the venue. There is no mention of a dispersal plan and little time for police to allocate resources. I believe that the event will have a negative impact on the two (2) licensed objectives above.

Kind regards,

Barry LEBAN PC1485CE



Central East Licensing Unit  
Metropolitan Police Service (MPS)  
Email s[Barry.D.Leban@met.police.uk](mailto:Barry.D.Leban@met.police.uk)  
Licensing Office, 1<sup>st</sup> Floor Stoke Newington Police Station

## Kathy Driver

---

**From:** Barry.D.Leban@met.police.uk  
**Sent:** 20 October 2021 14:17  
**To:** Licensin [REDACTED]  
**Cc:** [REDACTED]  
**Subject:** FW: 142672 BrickLane150\_31.10.21.pdf  
**Attachments:** 142672 BrickLane150\_31.10.21.pdf; 93 FEET EAST 31102021.docx

**Follow Up Flag:** Follow up  
**Flag Status:** Completed

Good afternoon,  
Please find attached my objection to the LATE TEN for the above venue.  
Kind regards,  
Barry

---

**From:** Tariq Shah [REDACTED]  
**Sent:** 19 October 2021 16:02  
**To:** [REDACTED] >  
**Cc:** [REDACTED] >  
**Subject:** 142672 BrickLane150\_31.10.21.pdf

Hi

Please see attached document for tens.

Kind regards

Tariq Shah  
Support Services Officer  
Licensing  
Communities, Localities and Culture Directorate  
E-mail: [REDACTED]  
Tel: [REDACTED]

NOTICE - This email and any attachments are solely for the intended recipient and may be confidential. If you have received this email in error, please notify the sender and delete it from your system. Do not use, copy or disclose the information contained in this email or in any attachment without the permission of the sender. Metropolitan Police Service (MPS) communication systems are monitored to the extent permitted by law and any email and/or attachments may be read by monitoring staff. Only specified personnel are authorised to conclude binding agreements on behalf of the MPS by email and no responsibility is accepted for unauthorised agreements reached with other personnel. While reasonable precautions have been taken to ensure no viruses are present in this email, its security and that of any attachments cannot be guaranteed.