

DRAFT

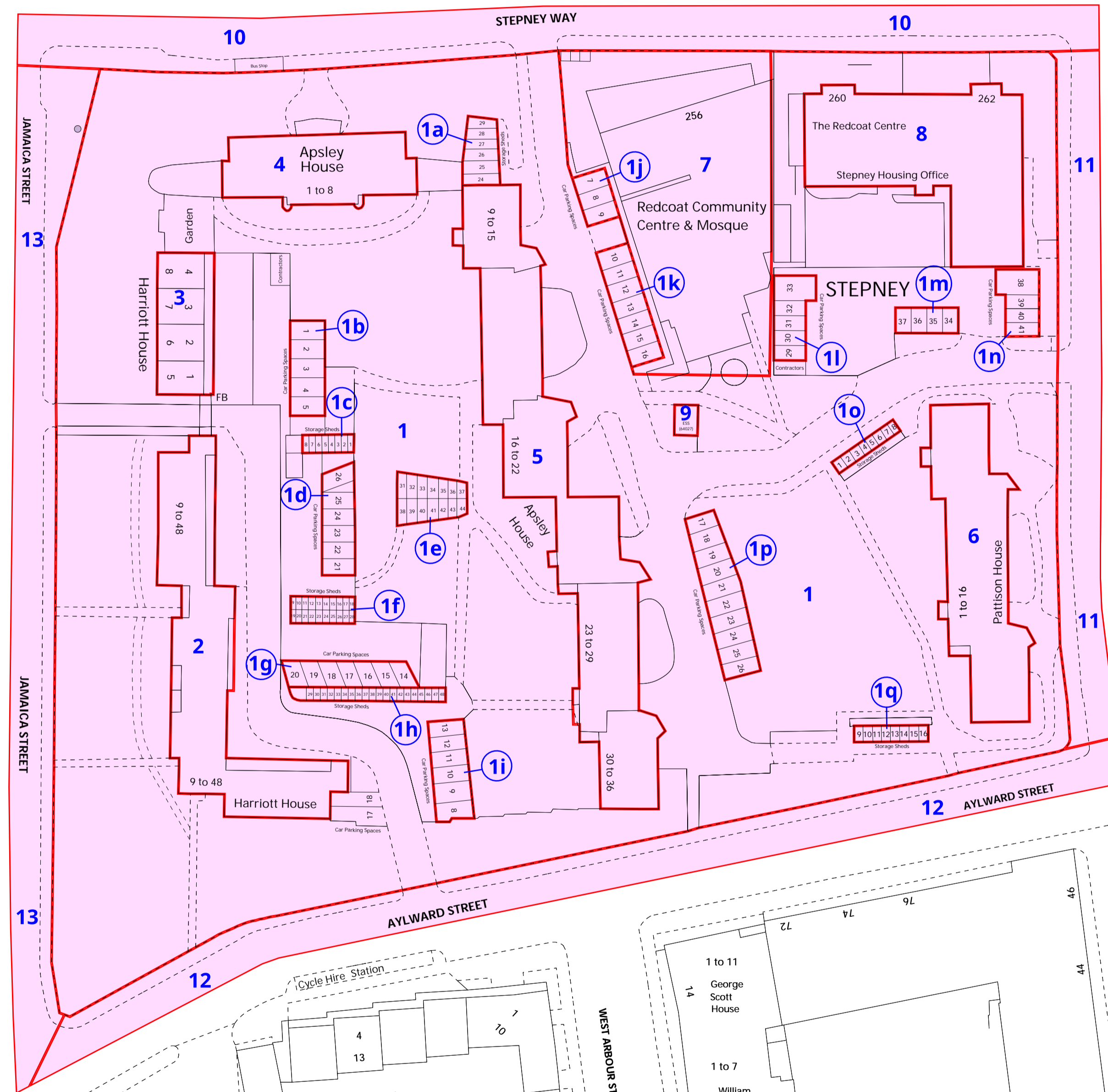
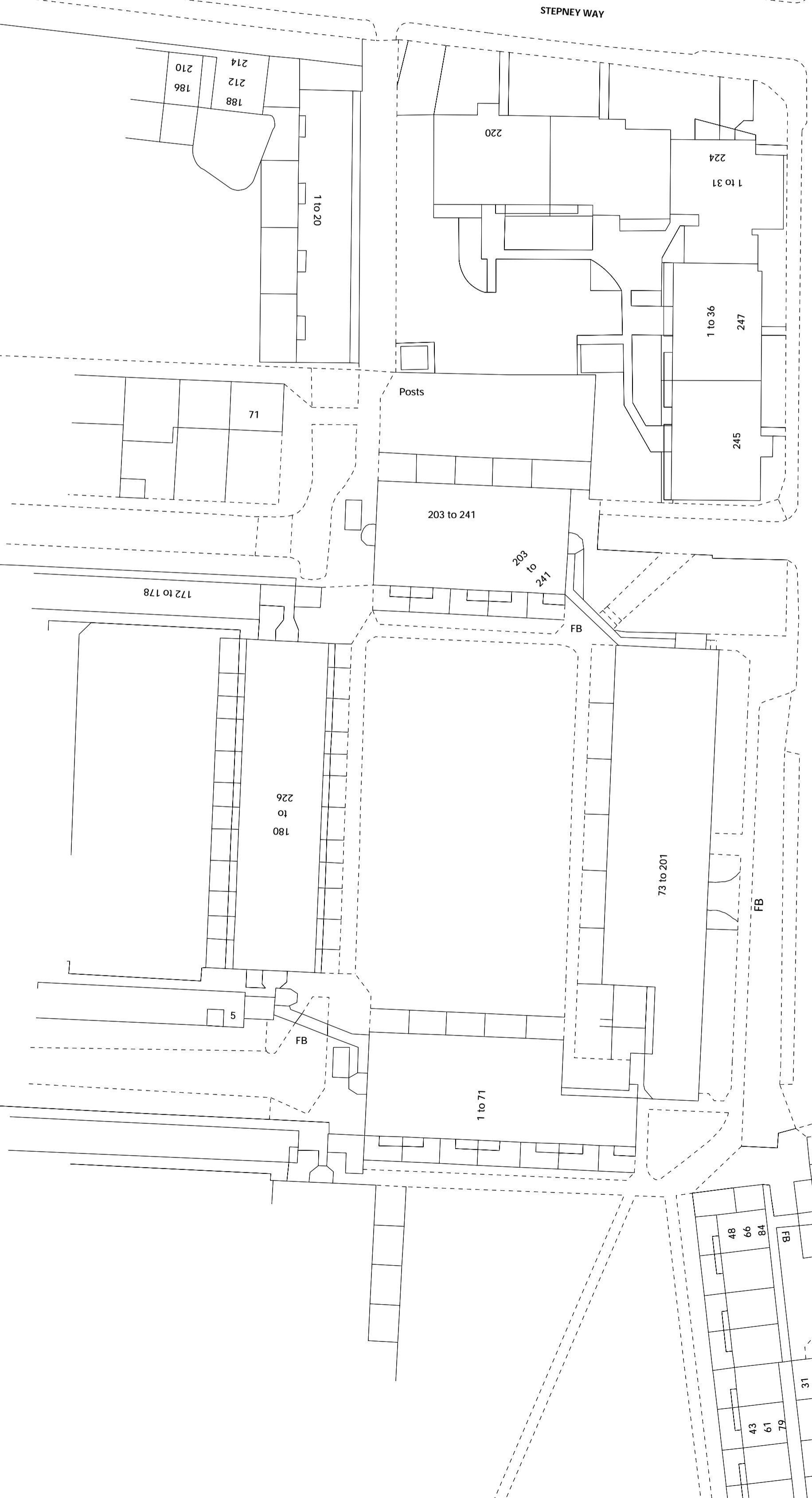
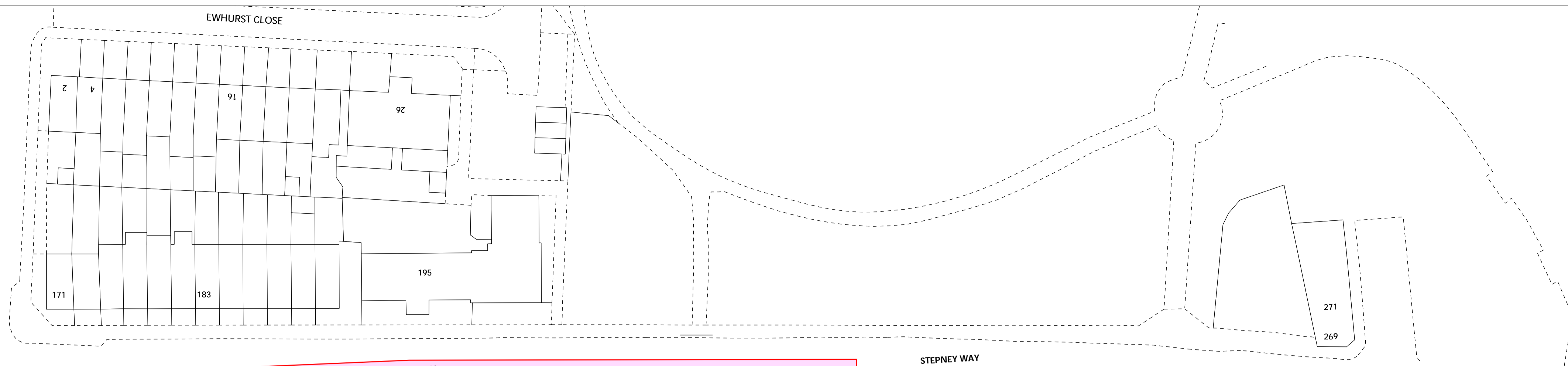
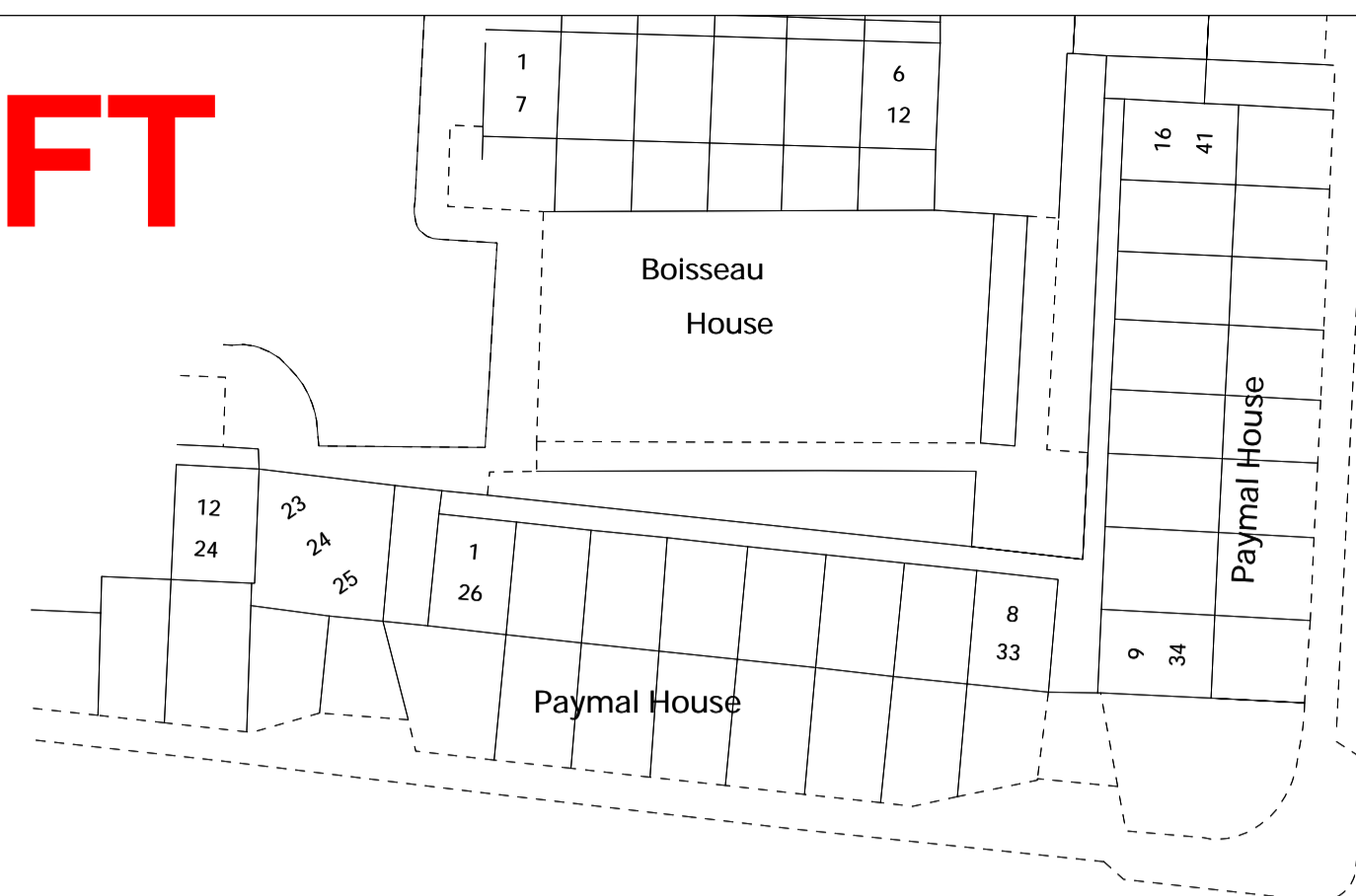

Key: Land to be Acquired

Sheet 1 of 1

1:500 When Printed A1

11/10/2023

3.0

LRS
LAND REFERENCING SERVICES

TOWER HAMLETS

Where applicable the plot boundaries show the general boundary of the registered land. It does not show the exact line of the boundaries. Measurements scaled from the plan may not match measurements taken on the same points on the ground.

This map is based upon Ordnance Survey material with the permission of Ordnance Survey on behalf of the Controller of Her Majesty's Stationery Office. Unauthorised reproduction of this map is prohibited. Crown copyright and database rights 2021 Ordnance Survey Licence number: 100031673

THE COMMON SEAL OF THE MAYOR AND BURGESSES OF THE LONDON BOROUGH OF TOWER HAMLETS WAS HERETOFORE AFFIXED IN THE PRESENCE OF:

(AUTHORISED SIGNATORY)

DATED THIS DAY OF 2024