

Appendix 1

**Application for a premises licence to be granted
under the Licensing Act 2003**

PLEASE READ THE FOLLOWING INSTRUCTIONS FIRST

Before completing this form please read the guidance notes at the end of the form. If you are completing this form by hand please write legibly in block capitals. In all cases ensure that your answers are inside the boxes and written in black ink. Use additional sheets if necessary.

You may wish to keep a copy of the completed form for your records.

I/We Travelodge Hotels Limited
(Insert name(s) of applicant)

apply for a premises licence under section 17 of the Licensing Act 2003 for the premises described in Part 1 below (the premises) and I/we are making this application to you as the relevant licensing authority in accordance with section 12 of the Licensing Act 2003

Part 1 – Premises Details

Postal address of premises or, if none, ordnance survey map reference or description			
Travelodge London City 20 Middlesex Street			
Post town	London	Postcode	E1 7EX

Telephone number at premises (if any)	
Non-domestic rateable value of premises	£ not yet rated

Part 2 - Applicant Details

Please state whether you are applying for a premises licence as

Please tick as appropriate

- a) an individual or individuals * please complete section (A)
- b) a person other than an individual *
 - i. as a limited company please complete section (B)
 - ii. as a partnership please complete section (B)
 - iii. as an unincorporated association or please complete section (B)
 - iv. other (for example a statutory corporation) please complete section (B)
- c) a recognised club please complete section (B)

TRADING STANDARDS

26 JAN 2018

LICENSING

- d) a charity please complete section (B)
- e) the proprietor of an educational establishment please complete section (B)
- f) a health service body please complete section (B)
- g) a person who is registered under Part 2 of the Care Standards Act 2000 (c14) in respect of an independent hospital in Wales please complete section (B)
- ga) a person who is registered under Chapter 2 of Part 1 of the Health and Social Care Act 2008 (within the meaning of that Part) in an independent hospital in England please complete section (B)
- h) the chief officer of police of a police force in England and Wales please complete section (B)

* If you are applying as a person described in (a) or (b) please confirm:

Please tick yes

I am carrying on or proposing to carry on a business which involves the use of the premises for licensable activities; or

I am making the application pursuant to a statutory function or
 a function discharged by virtue of Her Majesty's prerogative

(A) INDIVIDUAL APPLICANTS (fill in as applicable)

Mr <input type="checkbox"/>	Mrs <input type="checkbox"/>	Miss <input type="checkbox"/>	Ms <input type="checkbox"/>	Other Title (for example, Rev)	
Surname			First names		
I am 18 years old or over				<input type="checkbox"/>	Please tick yes
Current postal address if different from premises address					
Post town		Postcode			
Daytime contact telephone number					
E-mail address (optional)					

SECOND INDIVIDUAL APPLICANT (if applicable)

Mr <input type="checkbox"/>	Mrs <input type="checkbox"/>	Miss <input type="checkbox"/>	Ms <input type="checkbox"/>	Other Title (for example, Rev)	
Surname			First names		
I am 18 years old or over				<input type="checkbox"/>	Please tick yes
Current postal address if different from premises address					
Post town		Postcode			
Daytime contact telephone number					
E-mail address (optional)					

(B) OTHER APPLICANTS

Please provide name and registered address of applicant in full. Where appropriate please give any registered number. In the case of a partnership or other joint venture (other than a body corporate), please give the name and address of each party concerned.

Name Travelodge Hotels Limited
Address Sleepy Hollow Aylesbury Road Thame Oxon OX9 3AT
Registered number (where applicable) 00769170
Description of applicant (for example, partnership, company, unincorporated association etc.) Limited Company
Telephone number (if any)
E-mail address (optional)

Part 3 Operating Schedule

When do you want the premises licence to start? ASAP

DD	MM	YYYY

If you wish the licence to be valid only for a limited period, when do you want it to end?

DD	MM	YYYY

Please give a general description of the premises (please read guidance note 1)

The premises will operate as a Travelodge hotel with a café bar located on the ground floor.

The hotel will be open 24 hours a day. Between the hours of 23:00 and 10:00 the sale of alcohol will be restricted to hotel residents and bona fide guests of hotel residents.

If 5,000 or more people are expected to attend the premises at any one time, please state the number expected to attend.

N/A

What licensable activities do you intend to carry on from the premises?

(Please see sections 1 and 14 of the Licensing Act 2003 and Schedules 1 and 2 to the Licensing Act 2003)

Provision of regulated entertainment

Please tick any that apply

- a) plays (if ticking yes, fill in box A)
- b) films (if ticking yes, fill in box B)
- c) indoor sporting events (if ticking yes, fill in box C)
- d) boxing or wrestling entertainment (if ticking yes, fill in box D)
- e) live music (if ticking yes, fill in box E)
- f) recorded music (if ticking yes, fill in box F)
- g) performances of dance (if ticking yes, fill in box G)
- h) anything of a similar description to that falling within (e), (f) or (g) (if ticking yes, fill in box H)

Provision of late night refreshment (if ticking yes, fill in box I)

Supply of alcohol (if ticking yes, fill in box J)

In all cases complete boxes K, L and M

A

Plays Standard days and timings (please read guidance note 6)			<u>Will the performance of a play take place indoors or outdoors or both – please tick</u> (please read guidance note 2)		Indoors	<input type="checkbox"/>
					Outdoors	<input type="checkbox"/>
Day	Start	Finish			Both	<input type="checkbox"/>
Mon			<u>Please give further details here</u> (please read guidance note 3)			
Tue						
Wed			<u>State any seasonal variations for performing plays</u> (please read guidance note 4)			
Thur						
Fri			<u>Non standard timings. Where you intend to use the premises for the performance of plays at different times to those listed in the column on the left, please list</u> (please read guidance note 5)			
Sat						
Sun						

B

Films Standard days and timings (please read guidance note 6)			<u>Will the exhibition of films take place indoors or outdoors or both – please tick</u> (please read guidance note 2)		Indoors	<input type="checkbox"/>
					Outdoors	<input type="checkbox"/>
Day	Start	Finish			Both	<input type="checkbox"/>
Mon			<u>Please give further details here</u> (please read guidance note 3)			
Tue						
Wed			<u>State any seasonal variations for the exhibition of films</u> (please read guidance note 4)			
Thur						

			<p>Non standard timings. Where you intend to use the premises for the exhibition of films at different times to those listed in the column on the left, please list (please read guidance note 5)</p>
Fri			
Sat			
Sun			

C

<p>Indoor sporting events Standard days and timings (please read guidance note 6)</p>			<p>Please give further details (please read guidance note 3)</p>
Day	Start	Finish	<p>State any seasonal variations for indoor sporting events (please read guidance note 4)</p>
Mon			
Tue			
Wed			
			<p>Non standard timings. Where you intend to use the premises for indoor sporting events at different times to those listed in the column on the left, please list (please read guidance note 5)</p>
Thur			
Fri			
Sat			
Sun			

D

Boxing or wrestling entertainments Standard days and timings (please read guidance note 6)			Will the boxing or wrestling entertainment take place indoors or outdoors or both – please tick (please read guidance note 2)	Indoors	<input type="checkbox"/>
				Outdoors	<input type="checkbox"/>
				Both	<input type="checkbox"/>
Day	Start	Finish	Please give further details here (please read guidance note 3)		
Mon					
Tue					
Wed					
Thur					
Fri					
Sat					
Sun					
			State any seasonal variations for boxing or wrestling entertainment (please read guidance note 4)		
			Non standard timings. Where you intend to use the premises for boxing or wrestling entertainment at different times to those listed in the column on the left, please list (please read guidance note 5)		

E

Live music Standard days and timings (please read guidance note 6)			Will the performance of live music take place indoors or outdoors or both – please tick (please read guidance note 2)	Indoors	<input type="checkbox"/>			
				Outdoors	<input type="checkbox"/>			
				Both	<input type="checkbox"/>			
Day	Start	Finish	Please give further details here (please read guidance note 3)					
Mon								
Tue								
Wed								
						State any seasonal variations for the performance of live music (please read guidance note 4)		

Thur			<p>Non standard timings. Where you intend to use the premises for the performance of live music at different times to those listed in the column on the left, please list (please read guidance note 5)</p>
Fri			
Sat			
Sun			

F

Recorded music Standard days and timings (please read guidance note 6)			Will the playing of recorded music take place <u>indoors or outdoors or both – please tick</u> (please read guidance note 2)	Indoors	<input type="checkbox"/>
Day	Start	Finish		Outdoors	<input type="checkbox"/>
				Both	<input type="checkbox"/>
Mon			<p>Please give further details here (please read guidance note 3)</p>		
Tue					
Wed			<p>State any seasonal variations for the playing of recorded music (please read guidance note 4)</p>		
Thur					
Fri			<p>Non standard timings. Where you intend to use the premises for the playing of recorded music at different times to those listed in the column on the left, please list (please read guidance note 5)</p>		
Sat					
Sun					

G

Performances of dance Standard days and timings (please read guidance note 6)			Will the performance of dance take place indoors or outdoors or both – please tick (please read guidance note 2)		Indoors	<input type="checkbox"/>
					Outdoors	<input type="checkbox"/>
					Both	<input type="checkbox"/>
Day	Start	Finish				
Mon			Please give further details here (please read guidance note 3)			
Tue						
Wed			State any seasonal variations for the performance of dance (please read guidance note 4)			
Thur						
Fri			Non standard timings. Where you intend to use the premises for the performance of dance at different times to those listed in the column on the left, please list (please read guidance note 5)			
Sat						
Sun						

H

Anything of a similar description to that falling within (e), (f) or (g) Standard days and timings (please read guidance note 6)			Please give a description of the type of entertainment you will be providing			
Day	Start	Finish	Will this entertainment take place indoors or outdoors or both – please tick (please read guidance note 2)		Indoors	<input type="checkbox"/>
Mon					Outdoors	<input type="checkbox"/>
					Both	<input type="checkbox"/>
Tue			Please give further details here (please read guidance note 3)			
Wed						

Thur			<p><u>State any seasonal variations for entertainment of a similar description to that falling within (e), (f) or (g) (please read guidance note 4)</u></p> <p><u>Non standard timings. Where you intend to use the premises for the entertainment of a similar description to that falling within (e), (f) or (g) at different times to those listed in the column on the left, please list (please read guidance note 5)</u></p>
Fri			
Sat			
Sun			

I

Late night refreshment Standard days and timings (please read guidance note 6)			Will the provision of late night refreshment take place indoors or outdoors or both – please tick (please read guidance note 2)	Indoors	<input checked="" type="checkbox"/>
				Outdoors	<input type="checkbox"/>
				Both	<input type="checkbox"/>
Day	Start	Finish			
Mon	23:00	05:00	<u>Please give further details here</u> (please read guidance note 3) Provision of hot food and drinks		
Tue	23:00	05:00			
Wed	23:00	05:00	<u>State any seasonal variations for the provision of late night refreshment</u> (please read guidance note 4)		
Thur	23:00	05:00			
Fri	23:00	05:00	<u>Non standard timings. Where you intend to use the premises for the provision of late night refreshment at different times, to those listed in the column on the left, please list</u> (please read guidance note 5)		
Sat	23:00	05:00			
Sun	23:00	05:00			

J

Supply of alcohol Standard days and timings (please read guidance note 6)			Will the supply of alcohol be for consumption – please tick (please read guidance note 7)	On the premises	<input type="checkbox"/>			
				Off the premises	<input type="checkbox"/>			
				Both	<input checked="" type="checkbox"/>			
Day	Start	Finish	State any seasonal variations for the supply of alcohol (please read guidance note 4)					
Mon	00:00	24:00						
	24	hours						
Tue	00:00	24:00						
	24	hours						
Wed	00:00	24:00						
	24	hours						
Thur	00:00	24:00				Non standard timings. Where you intend to use the premises for the supply of alcohol at different times to those listed in the column on the left, please list (please read guidance note 5)		
	24	hours						
Fri	00:00	24:00						
	24	hours						
Sat	00:00	24:00						
	24	hours						
Sun	00:00	24:00						
	24	hours						

State the name and details of the individual whom you wish to specify on the licence as designated premises supervisor:

Name Niki Keith Edward Brightman	
Date of Birth	[REDACTED]
Address [REDACTED]	
Postcode	[REDACTED]
Personal licence number (if known) [REDACTED]	
Issuing licensing authority (if known) Aylesbury Vale District Council	

K

Please highlight any adult entertainment or services, activities, other entertainment or matters ancillary to the use of the premises that may give rise to concern in respect of children (please read guidance note 8).

N/A

L

Hours premises are open to the public Standard days and timings (please read guidance note 6)			State any seasonal variations (please read guidance note 4)
Day	Start	Finish	
Mon	00:00	24:00	<p><u>Non standard timings. Where you intend the premises to be open to the public at different times from those listed in the column on the left, please list</u> (please read guidance note 5)</p>
	24	hours	
Tue	00:00	24:00	
	24	hours	
Wed	00:00	24:00	
	24	hours	
Thur	00:00	24:00	
	24	hours	
Fri	00:00	24:00	
	24	hours	
Sat	00:00	24:00	
	24	hours	
Sun	00:00	24:00	
	24	hours	

M Describe the steps you intend to take to promote the four licensing objectives:

a) General – all four licensing objectives (b, c, d and e) (please read guidance note 9)

Please see b), d) and e) below.

b) The prevention of crime and disorder

1. A colour digital CCTV system will be installed and maintained to the satisfaction of the Police and licensing authority. Recordings from the installed CCTV are to be kept for 31 days. These recordings shall be immediately available for inspection and viewing on the premises by Police and/or licensing authority officers on request.
2. Hard copy recordings of CCTV footage in a playable format must be provided to Police and/or licensing authority officers within 48 hours of their request.
3. The premises must ensure the CCTV system is operating and recording 24 hours every day (save for the purpose of maintenance).
4. The licence holder will ensure all members of staff are trained in the requirements of the Licensing Act and other relevant legislation.
5. The premises licence holder will adopt a Challenge 21 scheme at the premises and display appropriate notices advising the scheme is in place at the hotel.
6. Between the hours of 23:00 to 10:00 hours the sale of alcohol will be restricted to hotel residents and bona fide guests of hotel residents.
7. After 23.00 access to the hotel is restricted to residents with a key card.

c) Public safety

Please see (b) above and (e) below.

d) The prevention of public nuisance

8. Notices shall be prominently displayed near all exits from the premises asking patrons to leave quietly with consideration for neighbours.
9. The emptying of bottles into outside bins will be restricted to the hours of 08:00 to 22:30 hours.

e) The protection of children from harm

10. Persons under 16 years of age will be accompanied by an adult in the area where licensable activities take place.

Checklist:

Please tick to indicate agreement

- I have made or enclosed payment of the fee.
- I have enclosed the plan of the premises.
- I have sent copies of this application and the plan to responsible authorities and others where applicable.
- I have enclosed the consent form completed by the individual I wish to be designated premises supervisor, if applicable.
- I understand that I must now advertise my application.
- I understand that if I do not comply with the above requirements my application will be rejected.
- [Applicable to all individual applicants, including those in a partnership which is not a limited liability partnership, but not companies or limited liability partnerships] I have included documents demonstrating my entitlement to work in the United Kingdom (please read note 15).

IT IS AN OFFENCE, UNDER SECTION 158 OF THE LICENSING ACT 2003, TO MAKE A FALSE STATEMENT IN OR IN CONNECTION WITH THIS APPLICATION. THOSE WHO MAKE A FALSE STATEMENT MAY BE LIABLE ON SUMMARY CONVICTION TO A FINE OF ANY AMOUNT.

IT IS AN OFFENCE UNDER SECTION 24B OF THE IMMIGRATION ACT 1971 FOR A PERSON TO WORK WHEN THEY KNOW, OR HAVE REASONABLE CAUSE TO BELIEVE, THAT THEY ARE DISQUALIFIED FROM DOING SO BY REASON OF THEIR IMMIGRATION STATUS. THOSE WHO EMPLOY AN ADULT WITHOUT LEAVE OR WHO

IS SUBJECT TO CONDITIONS AS TO EMPLOYMENT WILL BE LIABLE TO A CIVIL PENALTY UNDER SECTION 15 OF THE IMMIGRATION, ASYLUM AND NATIONALITY ACT 2006 AND PURSUANT TO SECTION 21 OF THE SAME ACT, WILL BE COMMITTING AN OFFENCE WHERE THEY DO SO IN THE KNOWLEDGE, OR WITH REASONABLE CAUSE TO BELIEVE, THAT THE EMPLOYEE IS DISQUALIFIED.



Part 4 – Signatures (please read guidance note 10)

Signature of applicant or applicant’s solicitor or other duly authorised agent (see guidance note 11).
If signing on behalf of the applicant, please state in what capacity.

Declaration	<ul style="list-style-type: none"> • [Applicable to individual applicants only, including those in a partnership which is not a limited liability partnership] I understand I am not entitled to be issued with a licence if I do not have the entitlement to live and work in the UK (or if I am subject to a condition preventing me from doing work relating to the carrying on of a licensable activity) and that my licence will become invalid if I cease to be entitled to live and work in the UK (please read guidance note 15) • The DPS named in this application form is entitled to work in the UK (and is not subject to conditions preventing him or her from doing work relating to a licensable activity) and I have seen a copy of his or her proof of entitlement to work, if appropriate (please see note 15)
Signature	
Date	25 January 2018
Capacity	Woods Whur 2014 Limited - Solicitors for the Applicant

For joint applications, signature of 2nd applicant or 2nd applicant’s solicitor or other authorised agent (please read guidance note 12). **If signing on behalf of the applicant, please state in what capacity.**

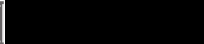
Signature	
Date	
Capacity	

Contact name (where not previously given) and postal address for correspondence associated with this application (please read guidance note 13)			
Carole Collingwood Woods Whur 2014 Limited Devonshire House 38 York Place			
Post town	Leeds	Postcode	LS1 2ED
Telephone number (if any)			
If you would prefer us to correspond with you by e-mail, your e-mail address (optional)			
			

Appendix 2

MIDDLESEX STRE-

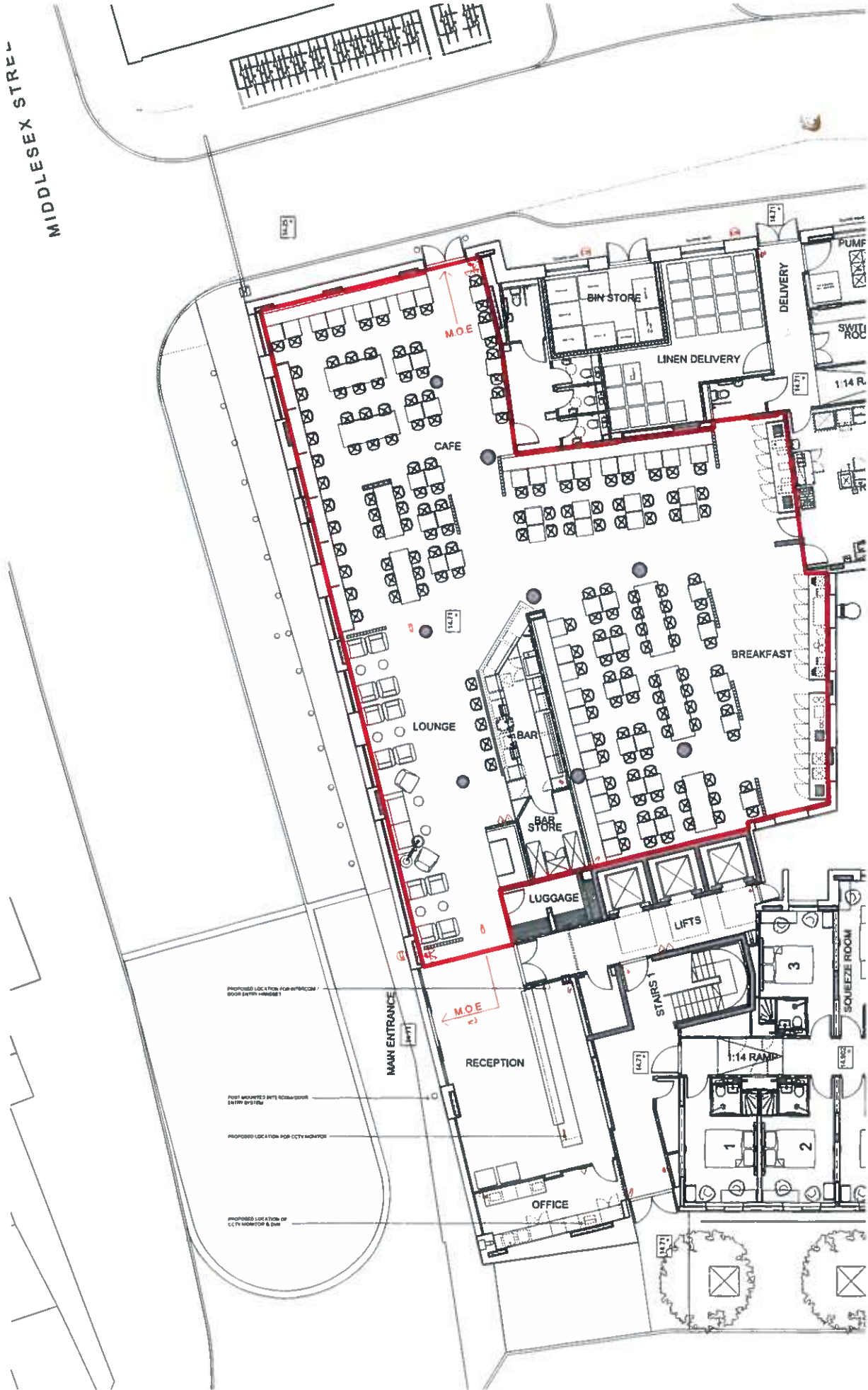

PROPOSED LOCATION FOR ENTRANCE / ROOM ENTRY VESTIBULE

POST MOUNTED INTO ROOM / DOOR ENTRY SYSTEM

PROPOSED LOCATION FOR CCTV MONITOR

PROPOSED LOCATION OF CCTV MONITOR & PIV

MAIN ENTRANCE

RECEPTION

OFFICE

STAIRS 1

1:14 RAM

LUGGAGE

BAR STORE

BAR

LOUNGE

BREAKFAST

LINEN DELIVERY

BIN STORE

DELIVERY

SWITC ROOM

1:14 R.

PUMF

SQUEEZE ROOM

Appendix 3

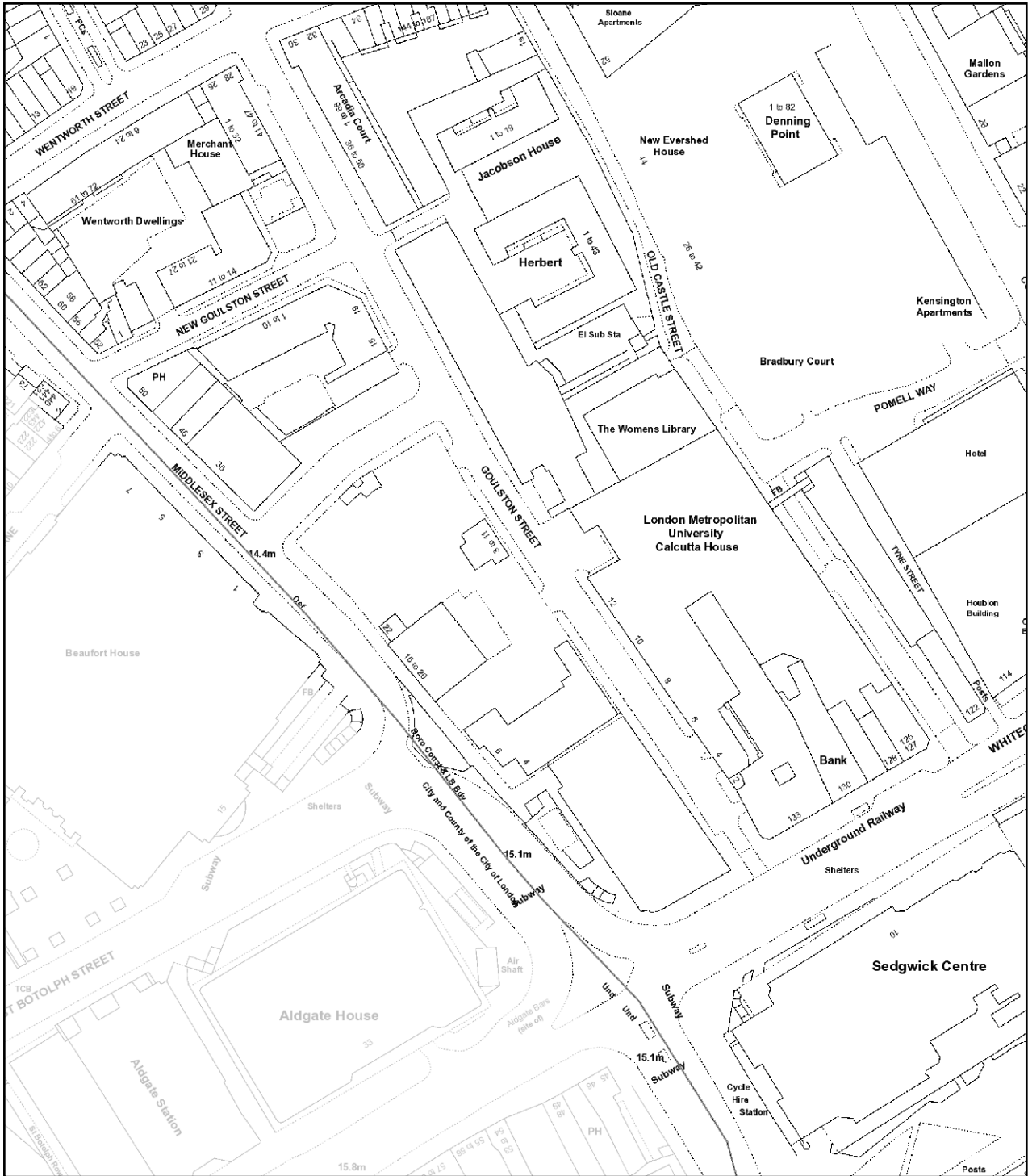

20 Middlesex Street



Scale 1:1537

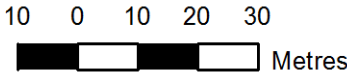

Appendix 4

20 Middlesex Street – Nearest licences

Name and address	Licensable activities and hours	Opening hours
<p>(Moo Grill) 40 - 42 Middlesex Street</p>	<p>The sale by retail of alcohol Monday to Sunday, from 09:00 hours to 23:00 hours</p> <p>The provision of regulated entertainment - Indoors <u>(Recorded music only)</u> Monday to Sunday, from 09:00 hours to 23:00 hours</p>	<p>Monday to Sunday, from 06:30 hours to 23:00 hours</p>
<p>(The Bell) 50 Middlesex Street London E1 7EX</p>	<p>The sale by retail of alcohol The provision of regulated entertainment consisting of: Recorded music, Live Music, Films The provision of late night refreshment: Monday to Saturday from 10:00 hours to midnight Sunday from 08:00 hours to midnight</p> <p>An additional hour on 15 occasions per annum. Such occasions to be agreed in advance with the Licensing Authority on seven days notice.</p> <p>New Years Eve throughout the night until start of permitted hours on New Years Day</p>	<p>Monday to Saturday from 10:00 hours to 01:00 hours Sunday from 08:00 hours to 01:00 hours</p> <p>An additional hour on 15 occasions per annum. Such occasions to be agreed in advance with the Licensing Authority on seven days notice.</p> <p>New Years Eve throughout the night until start of permitted hours on New Years Day</p>
<p>(Co-Operative) 74 – 80 Middlesex Street</p>	<p>The sale by retail of alcohol Monday to Sunday, from 07:00 hours to Midnight</p>	<p>Monday to Sunday, from 07:00 hours to Midnight</p>
<p>(HappyDays) 44 Goulston Street</p>	<p>The sale by retail of alcohol Monday to Sunday 11 00 hrs to 23 00 hrs</p>	<p>Monday to Sunday 11 00 hrs to 23 00 hrs</p>

Appendix 5

Section 182 Advice by the Home Office Updated on April 2017

Relevant, vexatious and frivolous representations

- 9.4 A representation is “relevant” if it relates to the likely effect of the grant of the licence on the promotion of at least one of the licensing objectives. For example, a representation from a local businessperson about the commercial damage caused by competition from new licensed premises would not be relevant. On the other hand, a representation by a businessperson that nuisance caused by new premises would deter customers from entering the local area, and the steps proposed by the applicant to prevent that nuisance were inadequate, would be relevant. In other words, representations should relate to the impact of licensable activities carried on from premises on the objectives. For representations in relation to variations to be relevant, they should be confined to the subject matter of the variation. There is no requirement for a responsible authority or other person to produce a recorded history of problems at premises to support their representations, and in fact this would not be possible for new premises.
- 9.5 It is for the licensing authority to determine whether a representation (other than a representation from responsible authority) is frivolous or vexatious on the basis of what might ordinarily be considered to be vexatious or frivolous. A representation may be considered to be vexatious if it appears to be intended to cause aggravation or annoyance, whether to a competitor or other person, without reasonable cause or justification. Vexatious circumstances may arise because of disputes between rival businesses and local knowledge will therefore be invaluable in considering such matters. Licensing authorities can consider the main effect of the representation, and whether any inconvenience or expense caused by it could reasonably be considered to be proportionate.
- 9.6 Frivolous representations would be essentially categorised by a lack of seriousness. Frivolous representations would concern issues which, at most, are minor and in relation to which no remedial steps would be warranted or proportionate.
- 9.7 Any person who is aggrieved by a rejection of their representations on either of these grounds may lodge a complaint through the local authority’s corporate complaints procedure. A person may also challenge the authority’s decision by way of judicial review.

- 9.8 Licensing authorities should not take decisions about whether representations are frivolous, vexatious or relevant to the licensing objectives on the basis of any political judgement. This may be difficult for councillors who receive complaints from residents within their own wards. If consideration is not to be delegated, contrary to the recommendation in this Guidance, an assessment should be prepared by officials for consideration by the sub- committee before any decision is taken that necessitates a hearing. Any councillor who considers that their own interests are such that they are unable to consider the matter independently should disqualify themselves.
- 9.9 It is recommended that, in borderline cases, the benefit of the doubt about any aspect of a representation should be given to the person making that representation. The subsequent hearing would then provide an opportunity for the person or body making the representation to amplify and clarify it.
- 9.10 Licensing authorities should consider providing advice on their websites about how any person can make representations to them.

Appendix 6

From: Jon Shapiro [REDACTED]
Sent: 22 February 2018 13:45
To: Licensing
Subject: Licensing Application by "Travelodge London City", 20 Middlesex Street, E1 7EX

Dear Sir or Madam,

I would like to request that aspects of this Licence Application should be reduced and/or removed on the grounds of:

- The prevention of crime and disorder
- Public safety
- The prevention of public nuisance.

I would like to see two restrictions placed on the requested licence application:

1. I believe that there are already far too many premises selling "off-sales" alcohol within Spitalfields & Banglatown, and request that "off-sales" should be refused.
(I fully accept that the premises are outside the Brick Lane "Cumulative Impact Zone" (CIZ) but I see no need for them to require "off-sales".)
2. I think the hours restricted to selling alcohol to "hotel residents and bona fide guests of hotel residents" should be increased to:
22.00 to 10.00
rather than allowing the requested 23.00 to 10.00.

Spitalfields & Banglatown absolutely does not need any additional "off-sales" outlets which inevitably could have an impact extending into the Brick Lane area CIZ.

The Brick Lane area has always been stated by our Borough Police Commanders to be the "number one policing problem in Tower Hamlets". Until and unless this area ceases to be such a policing problem I believe that additional "Off-Sales" licences should not be granted to any premises more premises within Spitalfields & Banglatown.

The Brick Lane area is plagued by ASB and hospital admissions to A&E, and I believe that the Licensing Committee should be assisting the Police and other authorities in reducing any and all encouragement to provide increase the consumption of alcohol by drinkers anywhere nearby.

For the reasons quoted above I request that the two restrictions above should be made to the Licence granted to "Travelodge London City".

Yours faithfully,
Jon Shapiro.

Resident at:

[REDACTED]
[REDACTED]
[REDACTED]
[REDACTED]
[REDACTED]

Appendix 7

Catrina Marshall

From: Dick Tyler [REDACTED]
Sent: 23 February 2018 15:14
To: Licensing
Subject: Objection to licensing application for "Travelodge London City", 20 Middlesex Street, E1 7EX

Follow Up Flag: Follow up
Flag Status: Completed

Dear Licensing Department,

I wish to object to the licensing application for "**Travelodge London City**", 20 Middlesex Street, E1 7EX on the grounds of the prevention of public nuisance, public safety and the prevention of crime and disorder.

I believe that applications within the Brick Lane CIZ should only be approved for the following hours:

- Sunday to Wednesday: Alcohol until midnight, food until midnight, close at 00:30
- Thursday to Saturday: Alcohol until 00:30, food until 01:00 and close at 01:30
- Licences for off sales should only be granted where the applicant can show a clear need for them and, if granted, that they should only extend until 22:00.

I also believe that licences should be refused or more restrictive hours imposed where there is a history of anti-social behaviour associated with the applicant.

The application is for both on and "**off-sales**" 24 hours a day, seven days a week. If the Licensing Committee grants a licence at all, it should conform to the above criteria.

Yours sincerely,

Dick Tyler
[REDACTED]

Dick Tyler
[REDACTED]
[REDACTED]
[REDACTED]
[REDACTED]
[REDACTED]

Appendix 8

Anti-Social Behaviour from Patrons Leaving the Premises

General Advice

Members need to bear in mind that once patrons have left a premises they are no longer under direct control. Members will need to be satisfied that there is a link between the way the premises is operating and the behaviour that is complained of. An example of this would be that irresponsible drinking is being encouraged. Before deciding that any particular licensing conditions are proportionate, Members will also need to be satisfied that other legislation is not a more effective route. For example, if the problem is drinking in the street it may be that the Council should designate the area as a place where alcohol cannot be consumed in public.

Members may also wish to consider whether the hours of opening relate to any problems of anti-social behaviour.

If Members believe that there is a substantial problem of anti-social behaviour and it cannot be proportionately addressed by licensing conditions they should refuse the application.

Licensing Policy

The policy recognises that other legislation or measures may be more appropriate but also states that licensing laws are “a key aspect of such control and will always be part of an overall approach to the management of the evening and night time economy” (**see Section 4.15 and 4.16 of the Licensing Policy**).

The Licensing Authority expects the applicant to have addressed all crime and disorder issues relating to the premises in their operating schedule and to have sought appropriate advice. (**See Sections 6.2 of the Licensing Policy**)

The Licensing Authority will consider attaching conditions to deter crime and disorder and these may include Conditions drawn from the Model Poll of Conditions relating to Crime and Disorder. (**See Appendix 3 of the Licensing Policy**). In particular Members may wish to consider (this list is not exhaustive):

- Bottle Bans
- Plastic containers
- CCTV (outside the premises)
- Restrictions on open containers for “off sales”
- Proof of Age scheme
- Crime prevention notices
- Drinks promotions-aimed at stopping irresponsible promotions
- Signage

Cumulative Impact

There is a process by which the Licensing Authority can determine that an area is saturated following representations. However, the process for this involves wide consultation and cannot come from representations about a particular application. (**See Section 8 of the Licensing Policy**).

Police Powers

The Licensing Act 2003, Part 8 gives a senior police officer the power to close a premises for up to 24 hours where the officer believes there is, or is likely to be disorder on or in the vicinity and closure is necessary in the interests of public.

Guidance Issued under Section 182 of the Licensing Act 2003

The key role of the Police is acknowledged (2.1).

Conditions attached to licences cannot seek to manage the behaviour of customers once they are beyond the direct management of the licence holder, but can relate to the immediate vicinity of the premises as they seek entry or leave (1.16).

Conditions are best targeted on deterrence and preventing crime and disorder (2.3) CCTV inside & out, communication, police liaison, no glasses are all relevant

There is also guidance issued around public nuisance (2.15 – 2.21).

The pool of conditions, adopted by the Council is recommended (see Appendix 3 of the Licensing Policy). Licence conditions should not duplicate other legislation (1.16).

Necessary and appropriate conditions should normally focus on the most sensitive periods and may address disturbance as customers enter or leave the premises but it is essential that conditions are focused on measures within the direct control of the licence holder (2.18/2.21).

Licensing law is not the primary mechanism for the general control of nuisance and anti-social behaviour by individuals once they are away from the licensed premises and, therefore, beyond the direct control of the individual, club or business holding the licence, certificate or authorisation concerned (14.13).

Other Legislation

Crime and Disorder Act 1998

The Council has a duty under Section 17 of the Crime and Disorder Act 1998 to do all it reasonably can to prevent crime and disorder.

The Act also introduced a wide range of measures designed to address anti-social behaviour committed by adults and young people. These include:

- Anti-Social Behaviour Orders
- Child Curfew Schemes
- Truancy
- Parenting Orders
- Reparation Orders
- Tackling Racism

Appendix 9

Licensing Policy

8 Special Cumulative Impact Policy for the Brick Lane Area

- 8.1 As with many other London Borough's the majority of late night licensed premises are concentrated within one area of the Borough. Following guidance issued under the Licensing Act 2003 a cumulative impact policy was adopted on 18th September 2013 by the Council.
- 8.2 After consultation the Council recognises that because of the number and density of licensed premises selling alcohol, on and off the premises and the provision of late night refreshment (sale of hot food after 11pm) within the Brick Lane Area as defined in Figure One, there might be exceptional problems of nuisance, disturbance and/or disorder outside or away from those licensed premises as a result of their combined effect.
- 8.3 The Licensing Authority is now of the view that the number, type and density of premises selling alcohol for consumption on and off the premises and/or the provision of late night refreshment in the area highlighted in Figure One is having a cumulative impact on the licensing objectives and has therefore declared a cumulative impact zone.
- 8.4 The effect of this Special Cumulative Impact Policy is to create a rebuttable presumption for applications in respect of the sale or supply of alcohol on or off the premises and/or late Night Refreshment for new Premises Licences, Club Premises Certificates or Provisional Statements and applications for variations of existing Premises Licences, Club Premises Certificates (where the modifications are relevant to the issue of cumulative impact for example increases in hours or capacity). Where the premises are situated in the cumulative impact zone and a representation is received, the licence will be refused. To rebut this presumption the applicant would be expected to show through the operating schedule and where appropriate with supporting evidence that the operation of the premises will not add to the cumulative impact already being experienced. This policy does not act as an absolute prohibition on granting/varying new licences in the Cumulative Impact Zone.
- 8.5 The Special Cumulative Impact policy will not be used to revoke an existing licence or certificate and will not be applicable during the review of existing licences.

Figure One

The Cumulative Impact Zone in the Brick Lane area

The Cumulative Impact Zone is detailed in the map below. The map shows all of the premises (dots) currently licensed under the Licensing Act 2003 in the Brick Lane Area. The Cumulative Impact Zone is defined by the dark line.

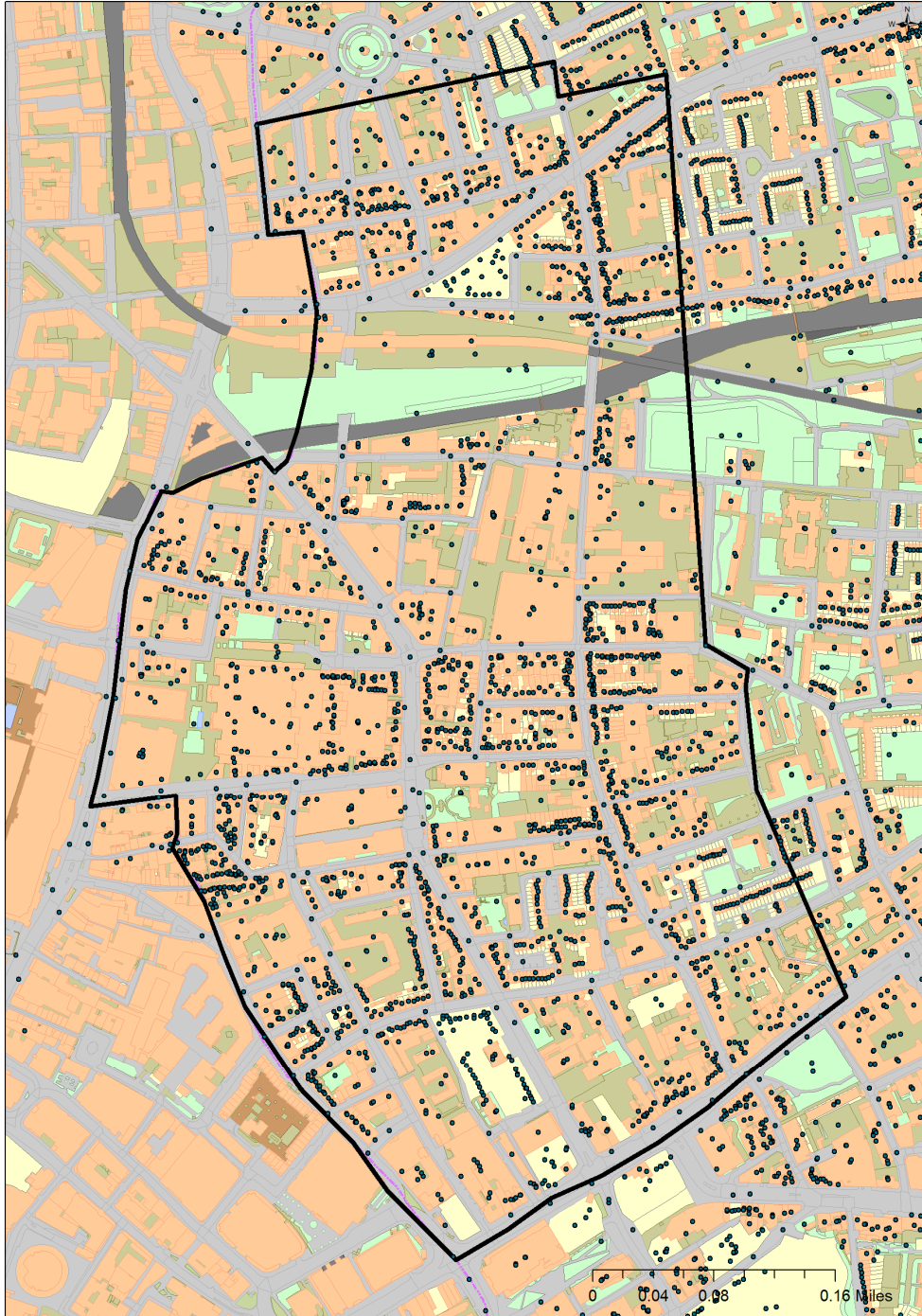

Cumulative Impact Zone

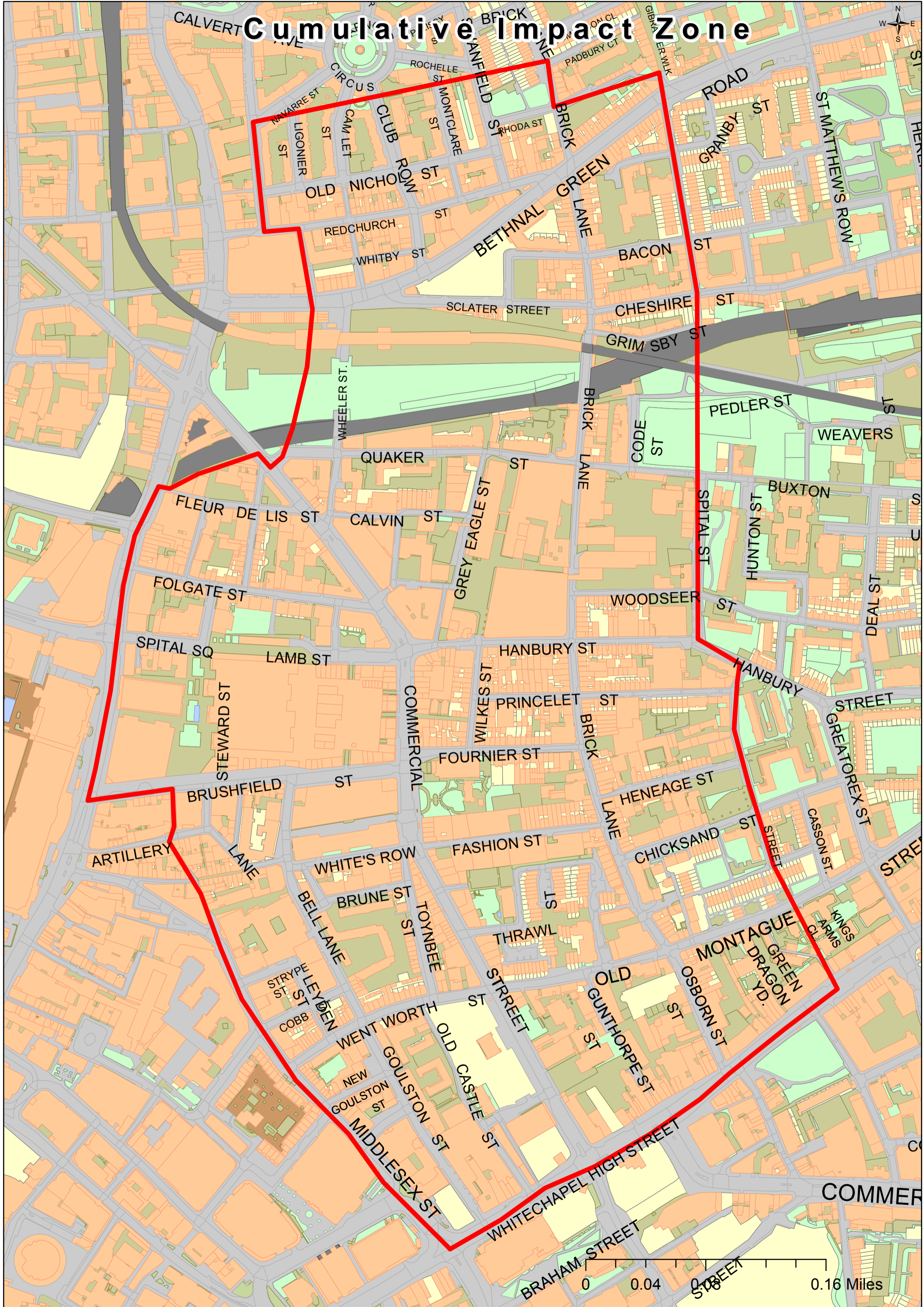

Appendix 10

Planning

An application for a Premises Licence can be made in respect of a premises even where the premises does not have relevant Planning Permission. That application has to be considered and Members can only refuse the application where the application itself does not promote one of more of the Licensing Objectives. Members cannot refuse just because there is no planning permission. Where a Premises Licence is granted and which exceeds what is allowed by the Planning Permission and that Premises then operates in breach of planning then the operator would be liable to enforcement by Planning.

Appendix 11

Licensing Policy Relating to Hours of Trading

All applications have to be considered on their own merits.

The Council has however adopted a set of framework hours as follows:

- Monday to Thursday, from 06:00 hrs to 23:30 hrs
- Friday and Saturday, from 06:00 hrs to 00:00 hrs (midnight)
- Sunday, from 06:00 hrs to 22:30 hrs

(see 15.8 of the Licensing Policy)

In considering the applicability of frame work hours to any particular application regard should be had to the following

- Location
- Proposed hours of regulated activities, and the proposed hours the premises are open to the public
- The adequacy of the applicant's proposals to deal with issues of crime and disorder and public nuisance
- Previous history
- Access to public transport
- Proximity to other licensed premises, and their hours

(See 15.9 of the licensing policy)

Subject to any representations to the contrary in individual cases the following premises are not generally considered to contribute to late night anti-social behaviour and will therefore generally have greater freedom

- Theatres
- Cinemas
- Premises with club premises certificates